



TECHNICAL BULLETIN

Issue Date : January 18, 2007

No. 03-281-07

UL Construction #538 MasterLok FS

UL580 Class 90

1. **Metal Roof Deck Panels*** - For Class 90 - No. 24 MSG coated steel, for Class 30 - No. 26 MSG min. Coated steel panels continuous over two or more spans. End laps to occur adjacent to (item 7) or on top of (item 7A) purlins with panels overlapped 3 in. max. Side laps to be tightened and crimped with a special motorized crimping machine. A line of sealant may be used at panel end and side laps.

McElroy Metal Mill, Inc. "MasterLok FS"
2. **Roof Deck Fasteners** – (Panel Clips) – Two piece floating clip with a No. 15 MSG coated steel base and a 22 MSG coated steel top. Clips spaced at 60 ¼ inches on center and over purlins.

McElroy Metal Mill, Inc. "Low floating", "High floating", or "Utility floating"
3. **Building Units*** – None
4. **Fasteners (screws)** – Fasteners for panel clip to purlin to be ¼ - 14 by 1- ¼ inch long, self drilling, self tapping, 3/8 inch hex-head, plated steel screw with separate 5/8 inch O.D. neoprene washer. Two (2) screws used per clip. If no thermal spacer (Item No. 5) is used, the screws may be 1 inch long and the same type as panel clip attachment. Six (6) fasteners are to be used in the flat section of the end lap panel with the first fastener located 3- ¼ inches from either rib and then spaced in a 3 ½ , 3 ½ , 3 ½ , 3 ½ inch pattern. An additional fastener is to be located at the second slanted segment of the rib on both sides of the end lap panel. Screws used to fasten optional skylight backing plate (item No. 8) to be the same type as those used at the panel end laps. These screws are located at the second slanted segment adjacent to rib with three screws spaced 1 ½ inch OC at the first slanted segment adjacent to rib with two screws spaced at 3 inches OC.
5. **Thermal Spacer** – (Optional) Polystyrene, 1 inch max thickness, 3 inches wide, cut to fit between panel clips.
6. **Insulation** – (optional) – Any compressible blanket insulation, 6 inches max. thickness when located between thermal spacer (Item No. 5) and purlin (Item No. 9) before compression.
7. **End-Lap Plate Assembly** – (Not shown) – Used at panel end laps; Consisting of a lower section, 5 5/8 inches wide, with a 1 inch vertical leg, formed to the general profile of the panel and having four 1 inch wide by ¾ inch long tabs for sliding over the panel end. Upper section (optional) to be 1-1/2 inches wide 24 inches long and also formed to the general profile of the panel with one end formed to fit over the side rib. Five 5/16 inch diameter guide. Both parts to have ribs formed for reinforcement. Both parts fabricated from No. 16 MSG coated steel.
8. **Light Transmitting Panel Backing Plate** – None
9. **Purlin** – No. 16 MSG min gauge steel (55,000 psi min yield strength)

Refer to General Information, Roof Deck Construction, (Roofing Materials and Systems Directory) for items not evaluated.

*Bearing the UL Classification Marking

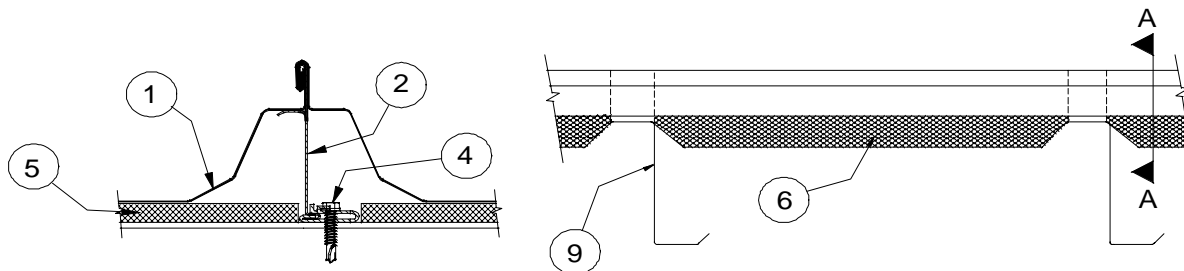

Section A-A

CORPORATE OFFICE
SHREVEPORT, LOUISIANA