



TECHNICAL BULLETIN

Issue Date : January 10, 2000

No. 03-108-00

UL Construction #161

R-Panel

UL580 Class 90 Wind Uplift

- Metal Roof Deck Panels*** - No. 26 MSG min gauge coated steel. Panels continuous over two or more spans. End laps to occur over purlins with panels overlapped a min of 4 in. with lap centered over purlin web. A line of sealant may be used at panel side and end laps.
- Panel Fasteners** – For panel to panel and panel to purlin connections to be No. 12-14 by 1 in. self drilling, self-tapping, hex head, plated steel screws with a 5/8 in. OD formed steel washer and a neoprene sealing washer. As alternate fasteners – for panel to purlin connections, ¼ -14 HHAB self-tapping plated steel screws, with a separate 5/8 in. OD dome shaped steel washer and a neoprene sealing washer may be used. Spacing, for panel to purlin connections to be 12 in. on center beginning 2-½ in. from centerline on one side of each major rib. Spacing at end lap to be in a 5/7/5/7-in. pattern beginning 2-½ in. from the centerline on both sides of each major rib. Fastener for panel to purlin connection to be 1 ¼ in. long when insulation (Item 3) is greater than 4 ½ in. Spacing for panel to panel connections to be 20 in. on center with a fastener located in line with the purlin fasteners.
- Insulation** – (Optional) – Any compressible blanket insulation 6 in. max. thickness before compression.
- Purlin** – No. 16 MSG min gauge steel (50,000 psi min yield).
- Lateral Bracing** – (Not shown) – As required.

McElroy Metal Mill, Inc. "R-Panel"

Refer to General Information, Roof Deck Construction, (Roofing Materials and Systems Directory) for items not evaluated.

*Bearing the UL Classification Marking

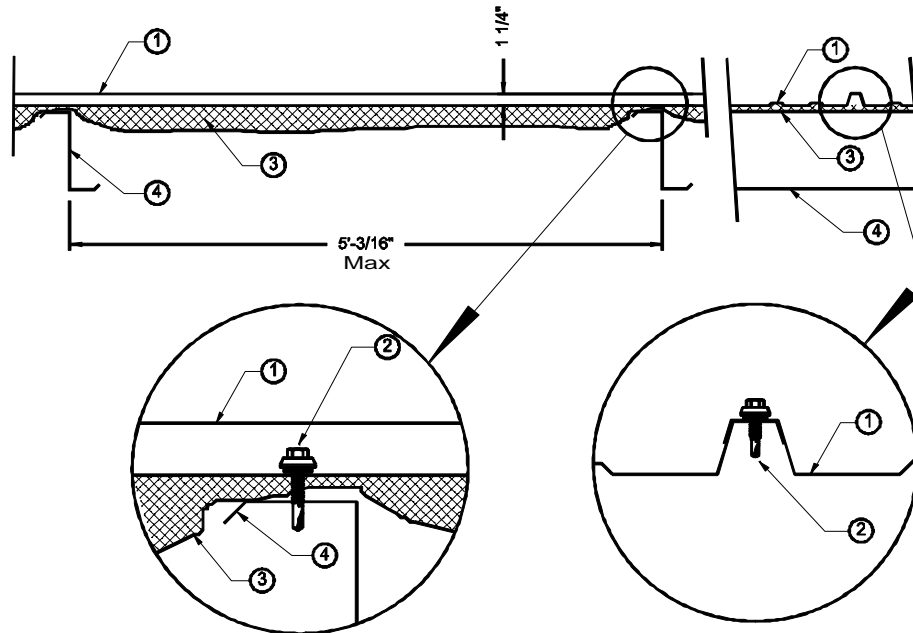

CORPORATE OFFICE
SHREVEPORT, LOUISIANA