

MULTI-V

INSTALLATION

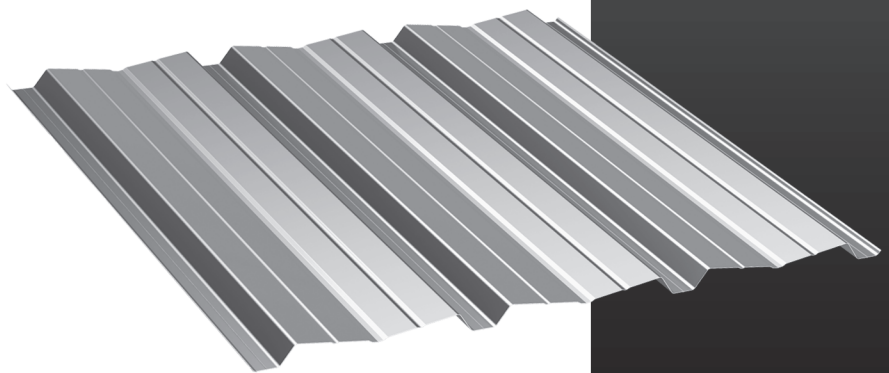

TABLE OF CONTENTS

PAGE NUMBER:	DETAIL DESCRIPTION
A-1.....	TABLE OF CONTENTS
A-2.....	GENERAL NOTES
B-1.....	FASTENER PATTERNS
C-1.....	SIMPLE BASE TRIM DETAIL
C-2.....	BASE TRIM DETAIL
C-3.....	PANEL TO GIRT DETAIL
C-4.....	OUTSIDE CORNER DETAIL
C-5.....	OUTSIDE CORNER (OFF MODULE) DETAIL
C-6.....	ALT. OUTSIDE CORNER DETAIL
C-7.....	ALT. OUTSIDE CORNER (OFF MODULE) DETAIL
C-8.....	INSIDE CORNER DETAIL
C-9.....	ALT. INSIDE CORNER DETAIL
C-10.....	ALT. INSIDE CORNER (OFF MODULE) DETAIL
C-11.....	PANEL ENDLAP DETAIL
C-12.....	HEAD TRIM DETAIL
C-13.....	MASONRY WAINSCOAT DETAIL
C-14.....	JAMB TRIM DETAIL
C-15.....	JAMB TRIM (OFF MODULE) DETAIL
C-16.....	SILL DETAIL
C-17.....	SIDEWALL DETAIL
C-18.....	SIDEWALL (OFF MODULE) DETAIL

GENERAL NOTES

The details shown on the following pages are suggestions or guidelines for installing the Multi-V wall panel system over wall girts. The installation details shown here are proven methods of construction, but they are not intended to cover all building requirements, designs or codes. The details may require changes or revisions due to individual project conditions.

Installation procedures shall be in accordance with the manufacturer's printed instructions, details or approved shop drawings. Installers should thoroughly familiarized themselves with all instructions prior to beginning the installation process.

The designer/installer is responsible to ensure the following:

That the details here meet the particular building requirements.

Awareness of and allowance for expansion/contraction of the wall panels.

That adequate water-tightness is maintained.

That a proper uniform substructure is used to avoid panel distortion and that the substructure meets necessary code requirements.

That all supporting members have been examined and are straight, level and plumb.

McElroy Metal can provide all flashings and accessories shown in the installation drawings unless noted otherwise. Panels, flashing and trim shall be installed true and in proper alignment with any exposed fasteners equally spaced for the best appearance. Sealant shall be field applied on a clean, dry surface.

Some field cutting and fitting of panels and flashings is to be expected and to be considered a part of normal installation work. Workmanship shall be of the best industry standards and with installation performed by experienced metal craftsmen.

Oil canning of metal panels is inherent in metal and is not a cause for rejection. Striated panels are recommended to reduce the appearance of oil canning.

Contents of this manual are subject to change without notice. To confirm this book is the most current copy, please visit McElroy Metal's website at www.mcelroymetal.com.

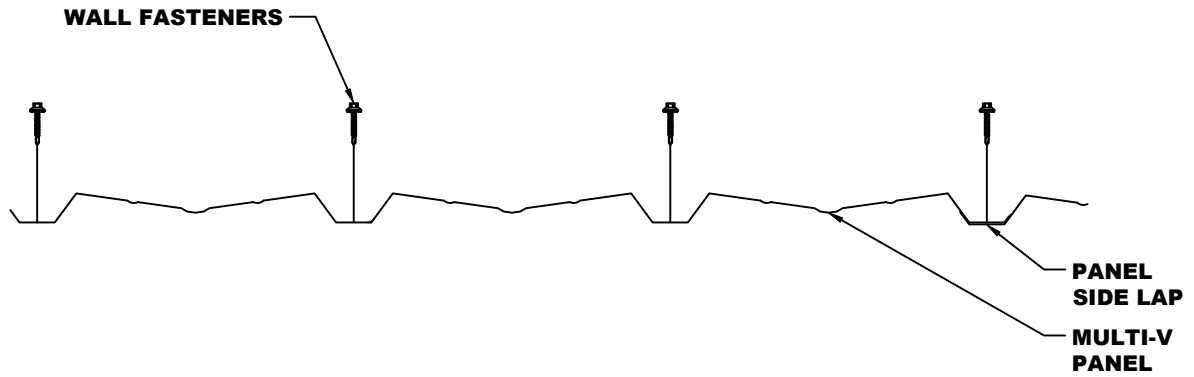

PANEL FRAMING FASTENER PATTERN

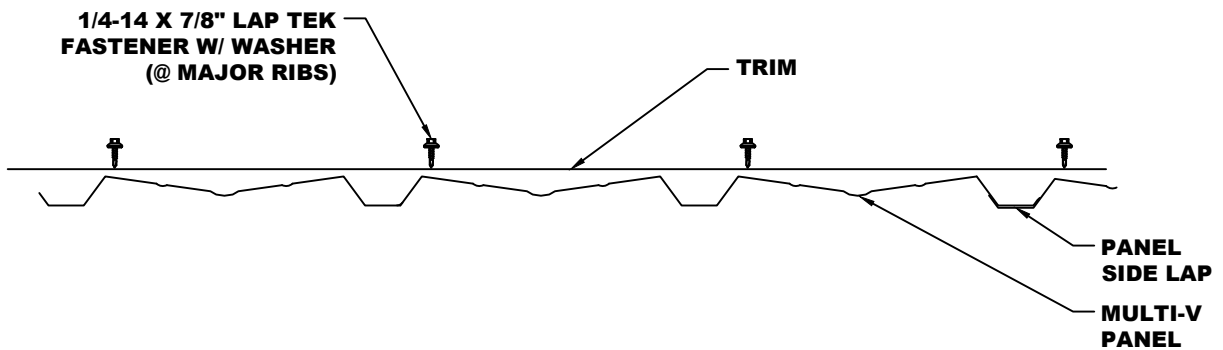

TRIM FASTENER PATTERN

SIMPLE BASE TRIM DETAIL

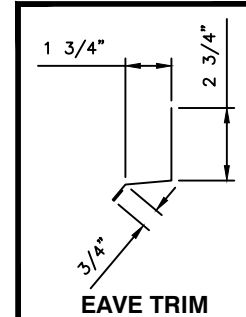
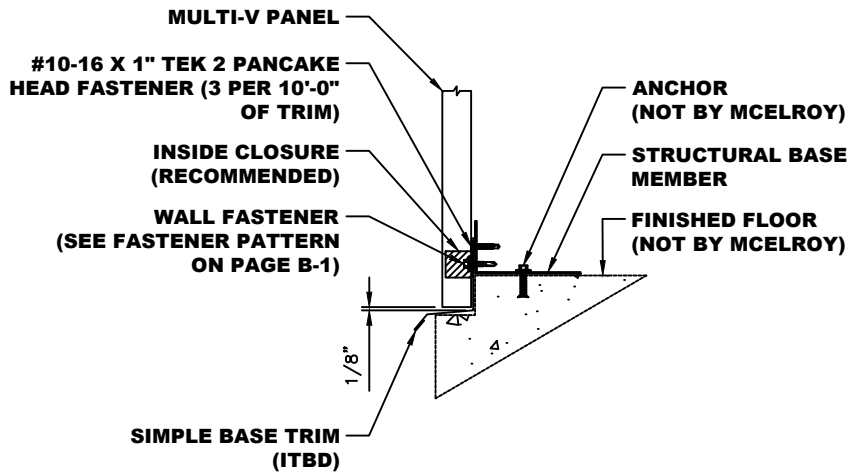

- NOTES:**
1. Structural Base Member set flush with edge of Finished Floor.
 2. Set Simple Base Trim 1 1/2" down face of finished floor.
 3. Set Closure in position on Simple Base Trim.
 4. Set Multi-V Wall Panel into place. Make sure to leave a 1/8" gap between trim and panel.
 5. Attach panel with Framing Fasteners per Fastening Pattern shown on page B-1.

*NOTE: SOME TRIM ITEMS AND FASTENERS HAVE BEEN REMOVED FOR CLARITY OF ISOMETRIC DETAIL.

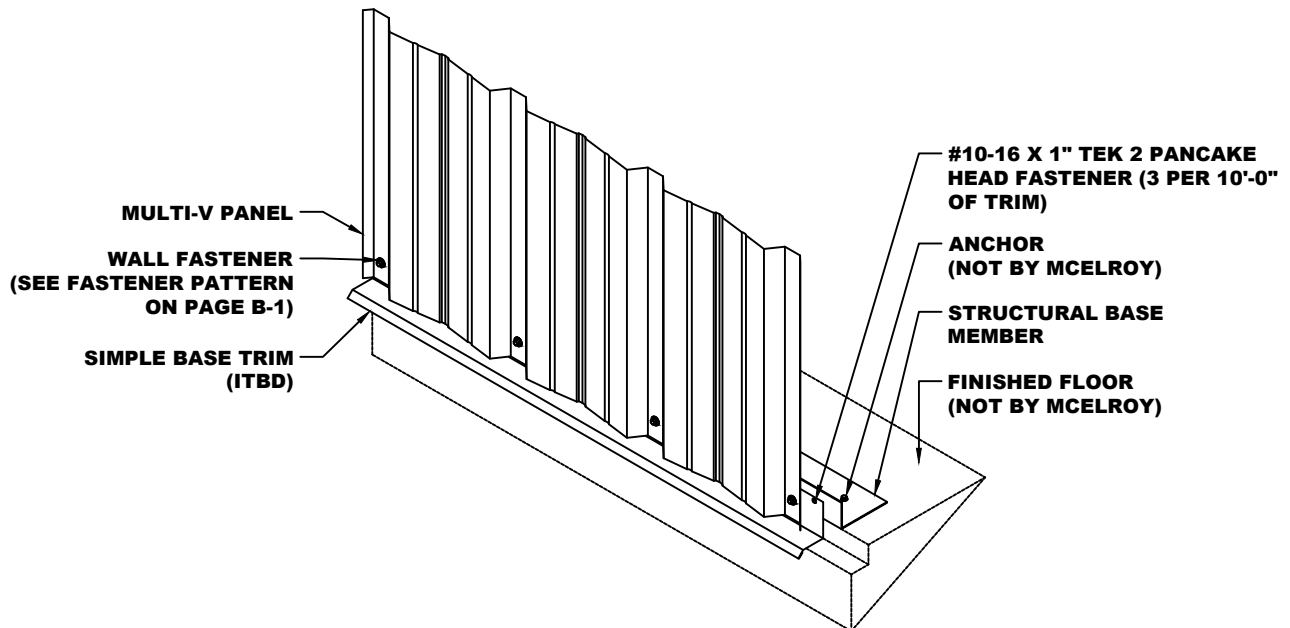

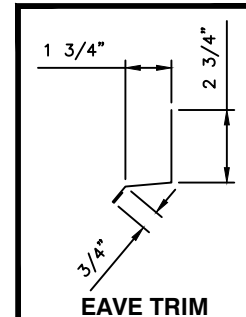
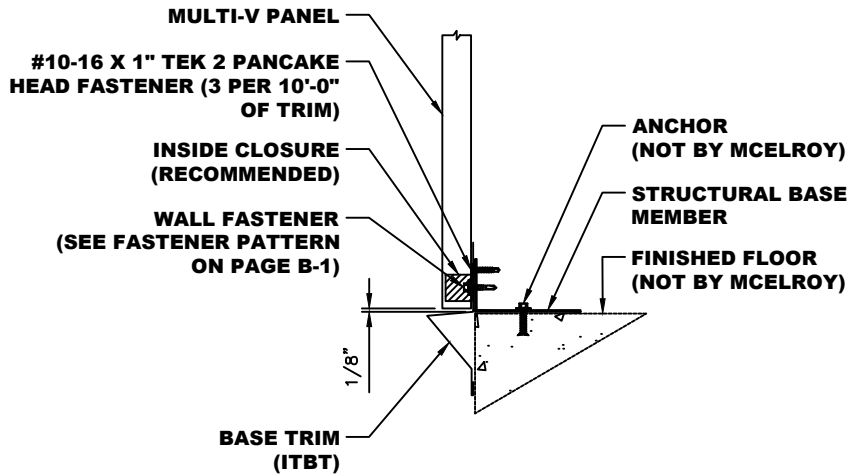

- NOTES:**
1. Structural Base Member set flush with edge of Finished Floor.
 2. Set Base Trim level with finished floor.
 3. Set Closure in position on Base Trim.
 4. Set Multi-V Wall Panel into place. Make sure to leave a 1/8" gap between trim and panel.
 5. Attach panel with Framing Fasteners per Fastening Pattern shown on page B-1.

*NOTE: SOME TRIM ITEMS AND FASTENERS HAVE BEEN REMOVED FOR CLARITY OF ISOMETRIC DETAIL.

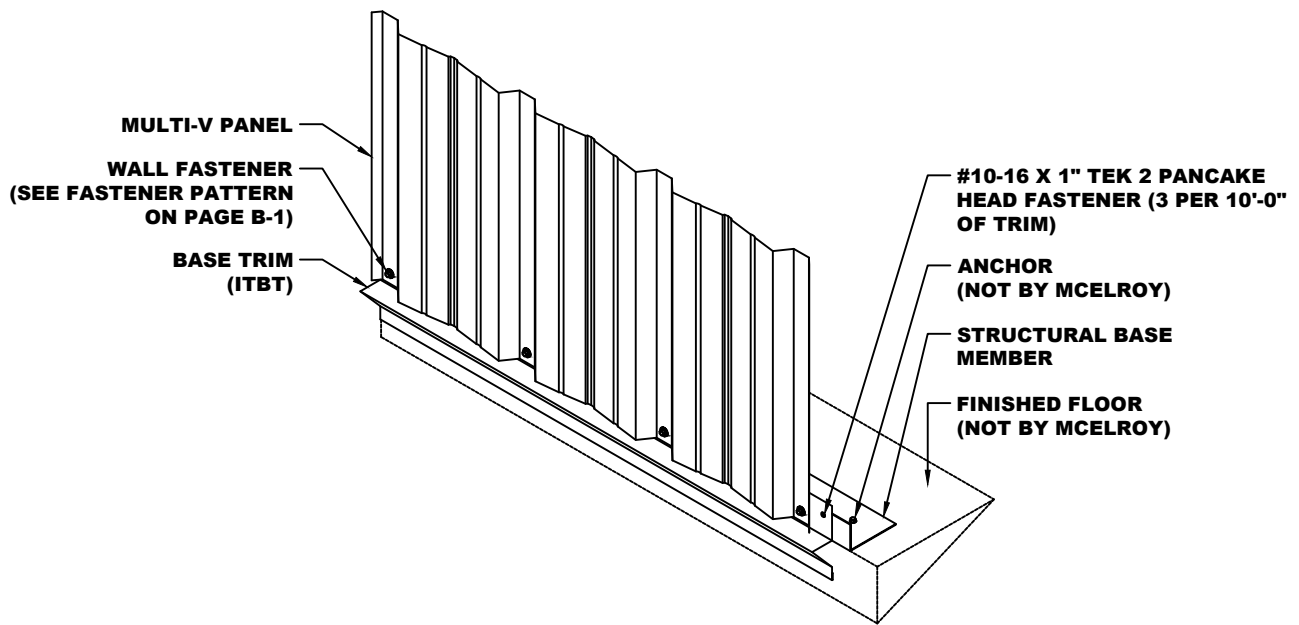

PANEL TO GIRT DETAIL

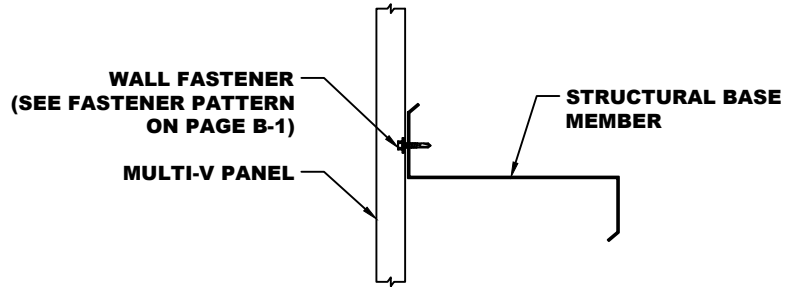

NOTES: 1. Attach Multi-V Panel to the Structural Wall Member with Wall Framing Fasteners. See Fastener Pattern on page B-1.

*NOTE: SOME TRIM ITEMS AND FASTENERS HAVE BEEN REMOVED FOR CLARITY OF ISOMETRIC DETAIL.

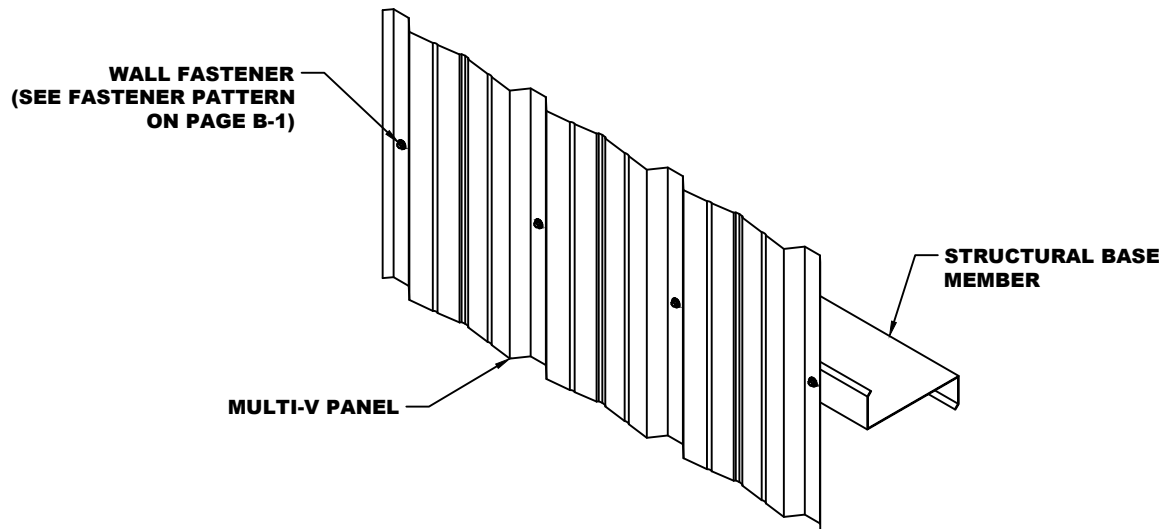

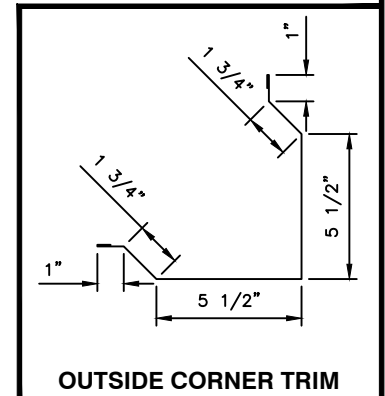
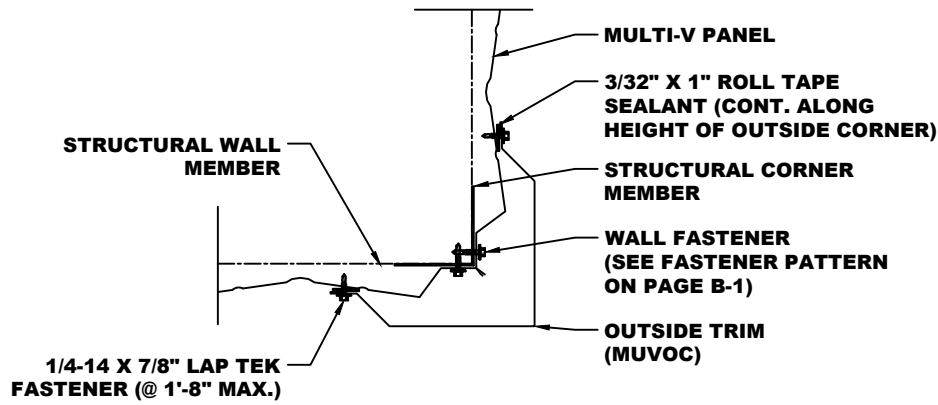

- NOTES:**
1. Attach Multi-V Panels to framework with Wall Fasteners. See Fastener Pattern on page B-1.
 2. Outside Corner Trim to run from Base Trim to top of wall panel.
 3. Before installing Outside Corner Trim, apply a continuous bead of 3/32" x 1" Roll Tape Sealant to the sides of the trim. Set in place and attach to wall panels with 1/4-14 x 7/8" Lap Tek Fasteners at 1'-8" O.C. (Max.).

*NOTE: SOME TRIM ITEMS AND FASTENERS HAVE BEEN REMOVED FOR CLARITY OF ISOMETRIC DETAIL.

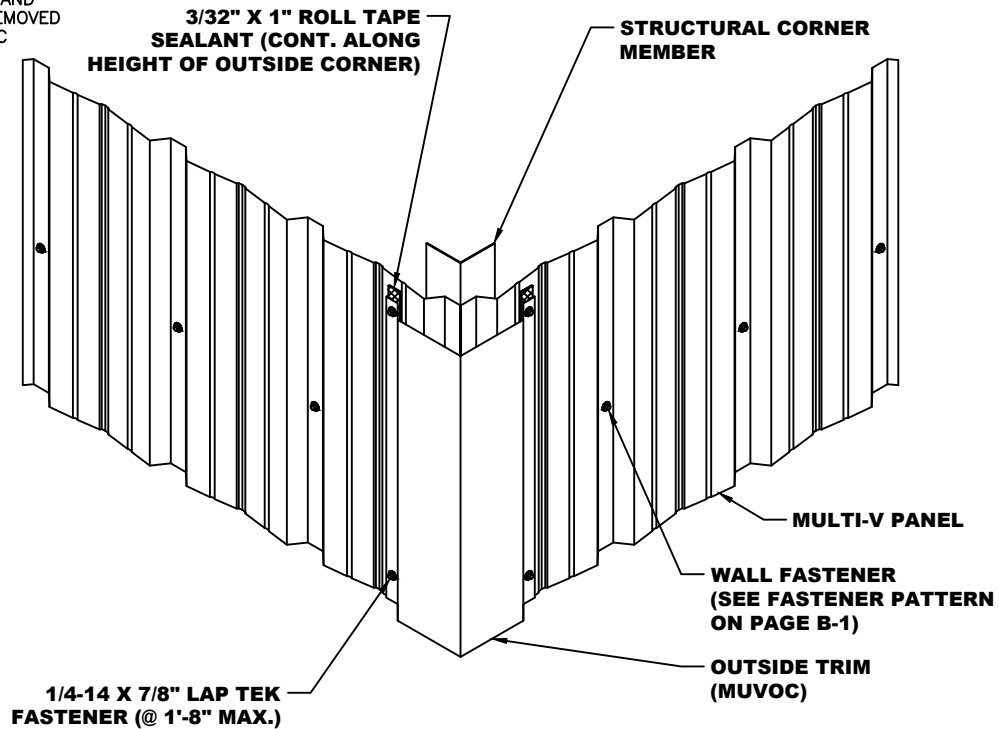

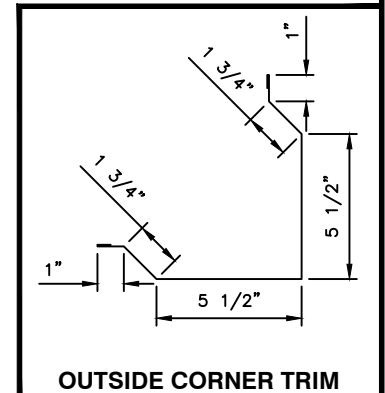
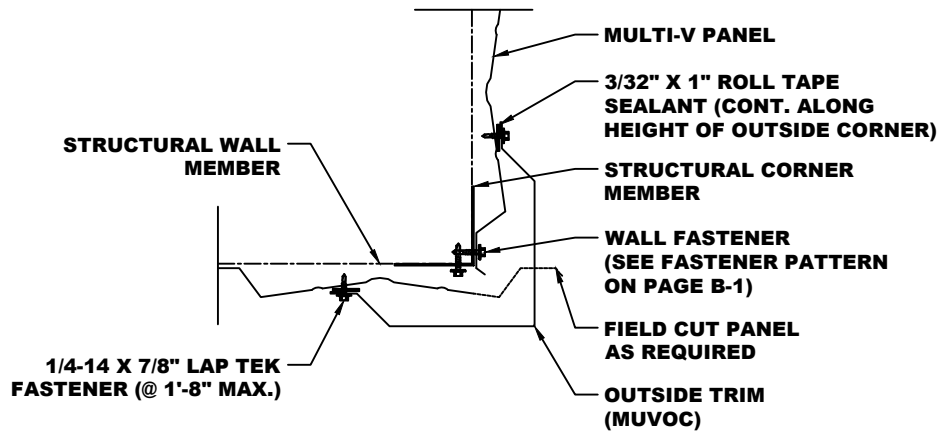

- NOTES:**
1. Attach Multi-V Panels to framework with Wall Fasteners. See Fastener Pattern on page B-1.
 2. Outside Corner Trim to run from Base Trim to top of wall panel.
 3. Before installing Outside Corner Trim, apply a continuous bead of 3/32" x 1" Roll Tape Sealant to the sides of the trim. Set in place and attach to wall panels with 1/4-14 x 7/8" Lap Tek Fasteners at 1'-8" O.C. (Max.).

*NOTE: SOME TRIM ITEMS AND FASTENERS HAVE BEEN REMOVED FOR CLARITY OF ISOMETRIC DETAIL.

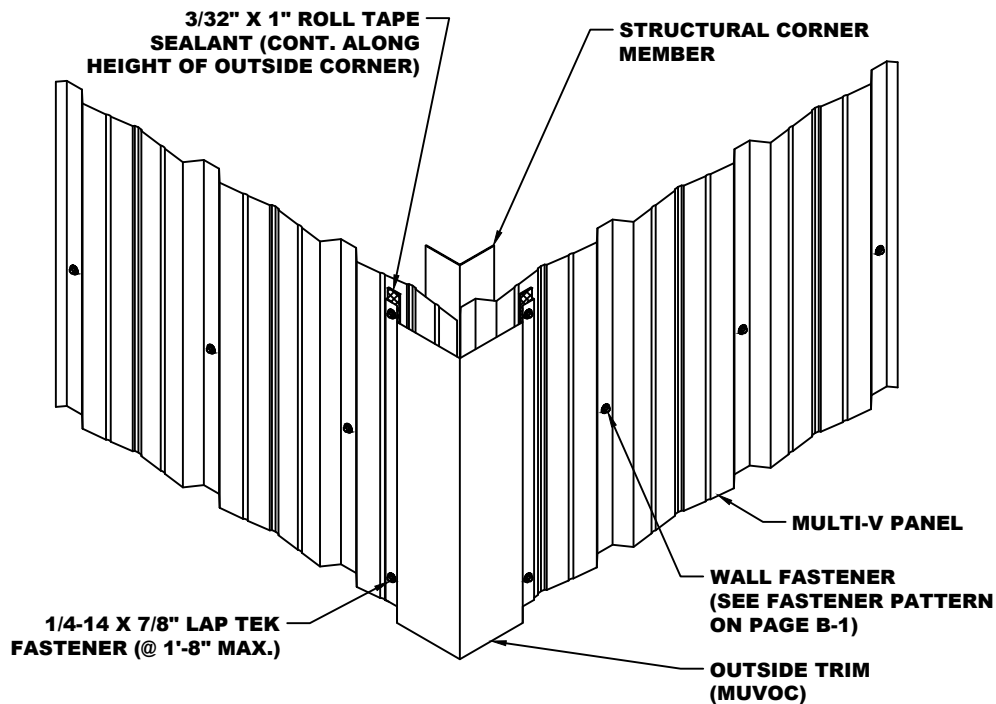

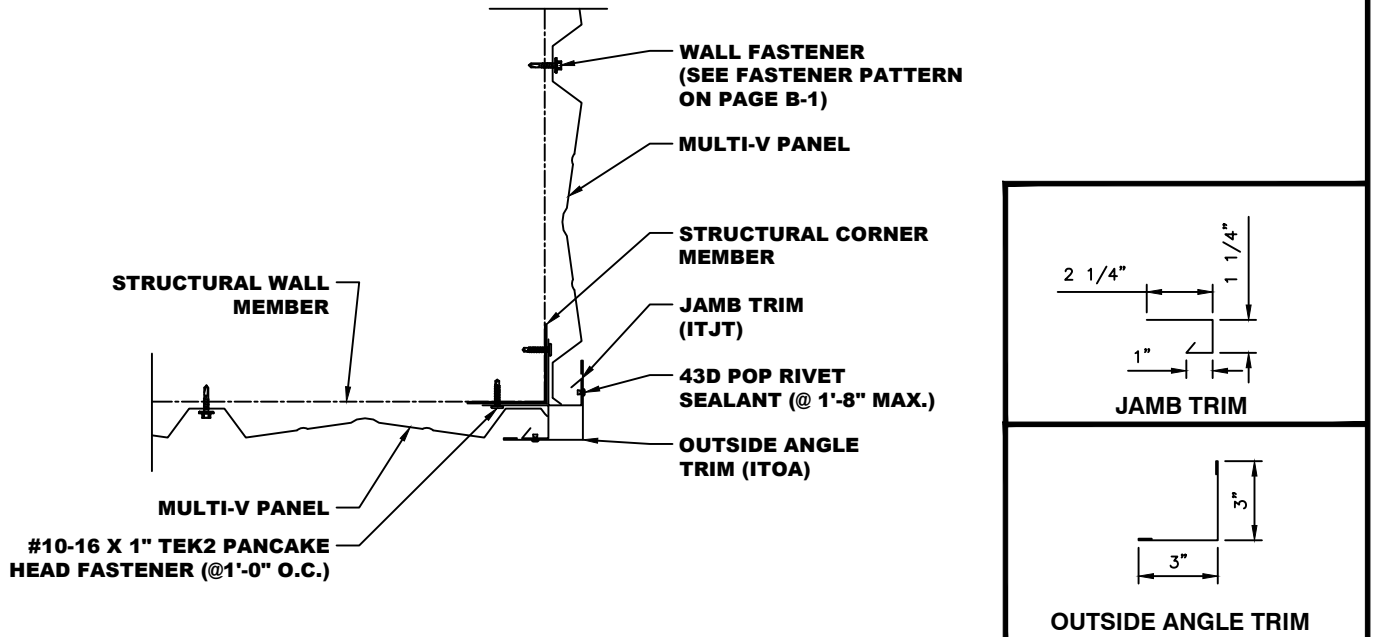

- NOTES:**
1. Attach Jamb Trim to Structural Corner Member with #10-16 x 1" Tek2 Pancake Head Fasteners at 1'-0" O.C.
 2. Attach Multi-V Panels to framework with Wall Fasteners. See Fastener Pattern on page B-1.
 3. Outside Angle Trim to run from Base Trim to top of wall panel.
 4. Attach Outside Angle Trim to Jamb Trim with 43D Pop Rivets at 1'-8" O.C. (Max.)

*NOTE: SOME TRIM ITEMS AND FASTENERS HAVE BEEN REMOVED FOR CLARITY OF ISOMETRIC DETAIL.

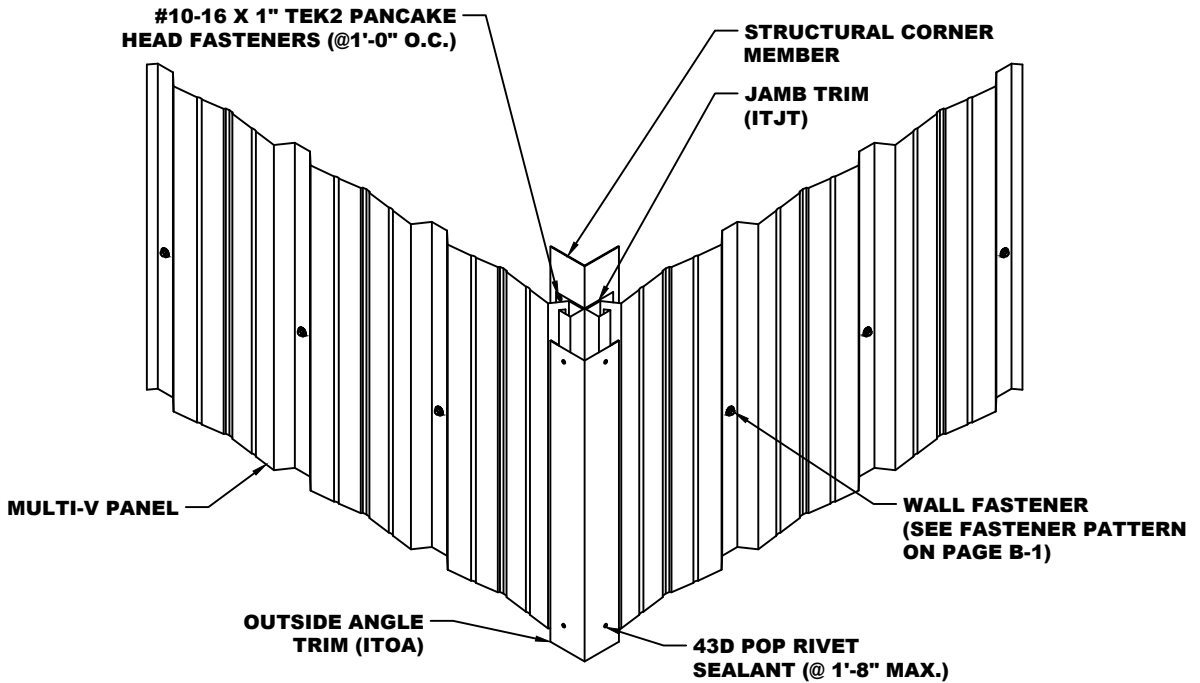

MULTI-V ALT. OUTSIDE CORNER (OFF MODULE) DETAIL

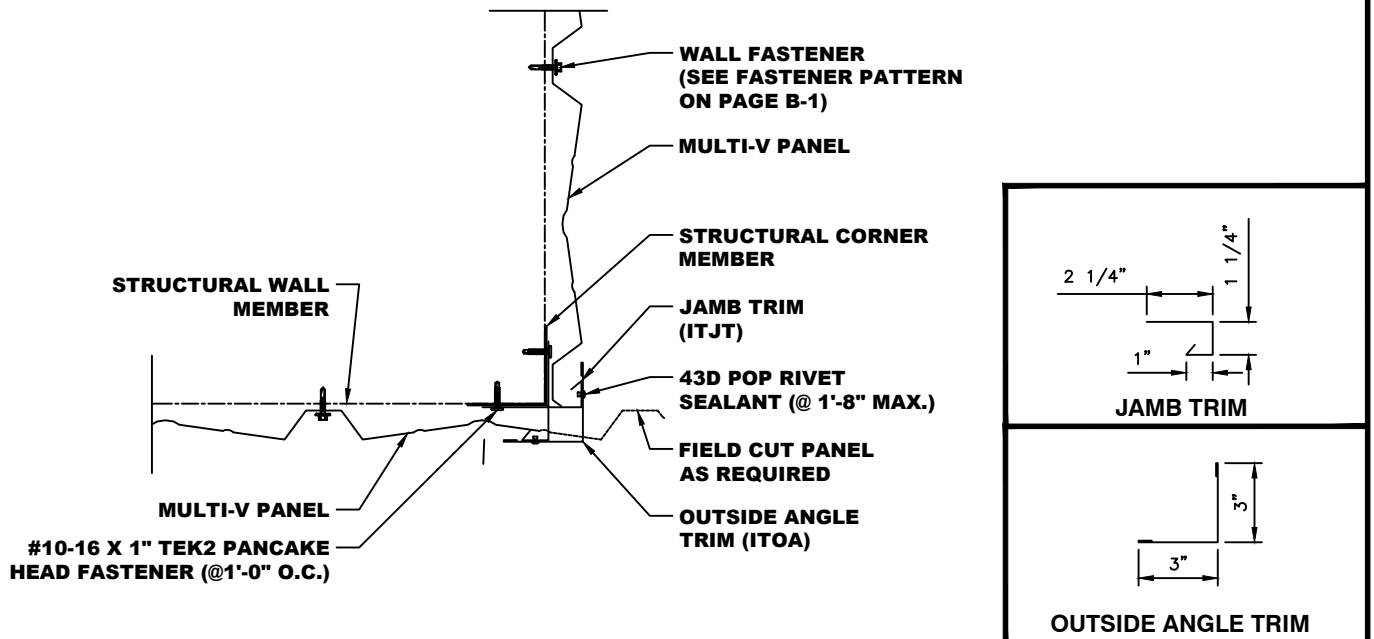

- NOTES:**
1. Attach Jamb Trim to Structural Corner Member with #10-16 x 1" Tek2 Pancake Head Fasteners at 1'-0" O.C.
 2. Attach Multi-V Panels to framework with Wall Fasteners. See Fastener Pattern on page B-1.
 3. Outside Angle Trim to run from Base Trim to top of wall panel.
 4. Attach Outside Angle Trim to Jamb Trim with 43D Pop Rivets at 1'-8" O.C. (Max.)

*NOTE: SOME TRIM ITEMS AND FASTENERS HAVE BEEN REMOVED FOR CLARITY OF ISOMETRIC DETAIL.

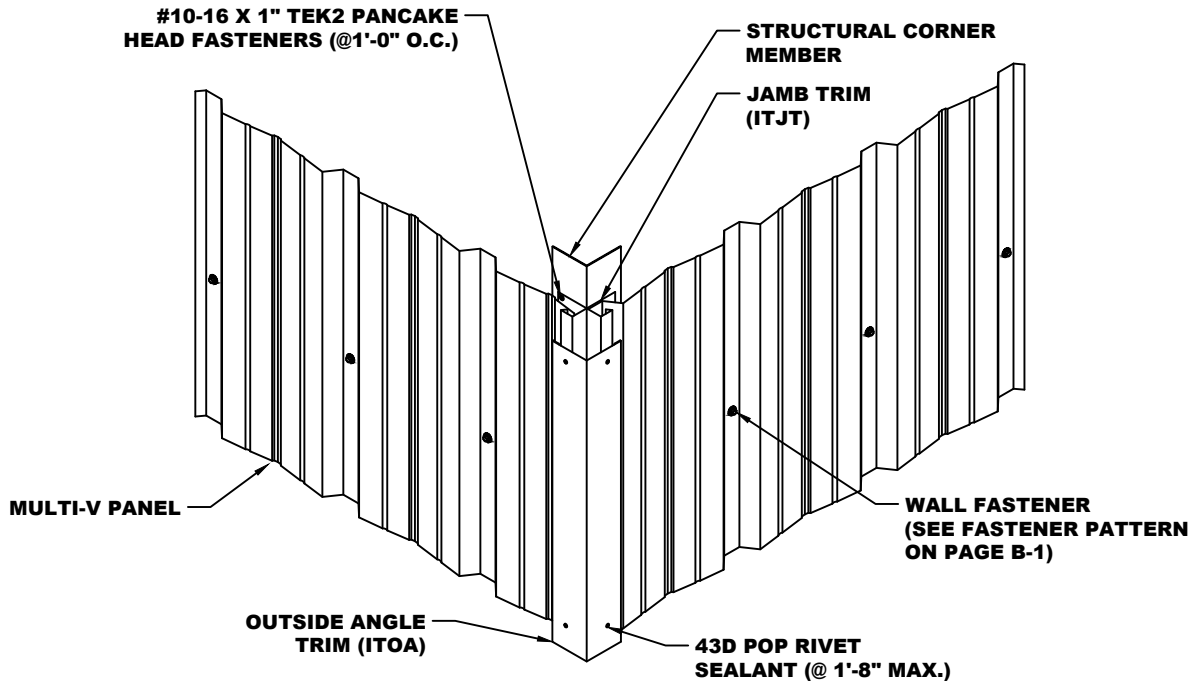

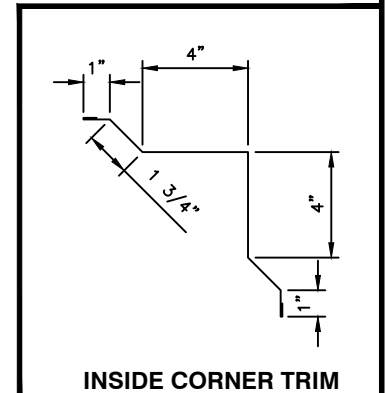
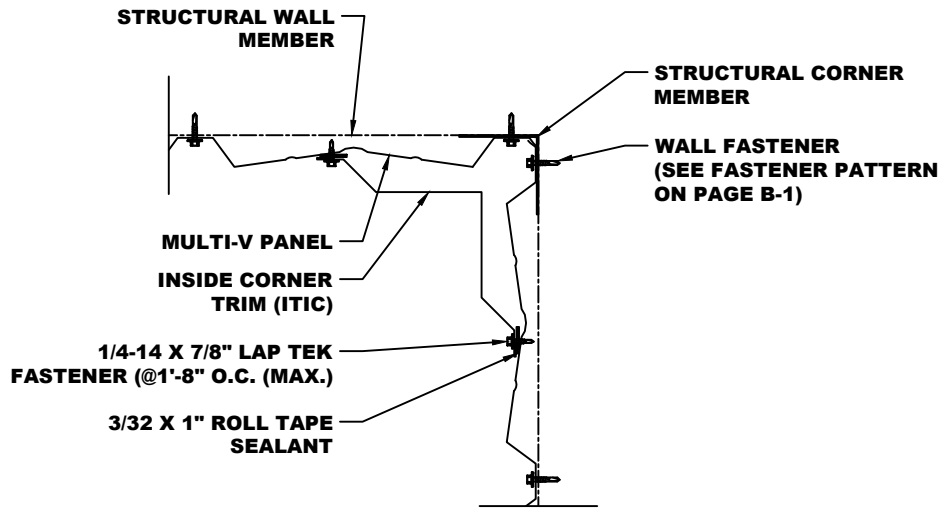

- NOTES:**
1. Attach Multi-V Panels to framework with Wall Fasteners. See Fastener Pattern on page B-1.
 2. Inside Corner Trim to run from Base Trim to top of wall panel.
 3. Before installing Inside Corner Trim, apply a continuous bead of 3/32" x 1" Roll Tape Sealant to the sides of the trim. Set in place and attach to wall panels with 1/4-14 x 7/8" Lap Tek Fasteners at 1'-8" O.C. (Max.).

*NOTE: SOME TRIM ITEMS AND FASTENERS HAVE BEEN REMOVED FOR CLARITY OF ISOMETRIC DETAIL.

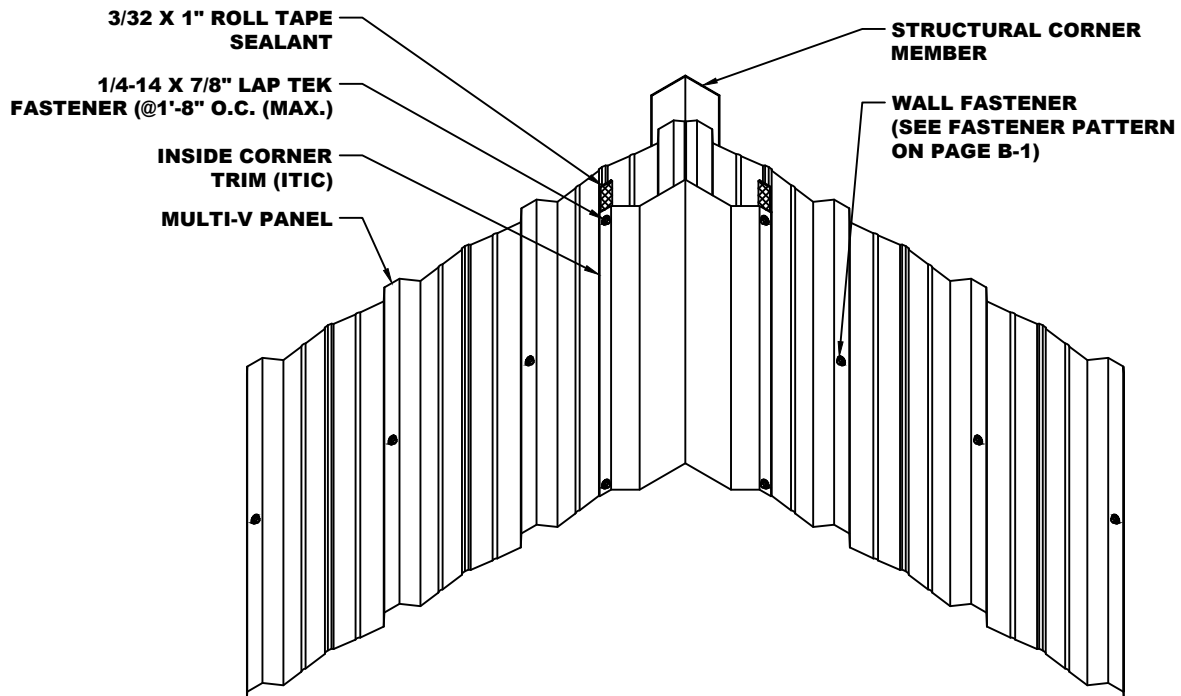

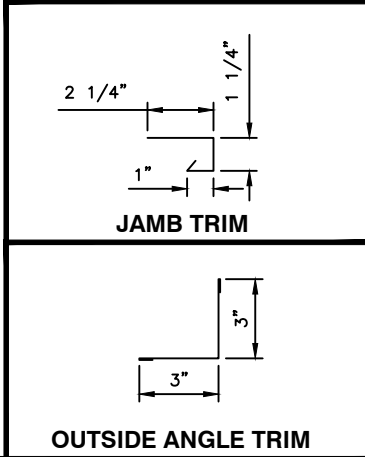
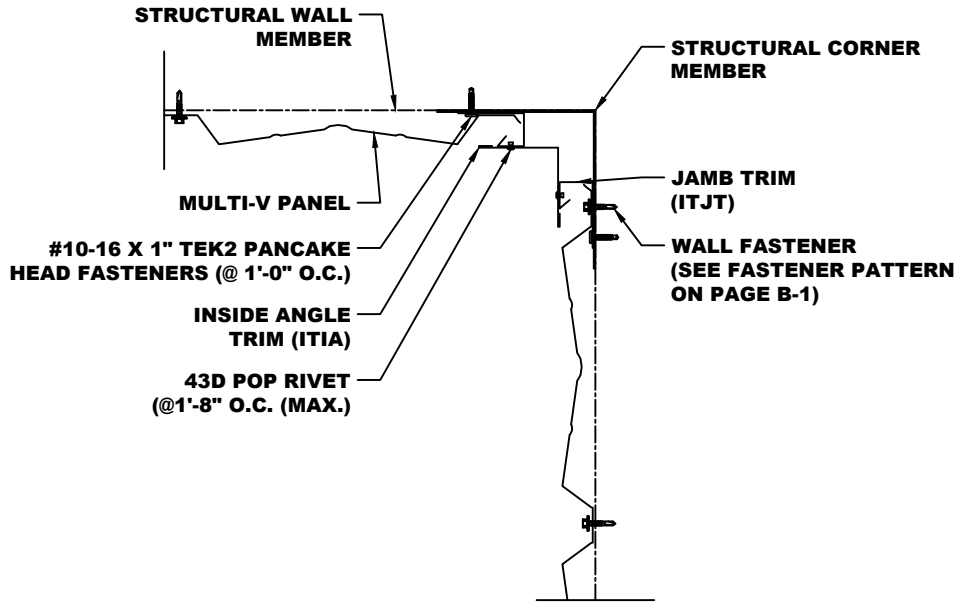

- NOTES:**
1. Attach Jamb Trim to Structural Corner Member with #10-16 x 1" Tek2 Pancake Head Fasteners at 1'-0" O.C.
 2. Attach Multi-V Panels to framework with Wall Fasteners. See Fastener Pattern on page B-1.
 3. Inside Angle Trim to run from Base Trim to top of wall panel.
 4. Attach Inside Angle Trim to Jamb Trim with 43D Pop Rivets at 1'-8" O.C. (Max.)

*NOTE: SOME TRIM ITEMS AND FASTENERS HAVE BEEN REMOVED FOR CLARITY OF ISOMETRIC DETAIL.

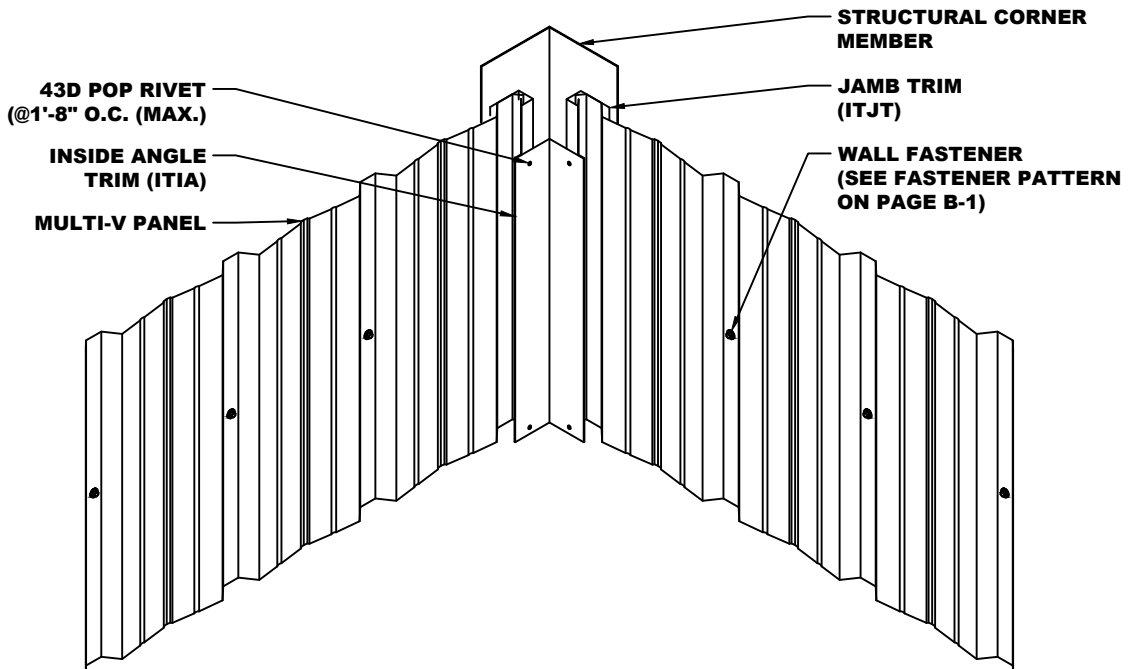

MULTI-V ALT. INSIDE CORNER (OFF MODULE) DETAIL

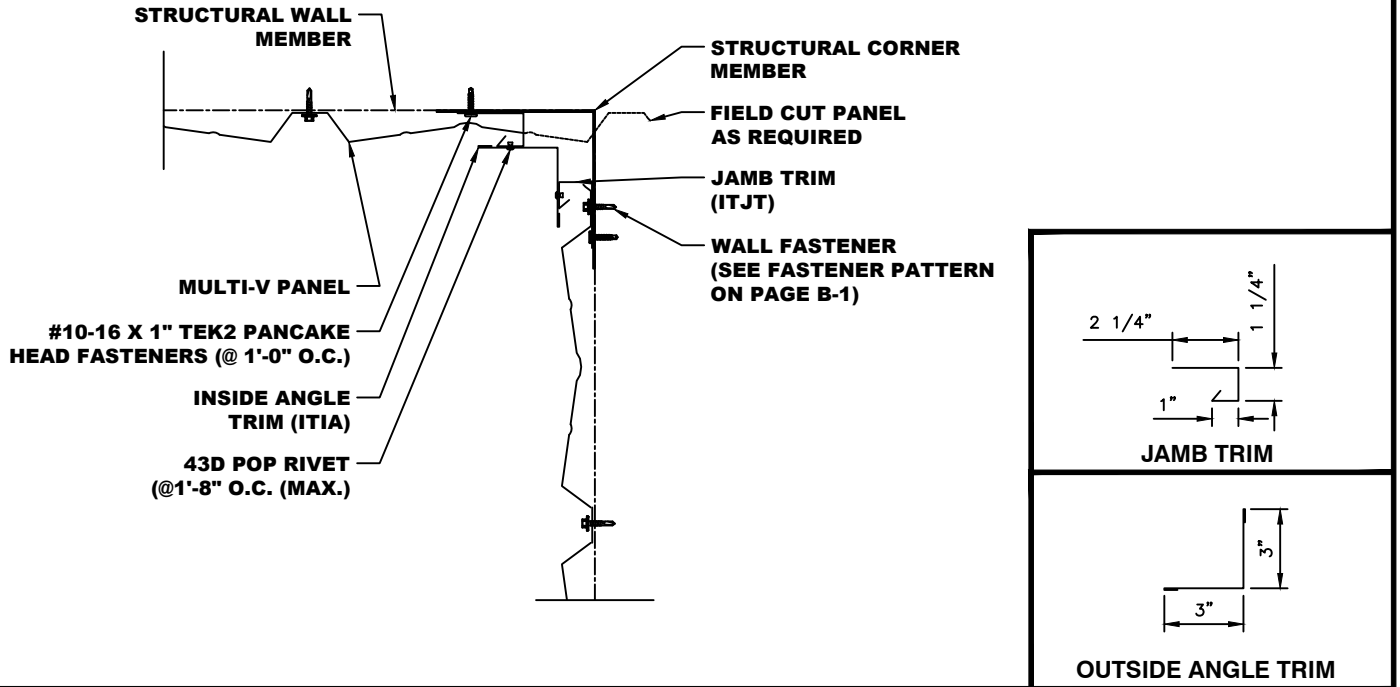

- NOTES:**
1. Attach Jamb Trim to Structural Corner Member with #10-16 x 1" Tek2 Pancake Head Fasteners at 1'-0" O.C.
 2. Attach Multi-V Panels to framework with Wall Fasteners. See Fastener Pattern on page B-1.
 3. Inside Angle Trim to run from Base Trim to top of wall panel.
 4. Attach Inside Angle Trim to Jamb Trim with 43D Pop Rivets at 1'-8" O.C. (Max.)

*NOTE: SOME TRIM ITEMS AND FASTENERS HAVE BEEN REMOVED FOR CLARITY OF ISOMETRIC DETAIL.

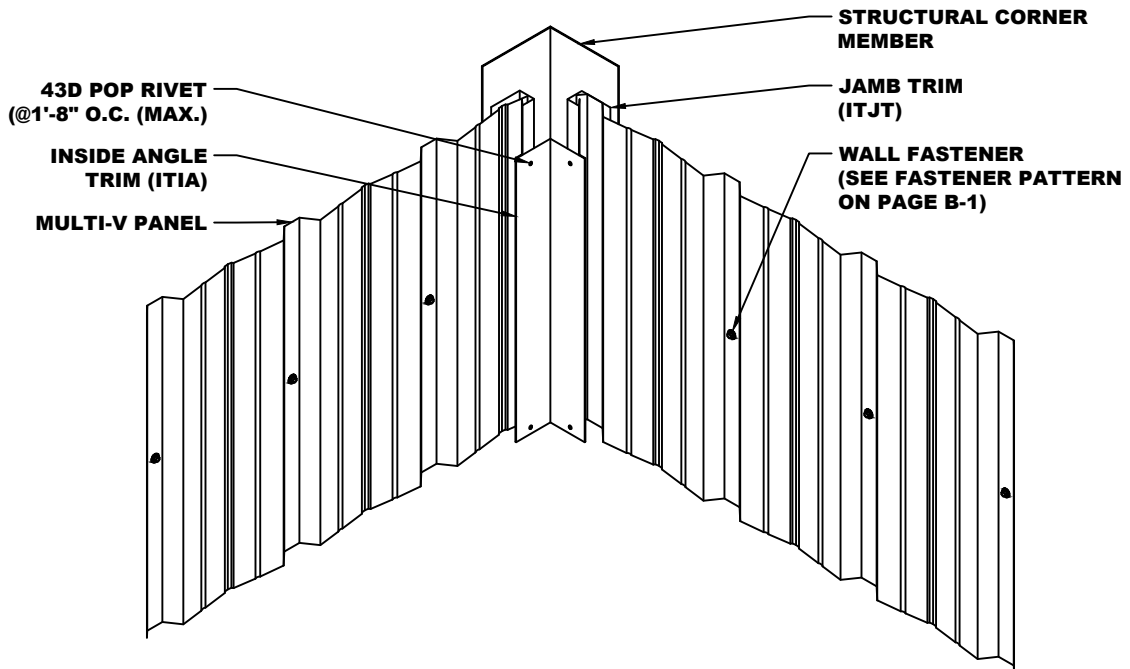

PANEL ENDLAP DETAIL

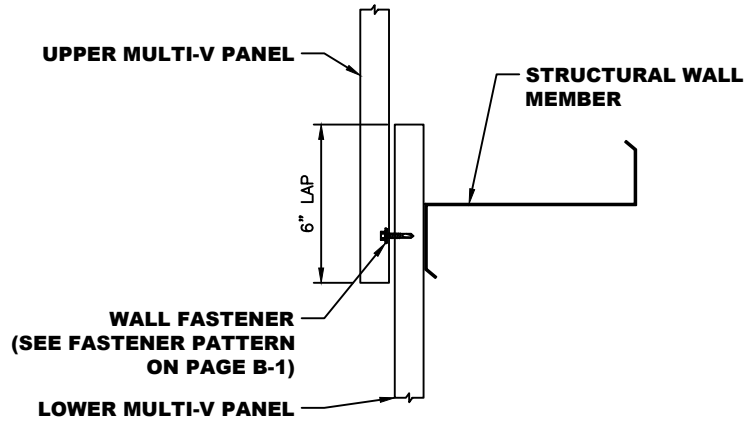

- NOTES:** 1. Attach Lower Multi-V Panel to structure with Wall Framing Fasteners. Do not fasten at endlap Structural Wall Member.
2. Set Upper Multi-V Panel in place and overlap 6". Attach to framework with Wall Fasteners. See Fastener Pattern on page B-1.

*NOTE: SOME TRIM ITEMS AND FASTENERS HAVE BEEN REMOVED FOR CLARITY OF ISOMETRIC DETAIL.

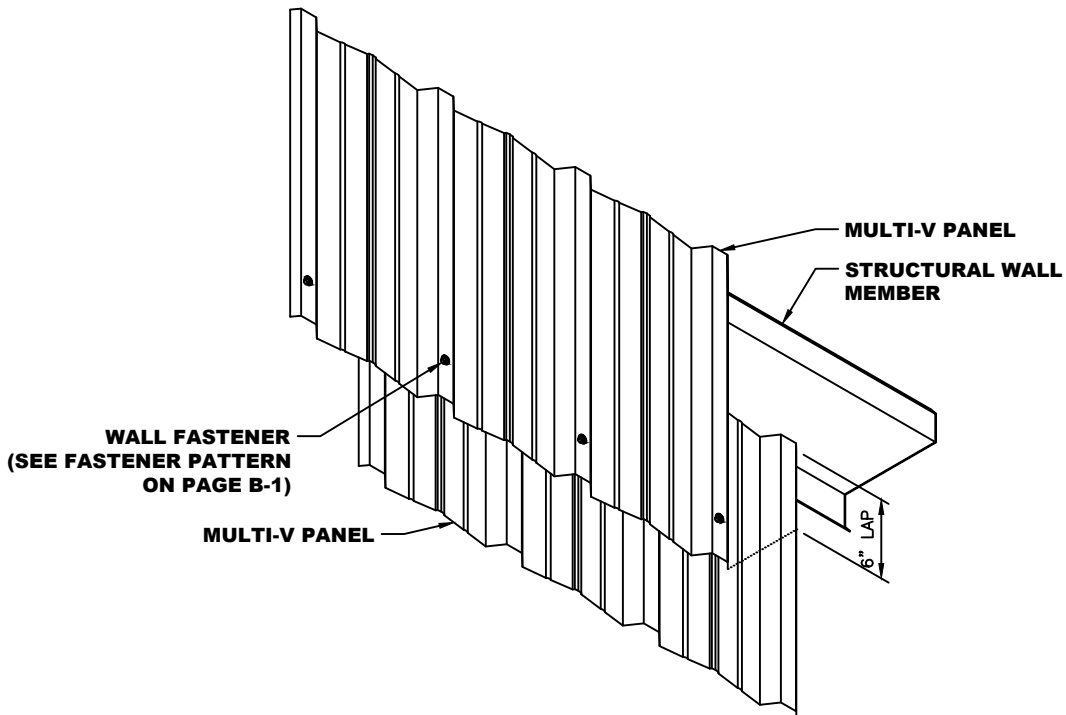

HEAD TRIM DETAIL

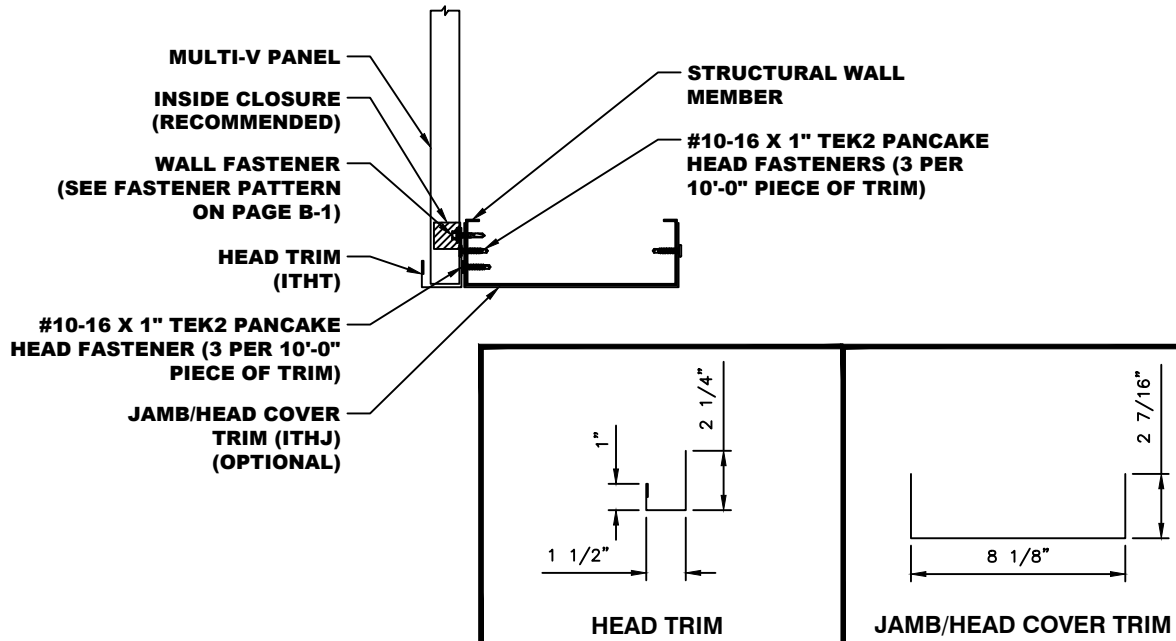

- NOTES:**
1. Attach Head Trim to Structural Wall Member #10-16 x 1" TEK2 Pancake Head Fasteners at (3) per 10'-0" piece of trim.
 2. Set Inside Closure in position on Head Trim.
 3. Install Multi-V Panel to Structural Wall Member with framing fasteners using Fastener Pattern on page B-1.

*NOTE: SOME TRIM ITEMS AND FASTENERS HAVE BEEN REMOVED FOR CLARITY OF ISOMETRIC DETAIL.

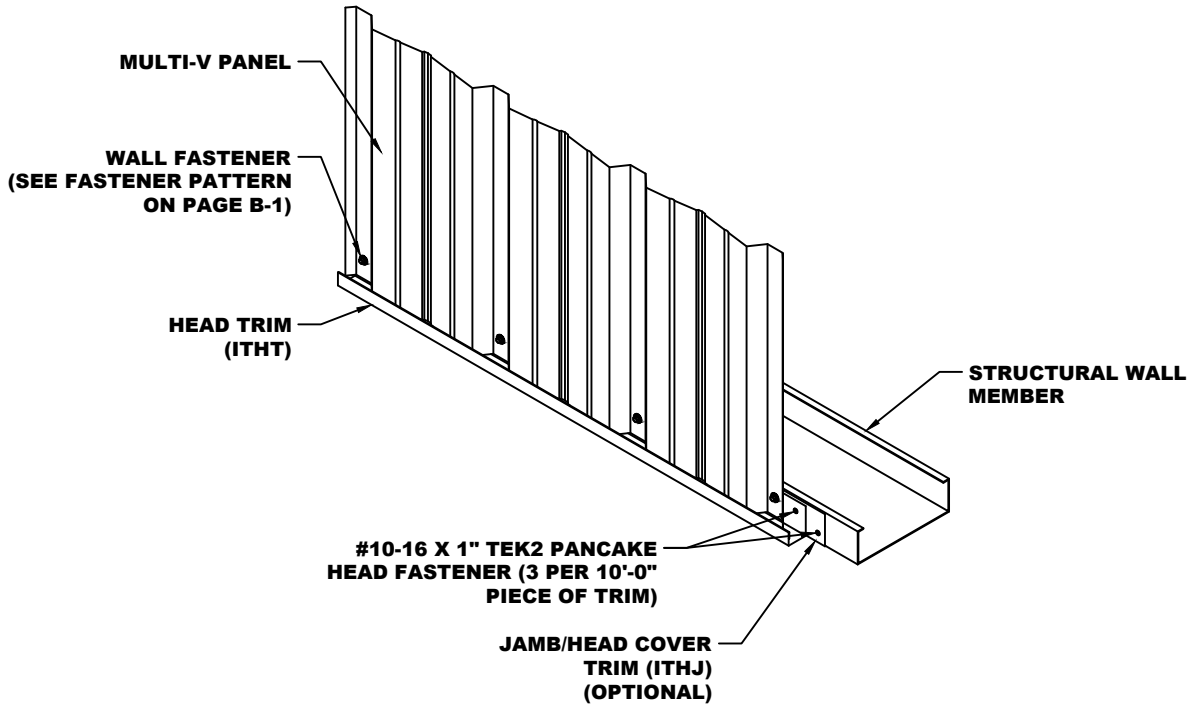

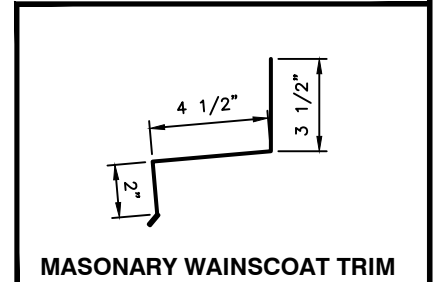
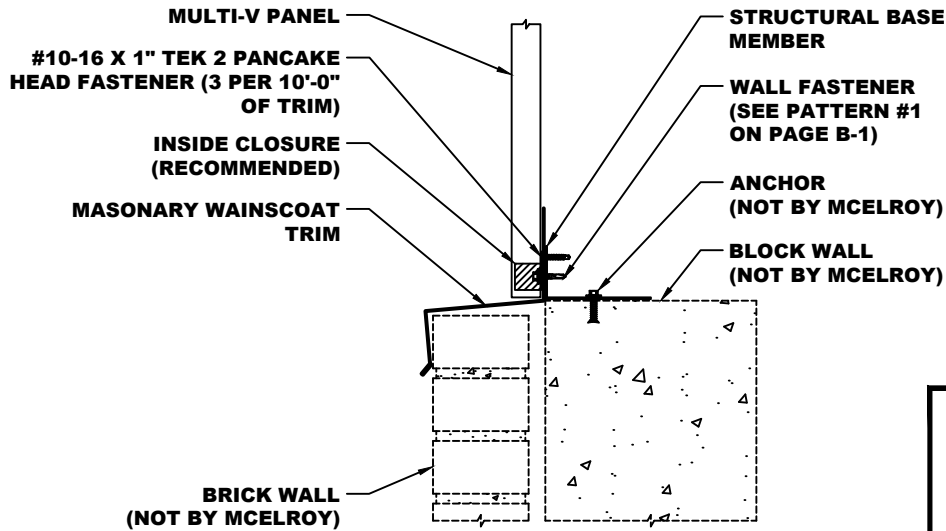

- NOTES:**
1. Structural Base Member set flush with edge of Block Wall.
 2. Set Masonry Wainscoat Trim flush with Structural Base Member. Attach with (3) #10-16 x 1" Tek2 Pancake Head Fasteners per 10'-0" piece of trim.
 3. Set Closure in position on Masonry Wainscoat Trim.
 4. Set Multi-V Wall Panel into place. Make sure to leave a 1/8" gap between trim and panel.
 5. Attach panel with Framing Fasteners per Fastening Pattern shown on page B-1.

*NOTE: SOME TRIM ITEMS AND FASTENERS HAVE BEEN REMOVED FOR CLARITY OF ISOMETRIC DETAIL.

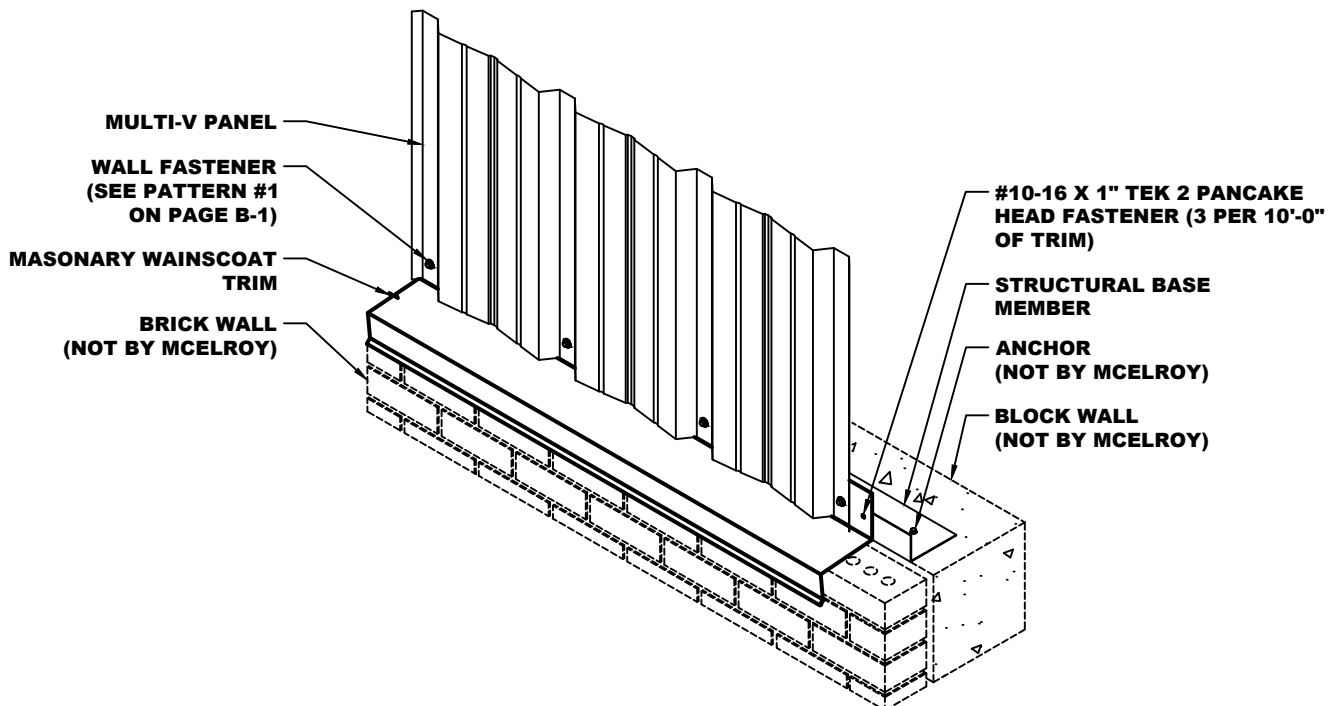

JAMB TRIM DETAIL

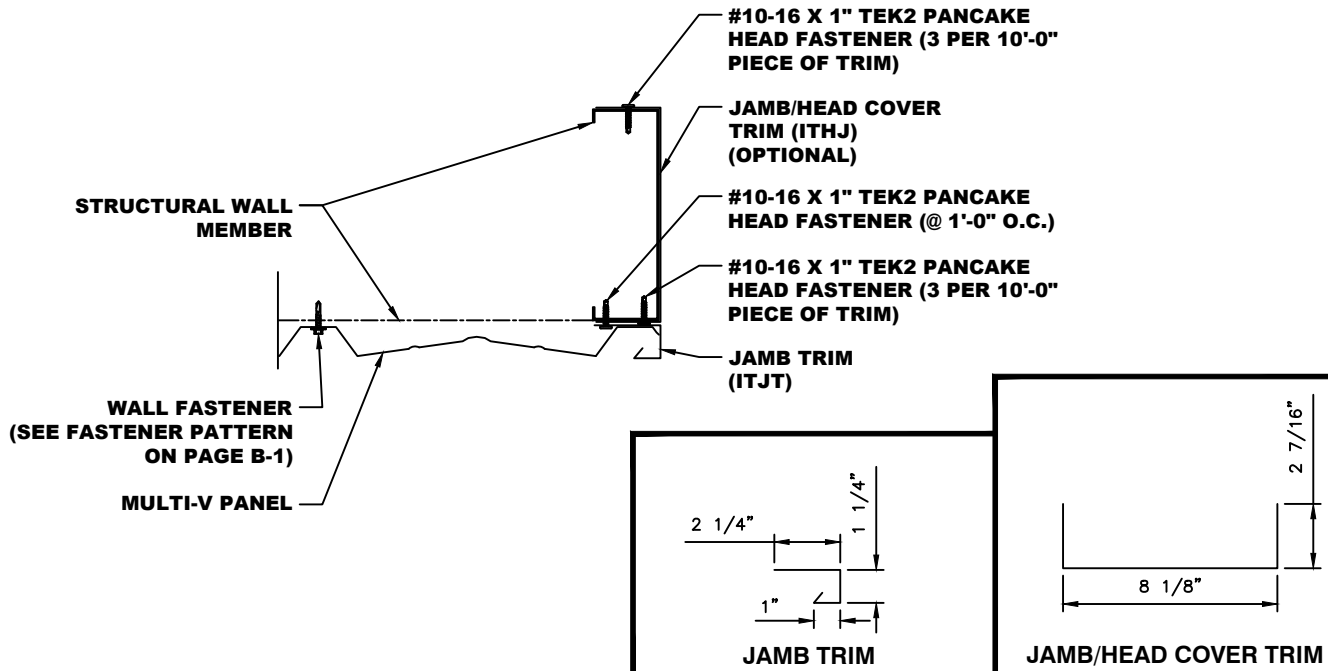

- NOTES:**
1. Attach Jamb Trim to Structural Wall Member with #10-16 x 1" TEK2 Pancake Head Fasteners at 1'-0" O.C.
 2. Install Multi-V Panel to Structural Wall Member with Framing Fasteners using Fastener Pattern on page B-1.

*NOTE: SOME TRIM ITEMS AND FASTENERS HAVE BEEN REMOVED FOR CLARITY OF ISOMETRIC DETAIL.

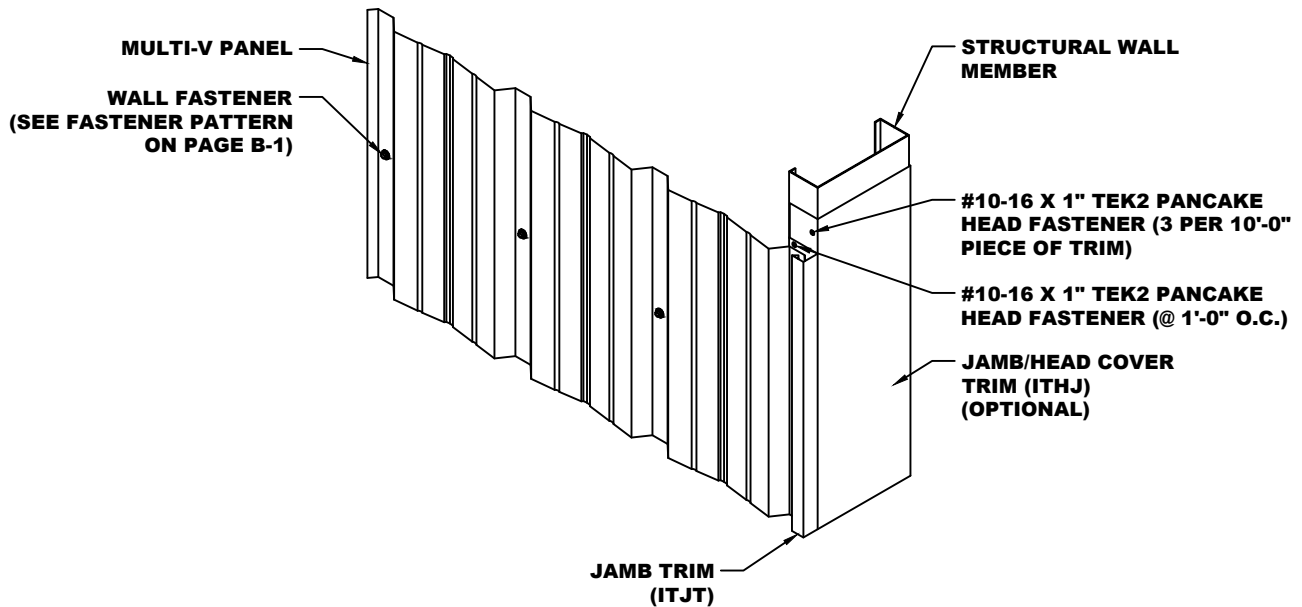

JAMB TRIM (OFF MODULE) DETAIL

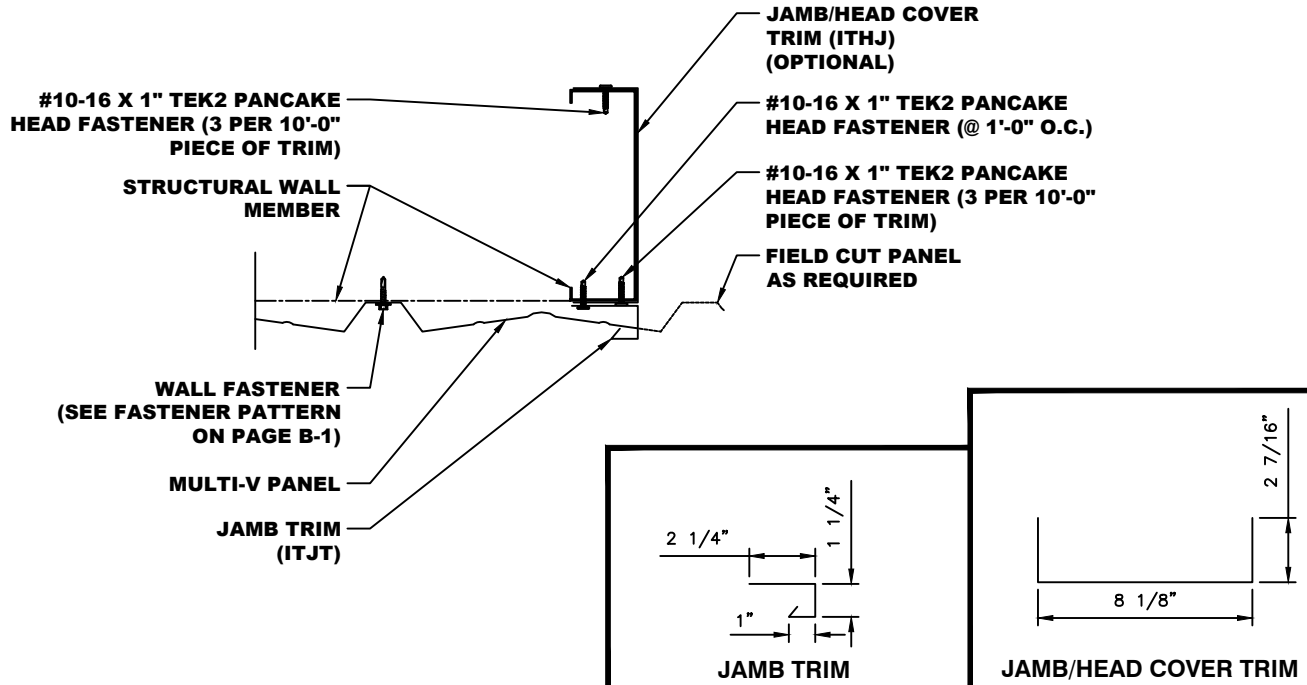

- NOTES:**
1. Attach Jamb Trim to Structural Wall Member with #10-16 x 1" TEK2 Pancake Head Fasteners at 1'-0" O.C.
 2. Install Multi-V Panel to Structural Wall Member with Framing Fasteners using Fastener Pattern on page B-1.

*NOTE: SOME TRIM ITEMS AND FASTENERS HAVE BEEN REMOVED FOR CLARITY OF ISOMETRIC DETAIL.

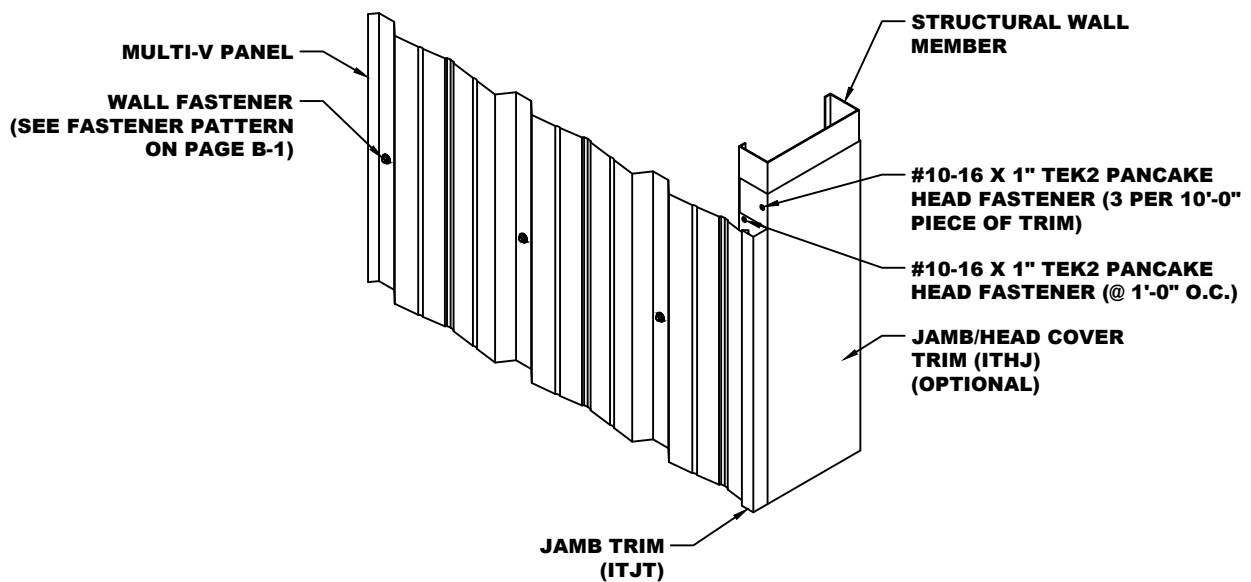

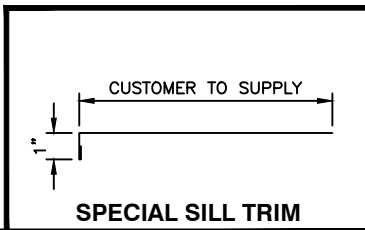
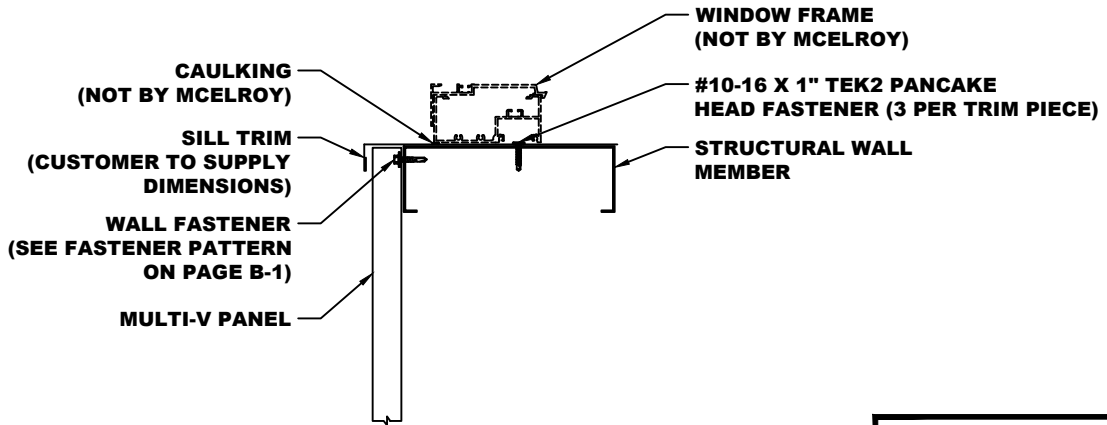

- NOTES:** 1. Install Multi-V Panel to Structural Wall Member with Framing Fasteners using Fastener Pattern on page B-1.
 2. Attach Special Sill Trim to Structural Wall Member with #10-16 x 1" Tek2 Pancake Head Fasteners at (3) per trim piece.

*NOTE: SOME TRIM ITEMS AND FASTENERS HAVE BEEN REMOVED FOR CLARITY OF ISOMETRIC DETAIL.

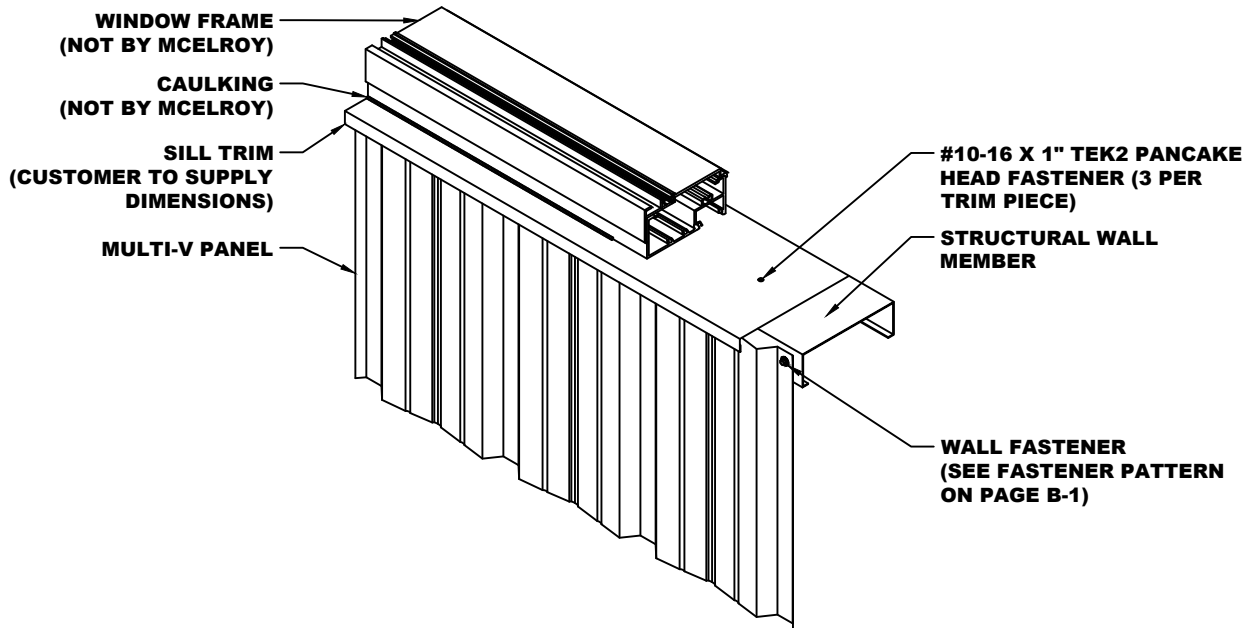

SIDEWALL DETAIL

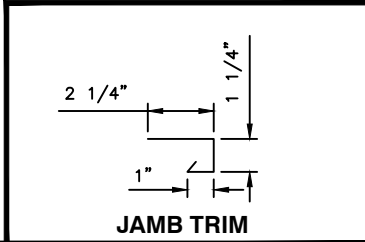
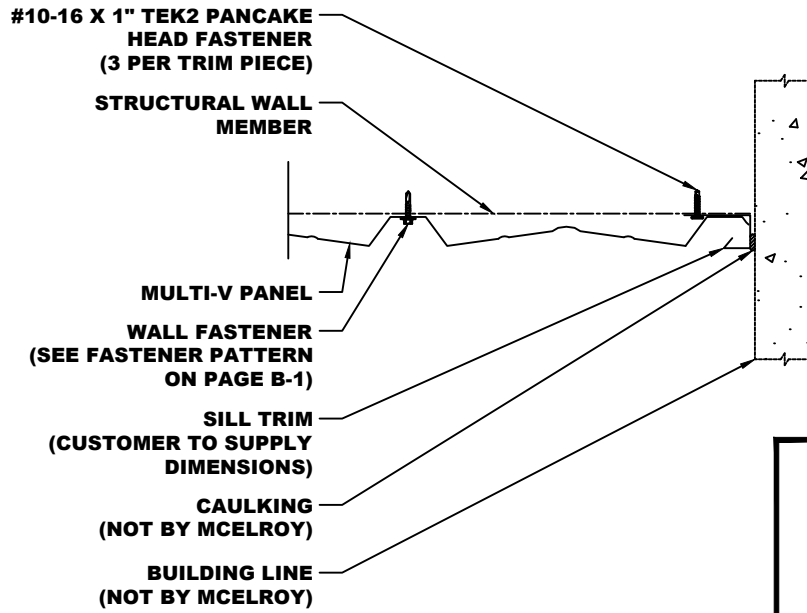

- NOTES:**
1. Attach Jamb Trim to Structural Wall Member with #10-16 x 1" TEK2 Pancake Head Fasteners at 1'-0" O.C.
 2. Install Multi-V Panel to Structural Wall Member with Framing Fasteners using Fastener Pattern on page B-1.

*NOTE: SOME TRIM ITEMS AND FASTENERS HAVE BEEN REMOVED FOR CLARITY OF ISOMETRIC DETAIL.

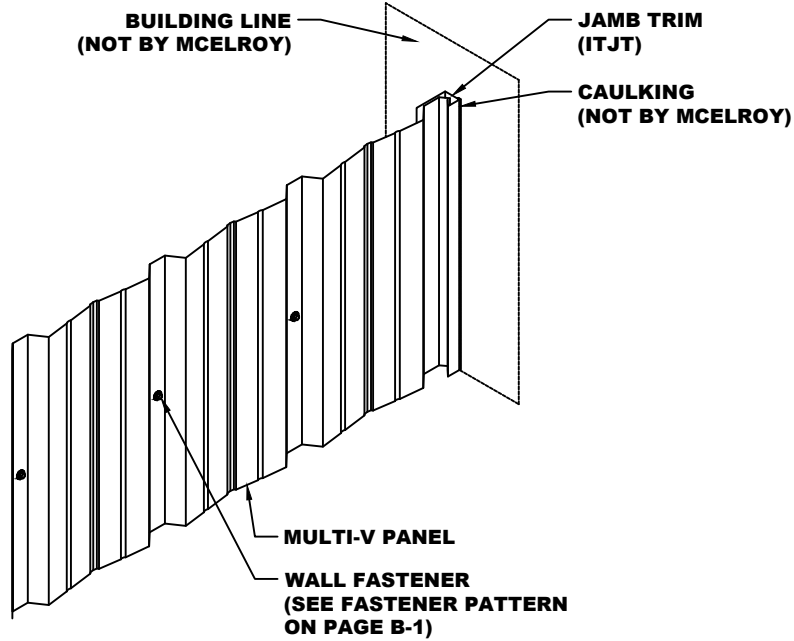

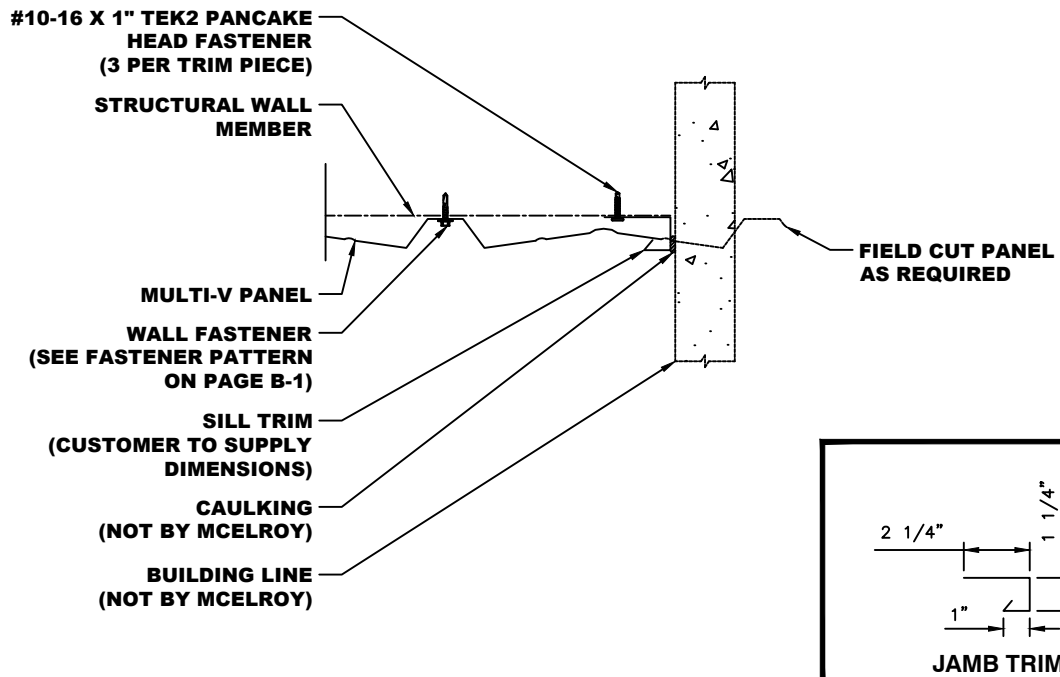

- NOTES:**
1. Attach Jamb Trim to Structural Wall Member with #10-16 x 1" TEK2 Pancake Head Fasteners at 1'-0" O.C.
 2. Field cut Multi-V Panel and attach to Structural Wall Member with Framing Fasteners using Fastener Pattern on page B-1.

*NOTE: SOME TRIM ITEMS AND FASTENERS HAVE BEEN REMOVED FOR CLARITY OF ISOMETRIC DETAIL.

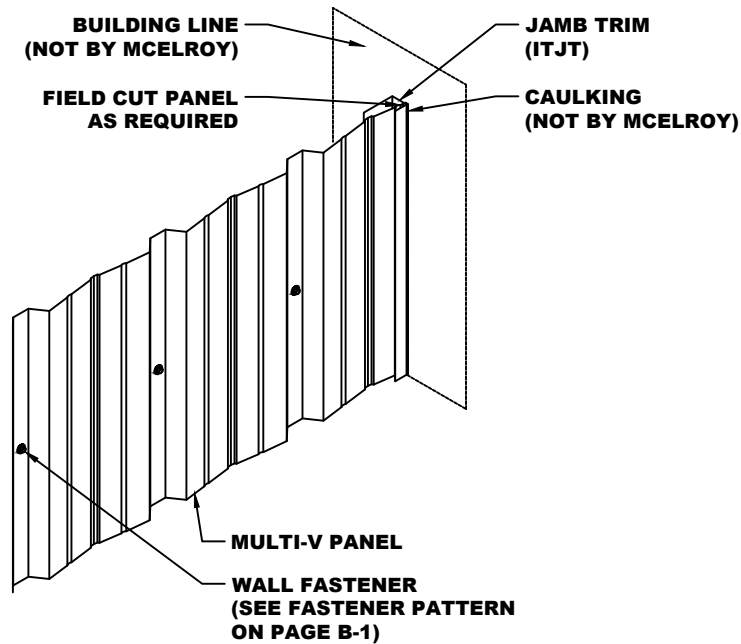

☆ MANUFACTURING LOCATIONS ● SERVICE CENTERS ★ MANUFACTURING AND SERVICE CENTER



CORPORATE OFFICE
1500 HAMILTON RD.
BOSSIER CITY, LA 71111

MANUFACTURING LOCATIONS

ADELANTO, CA ASHBURN, GA BOSSIER CITY, LA CLINTON, IL DIAMOND, MO
HOUSTON, TX LEWISPORT, KY LOCKHART, TX MARSHALL, MI MAUSTON, WI
MERKEL, TX PEACHTREE CITY, GA SUNNYVALE, TX WINCHESTER, VA

McELROY METAL
SERVICE
CENTER
EMPLOYEE OWNED

17031 Koala Road Adelanto, CA 92301	5215 Leo St. Alexandria, LA 71301	1007 Wilso Dr, Baltimore, MD 21223	1500 Hamilton Rd. Bossier City, LA 71111
3052 Yadkin Road Chesapeake, VA 23323	9476 Meadowbrook Rd. Clinton, IL 61727	3215 Highway 59 Diamond, MO 64840	390 N. Valley Dell Dr. Fenton, MO 63026
409 Lovejoy Road Ft. Walton Beach, FL 32548	3014 Lincoln Court Garland, TX 75041	1440 Aldine Bender Road Houston, TX 77032	221 Benelli Drive Hutto, TX 78634
10504 E. 59th Street Indianapolis, IN 46236	32 Industrial Circle Lancaster, PA 17601	9435 US Hwy. 60 W. Lewisport, KY 42351	2701 Cahill Street Lockhart, TX 78644
1020 Veterans Street Mauston, WI 53948	5123 Terminal Dr. McFarland, WI 53558	514 Cave Road Nashville, TN 37210	8304 Hwy. 70 E. North Little Rock, AR 72117
613 North Bierdeman Rd. Pearl, MS 39208	8511 Industrial Drive Pearland, TX 77584	2755 Hwy 60 Pendergrass, GA 30567	7450 Tower Street Richland Hills, TX 76118
8200 Berry Ave. Suite 100 Sacramento, CA 95828	1365 Dean Forest Rd. Savannah, GA 31405	7355 Oakley Industrial Blvd. Union City, GA 30291	1144 Silstar Rd. West Columbia, SC 29170
325 McGhee Rd. Winchester, VA 22603			

Website: www.mcelroymetal.com · E-mail: info@mcelroymetal.com