

MODERN-RIB

INSTALLATION

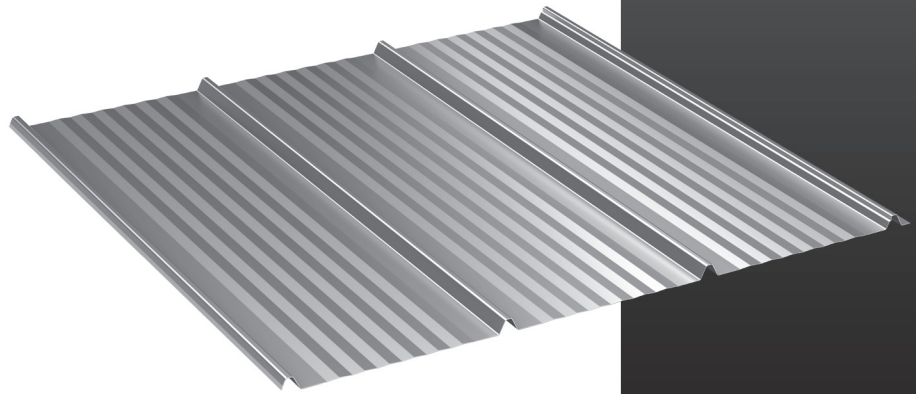

NOTES



TECHNICAL SERVICE
1-800-950-9082

TABLE OF CONTENTS

PAGE NUMBER:	DETAIL DESCRIPTION
A-1.....	TABLE OF CONTENTS
A-2.....	GENERAL NOTES
B-1.....	FASTENER PATTERNS
C-1.....	M 1.5" EAVE DRIP TRIM DETAIL
C-2.....	DENVER EAVE DETAIL
C-3.....	DENVER EAVE w/ GUTTER DETAIL
C-4.....	DENVER RAKE TRIM DETAIL
C-5.....	DENVER RAKE TRIM DETAIL (OFF MODULE)
C-6.....	STEP RAKE TIE-IN / SIDEWALL TRIM DETAIL
C-7.....	STEP RAKE TIE-IN / SIDEWALL TRIM DETAIL (OFF MODULE)
C-8.....	RIDGE TRIM DETAIL
C-9.....	RIDGE TRIM w/ ZEE CLOSURE DETAIL
C-10.....	HI-SIDE TIE-IN / ENDWALL TRIM DETAIL
C-11.....	HI-SIDE / ENDWALL TRIM w/ ZEE CLOSURE DETAIL
C-12.....	HIP TRIM DETAIL
C-13.....	HIP TRIM w/ ZEE CLOSURE DETAIL
C-14.....	HIGH EAVE / M 2.75" PEAK TRIM DETAIL
C-15.....	HIGH EAVE / M 2.75" PEAK TRIM w/ ZEE CLOSURE DETAIL
C-16.....	PITCH BREAK TRIM DETAIL
C-17.....	PITCH BREAK w/ ZEE CLOSURE TRIM DETAIL
C-18.....	VALLEY DETAIL
C-19 & C-20.....	TYPICAL TRIM LAP DETAILS

GENERAL NOTES

The details shown on the following pages are suggestions or guidelines for installing the Modern-Rib roof panel system over plywood. The installation details shown here are proven methods of construction, but they are not intended to cover all building requirements, designs or codes. The details may require changes or revisions due to individual project conditions.

Installation procedures shall be in accordance with the manufacturer's printed instructions, details or approved shop drawings. Installers should thoroughly familiarized themselves with all instructions prior to beginning the installation process.

The designer/installer is responsible to ensure the following:

That the details here meet the particular building requirements.

Awareness of and allowance for expansion/contraction of the roof panels.

That adequate water-tightness is maintained.

That a proper uniform substructure is used to avoid panel distortion and that the substructure meets necessary code requirements.

That all supporting members have been examined and are straight, level and plumb.

McElroy Metal can provide all flashings and accessories shown in the installation drawings unless noted otherwise. Panels, flashing and trim shall be installed true and in proper alignment with any exposed fasteners equally spaced for the best appearance. Sealant shall be field applied on a clean, dry surface.

Some field cutting and fitting of panels and flashings is to be expected and to be considered a part of normal installation work. Workmanship shall be of the best industry standards and with installation performed by experienced metal craftsmen.

Oil canning of metal panels is inherent in metal and is not a cause for rejection. Striated panels are recommended to reduce the appearance of oil canning.

Contents of this manual are subject to change without notice. To confirm this book is the most current copy, please visit McElroy Metal's website at www.mcelroymetal.com.

**1/4-14 X 7/8" LAP TEK
FASTENER W/ WASHER
(@ MAJOR RIBS)**

TRIM

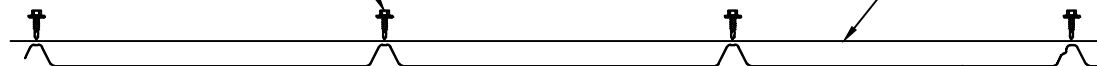

**PURLIN
BEARING LEG
MODERN-RIB
PANEL**

TRIM FASTENER PATTERN

**FASTENER PATTERN #1
#12-8 X 1 1/2" WOODGRIP
XG W/ WASHER (IS USED
AT EAVES, END LAPS
AND RIDGES)**

**3/32" X 3/8" ROLL TAPE
SEALANT (RUNS LENGTH
OF PANEL AT SIDELAPS)
TO BE USED ON ROOF
SLOPES BELOW 3:12 TO 1:12**

**1/4-14 X 7/8" LAP TEK
FASTENER W/ WASHER
(@ 1'-8" O.C. MAX.)**



**FASTENER
PATTERN #1
FASTENER
PATTERN #2**

**FASTENER PATTERN #2
#12-8 X 1 1/2" WOODGRIP
XG W/ WASHER (IS USED
AT YOUR CALCULATED
FASTENER SPACINGS)**

**PURLIN
BEARING LEG
MODERN-RIB
PANEL**

PANEL FRAMING AND STITCH FASTENER PATTERNS

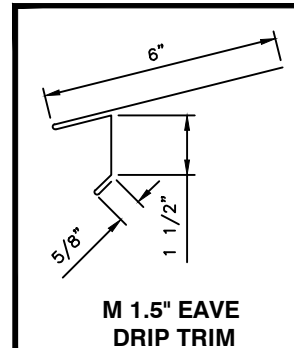
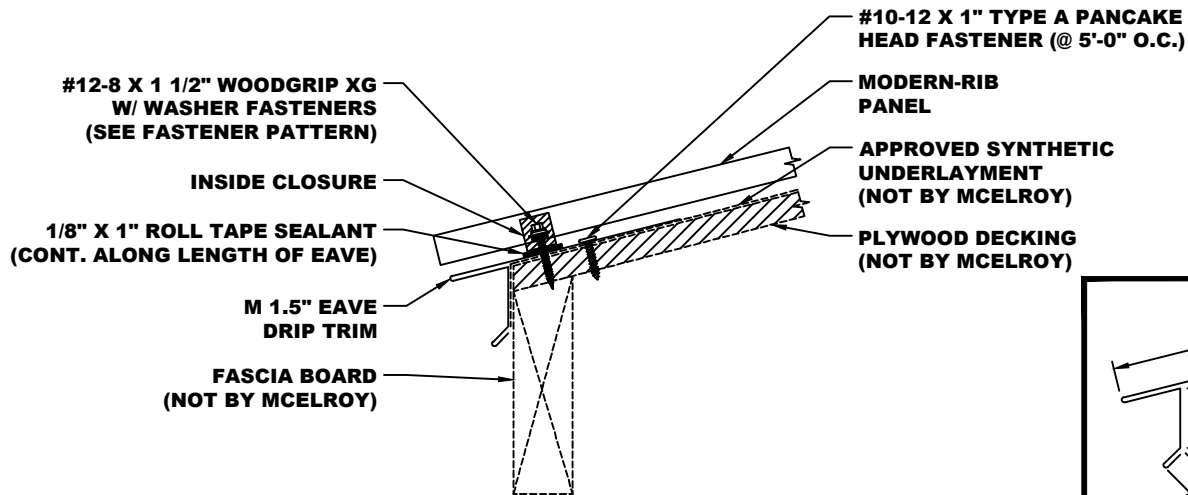

- NOTES:**
1. Attach M 1.5" Eave Drip Trim to Decking with #10-12 x 1" Type A Pancake Head Fasteners at 5'-0" O.C.
 2. Apply a continuous bead of 1/8" x 1" Roll Tape Sealant continuous along the length of the Eave. Set Inside Closures on continuous bead of 1" Tape Sealant.
 3. Set Modern-Rib Panel in place and attach to decking with #12-8 x 1 1/2" Woodgrip XG w/ Washer Fasteners See page B-1 for Fastener Patterns.

*NOTE: SOME TRIM ITEMS AND FASTENERS HAVE BEEN REMOVED FOR CLARITY OF ISOMETRIC DETAIL.

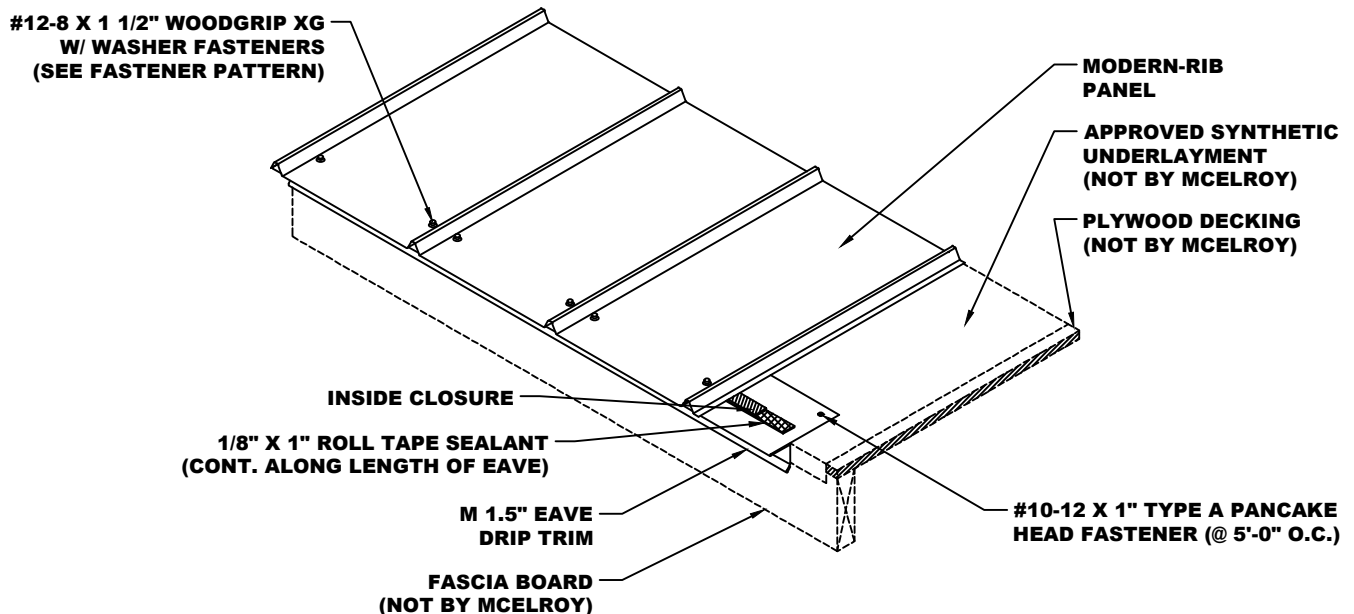

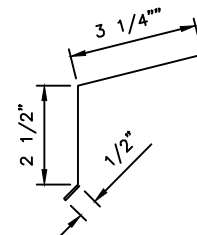
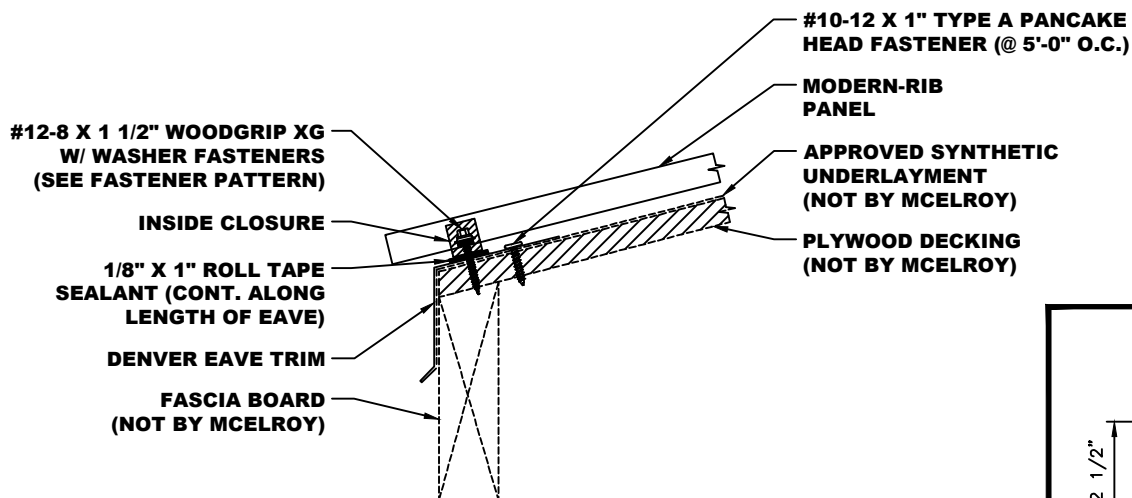

DENVER EAVE TRIM

- NOTES:** 1. Attach Denver Eave Drip Trim to Decking with #10-12 x 1" Type A Pancake Head Fasteners at 5'-0" O.C.
 2. Apply a continuous bead of 1/8" x 1" Roll Tape Sealant continuous along the length of the Eave. Set Inside Closures on continuous bead of 1" Tape Sealant.
 3. Set Modern-Rib Panel in place and attach to decking with #12-8 x 1 1/2" Woodgrip XG w/ Washer Fasteners See page B-1 for Fastener Patterns.

*NOTE: SOME TRIM ITEMS AND FASTENERS HAVE BEEN REMOVED FOR CLARITY OF ISOMETRIC DETAIL.

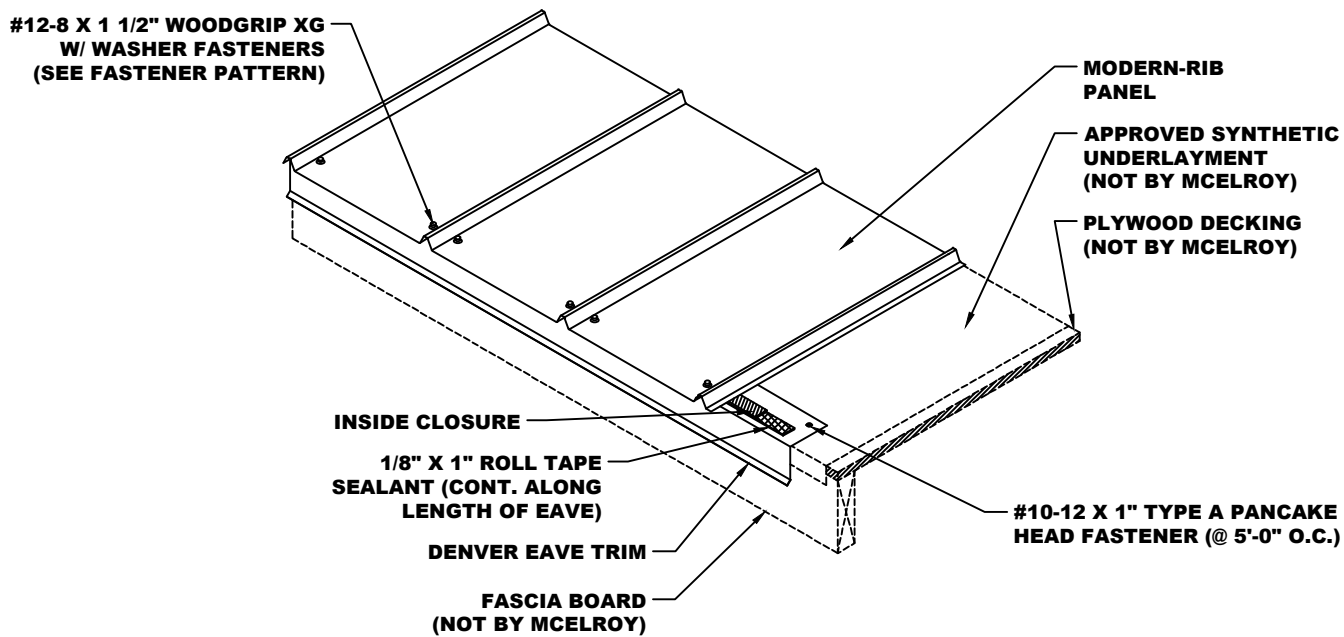

MODERN-RIB DENVER EAVE TRIM w/ GUTTER DETAIL

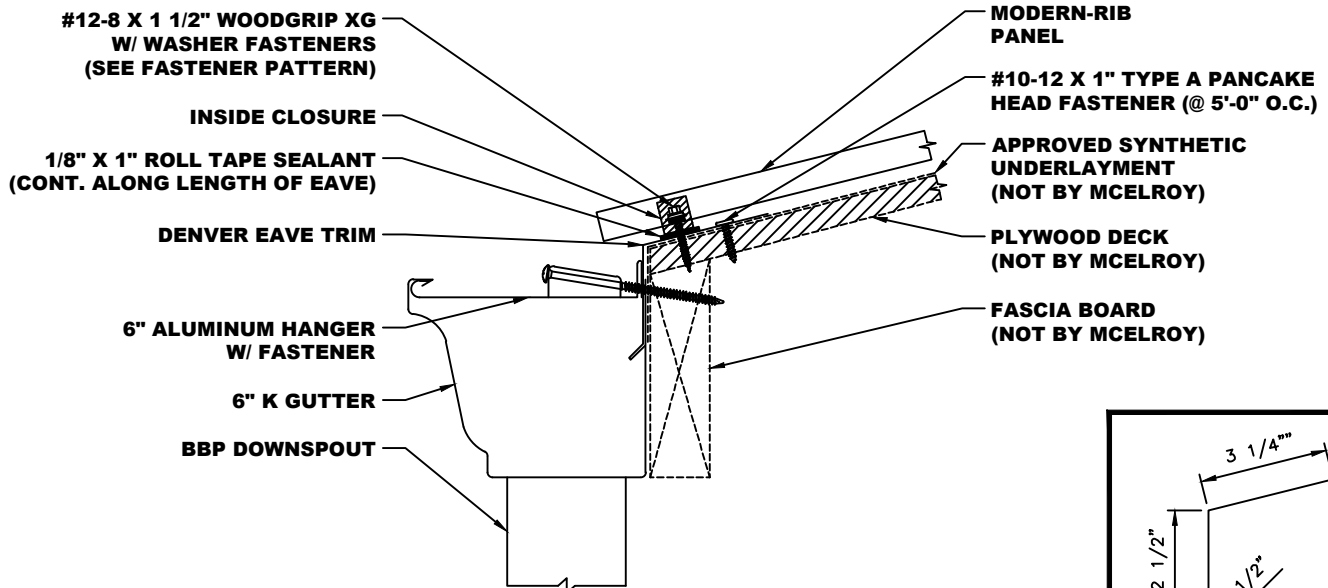

DENVER EAVE TRIM

- NOTES:** 1. Attach Denver Eave Trim to Decking with #10-12 x 1" Type A Pancake Head Fasteners at 5'-0" O.C.
 2. Apply a continuous bead of 1/8" x 1" Roll Tape Sealant along the length of the Eave. Set Inside Closures on Tape Sealant.
 3. Set Modern-Rib Panel in place and attach to decking with #12-8 x 1 1/2" XG Woodgrip w/ Washer Fasteners See page B-1 for Fastener Patterns.

*NOTE: SOME TRIM ITEMS AND FASTENERS HAVE BEEN REMOVED FOR CLARITY OF ISOMETRIC DETAIL.

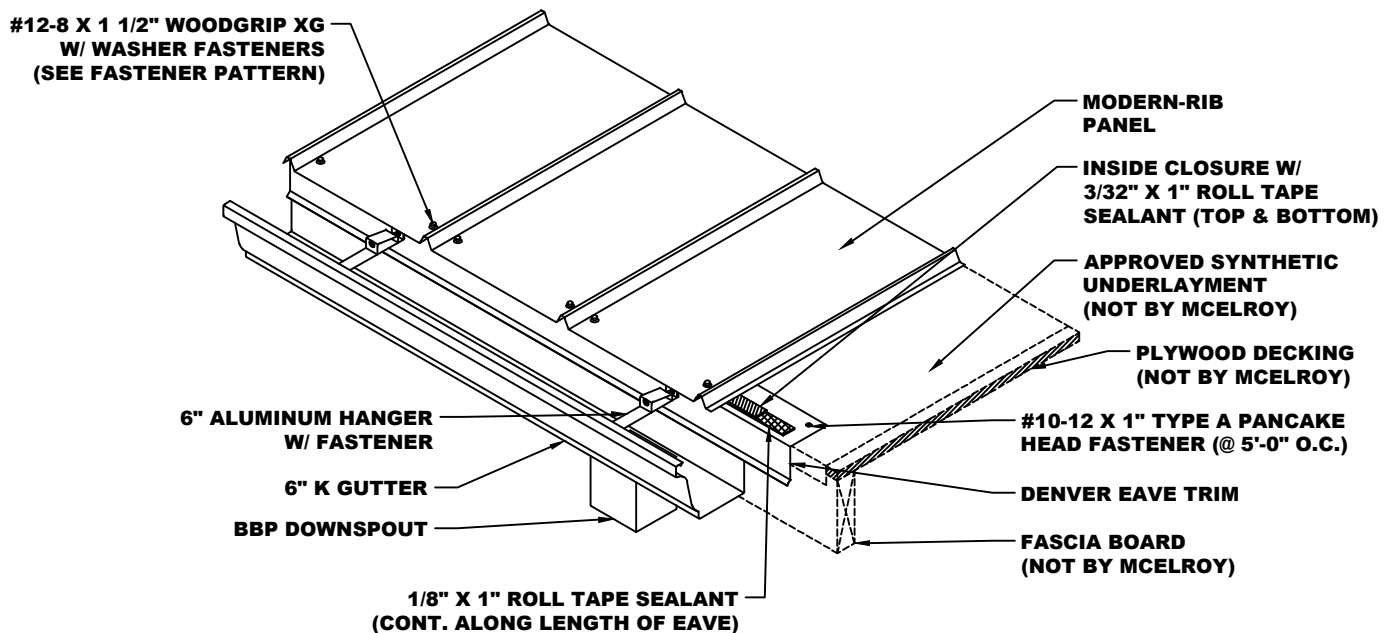

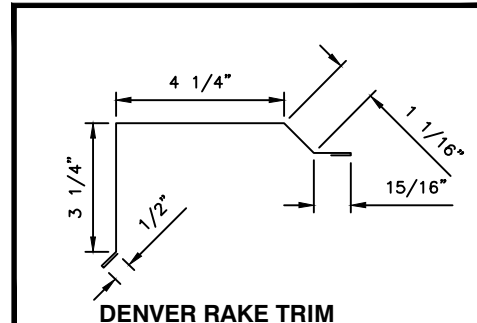
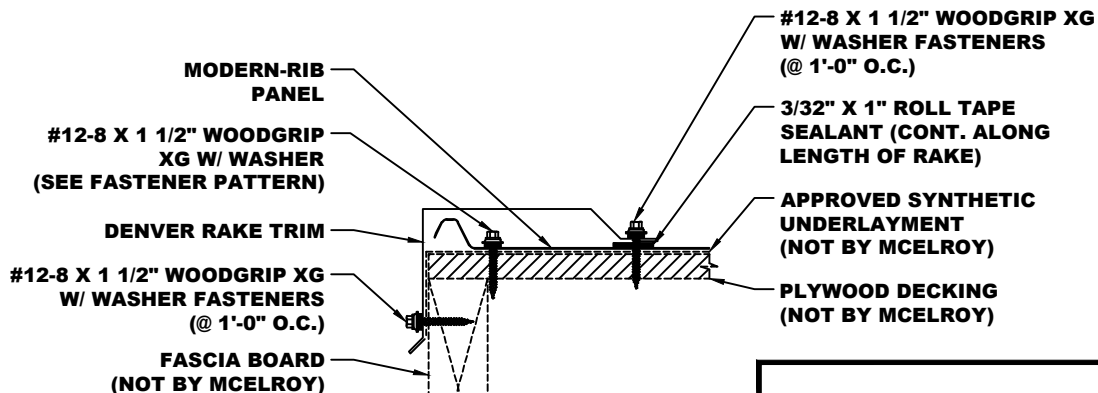

- NOTES:**
1. After completing all the Eave Detail requirements, install the Modern-Rib Panel with #12-8 x 1 1/2" Woodgrip XG w/ Washer Fasteners per the required fastener spacing and pattern.
 2. Apply a continuous bead of 3/32" x 1" Roll Tape Sealant along the length of the Denver Rake Trim and then place the Denver Rake Trim in position as shown and attach with #12-8 x 1 1/2" Woodgrip XG w/ Washer Fasteners at 1'-0" O.C. making sure the fastener goes thru the Tape Sealant.
 3. Attach the Denver Rake Trim to the Fascia Board with #12-8 x 1 1/2" Woodgrip XG w/ Washer Fasteners at 1'-0" O.C.

*NOTE: SOME TRIM ITEMS AND FASTENERS HAVE BEEN REMOVED FOR CLARITY OF ISOMETRIC DETAIL.

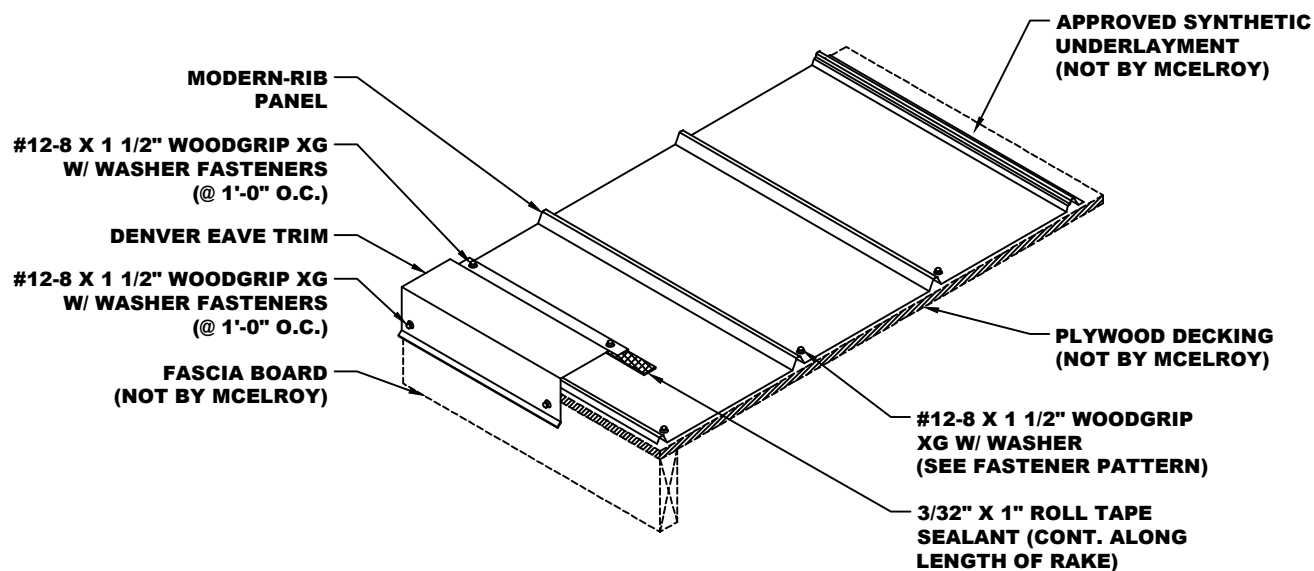

MODERN-RIB DENVER RAKE TRIM DETAIL (OFF-MODULE)

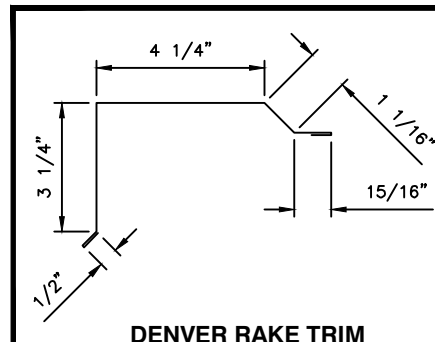
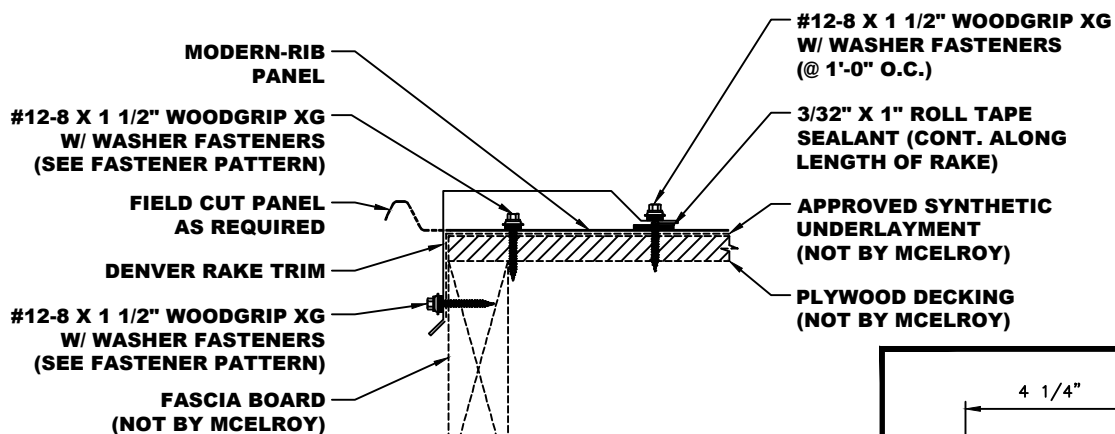

- NOTES:**
1. After completing all the Eave Detail requirements, Field Cut as required and install the Modern-Rib Panel with #12-8 x 1 1/2" Woodgrip XG w/ Washer Fasteners per the required fastener spacing and pattern.
 2. Apply a continuous bead of 3/32" x 1" Roll Tape Sealant along the length of the Denver Rake Trim and then place the Denver Rake Trim in position as shown and attach with #12-8 x 1 1/2" Woodgrip XG w/ Washer Fasteners at 1'-0" O.C. making sure the fastener goes thru the Tape Sealant.
 3. Attach the Denver Rake Trim to the Fascia Board with #12-8 x 1 1/2" Woodgrip XG w/ Washer Fasteners at 1'-0" O.C.

*NOTE: SOME TRIM ITEMS AND FASTENERS HAVE BEEN REMOVED FOR CLARITY OF ISOMETRIC DETAIL.

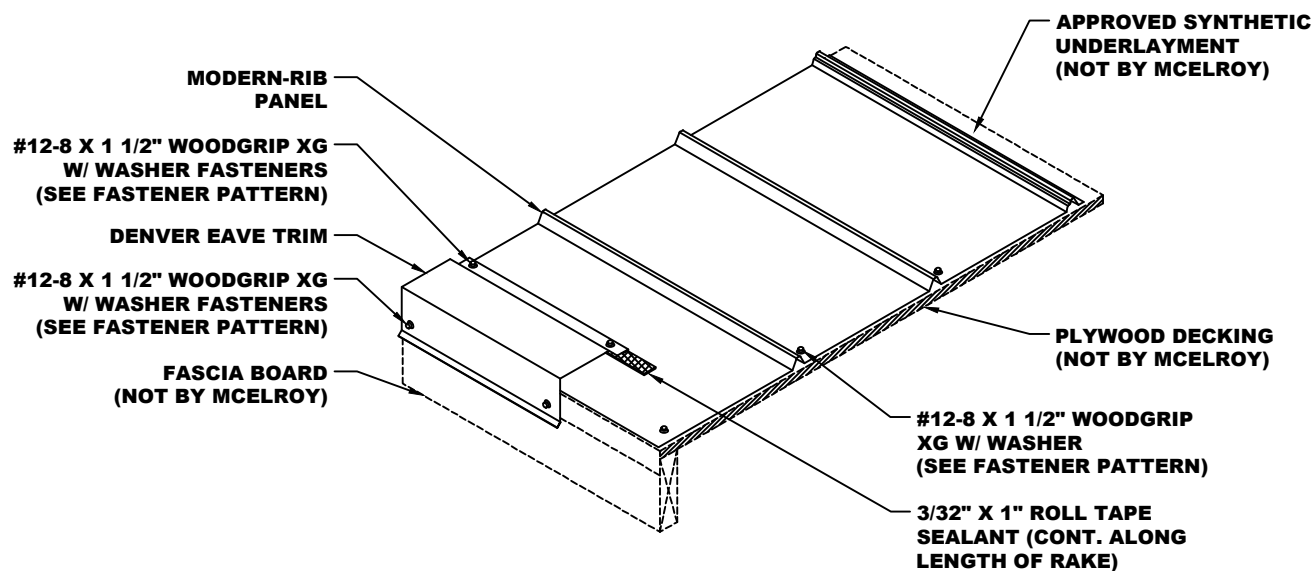

MODERN-RIB STEP RAKE TIE-IN / SIDEWALL TRIM DETAIL

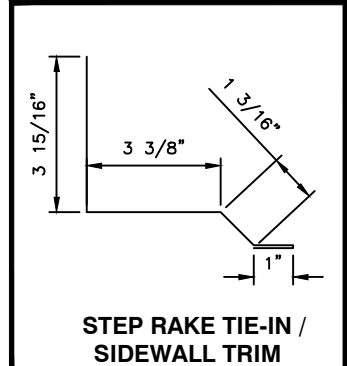
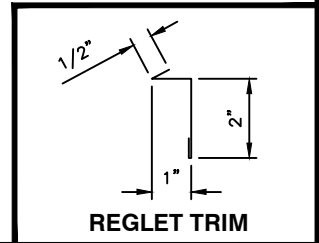
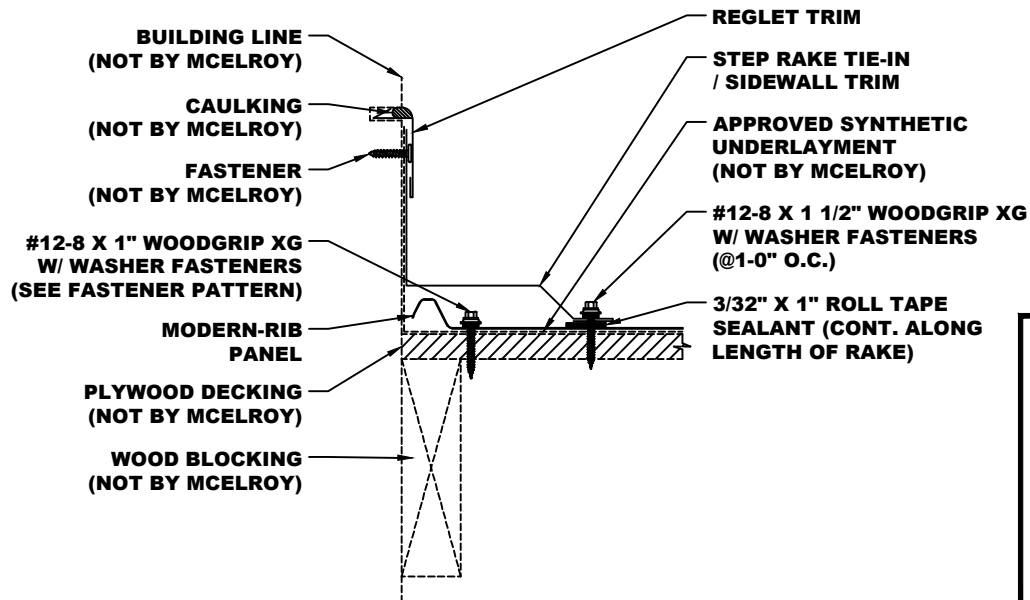

- NOTES:**
1. After completing all the Eave Detail requirements, install the Modern-Rib Panel with #12-8 x 1 1/2" Woodgrip XG w/ Washer Fasteners per the required fastener spacing and pattern.
 2. Apply a continuous bead of 3/32" x 1" Roll Tape Sealant along the length of the Step Rake Trim Tie-In / Sidewall Trim and then place in position as shown and attach with #12-8 x 1 1/2" Woodgrip XG w/ Washer Fasteners at 1'-0" O.C. making sure the fastener goes thru the Tape Sealant.
 3. Attach the Step Rake Tie-In / Sidewall Trim to the sidewall with fastener (not by McElroy) at spacing required.

*NOTE: SOME TRIM ITEMS AND FASTENERS HAVE BEEN REMOVED FOR CLARITY OF ISOMETRIC DETAIL.

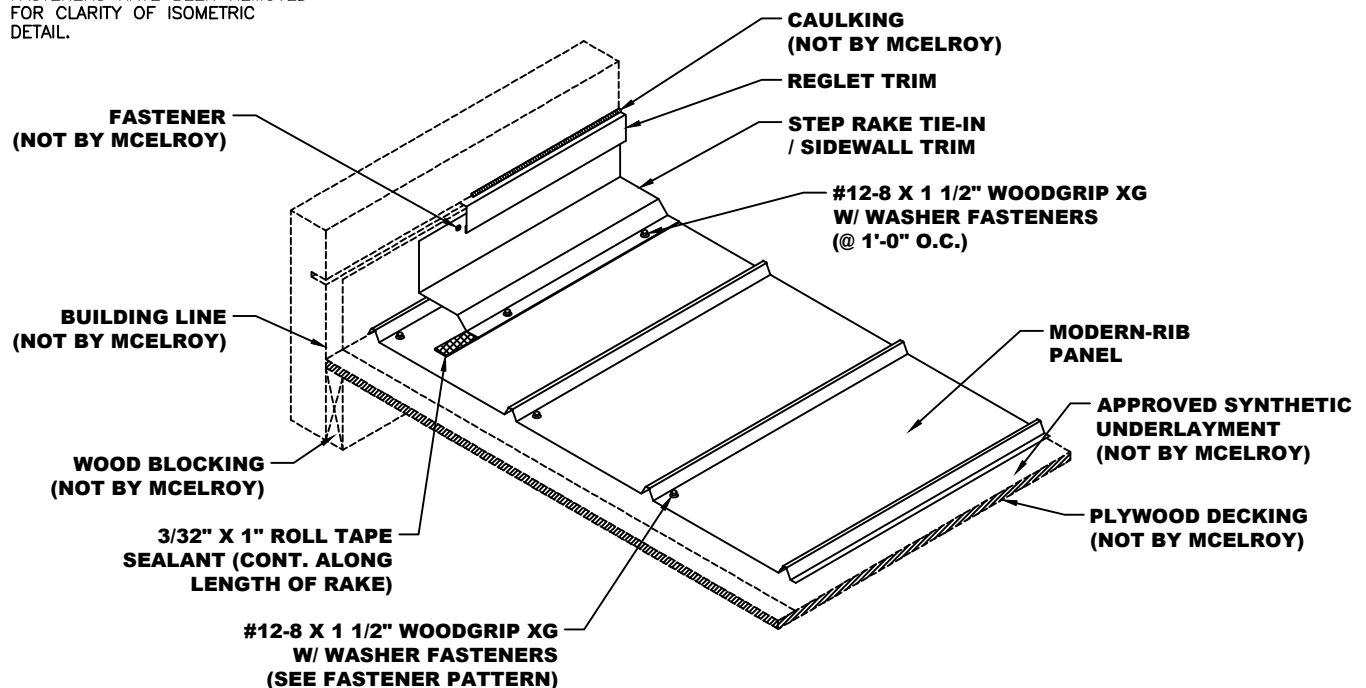

STEP RAKE TIE-IN / SIDEWALL TRIM DETAIL (OFF MODULE)

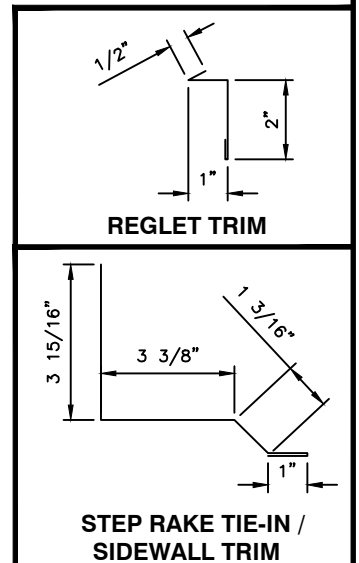
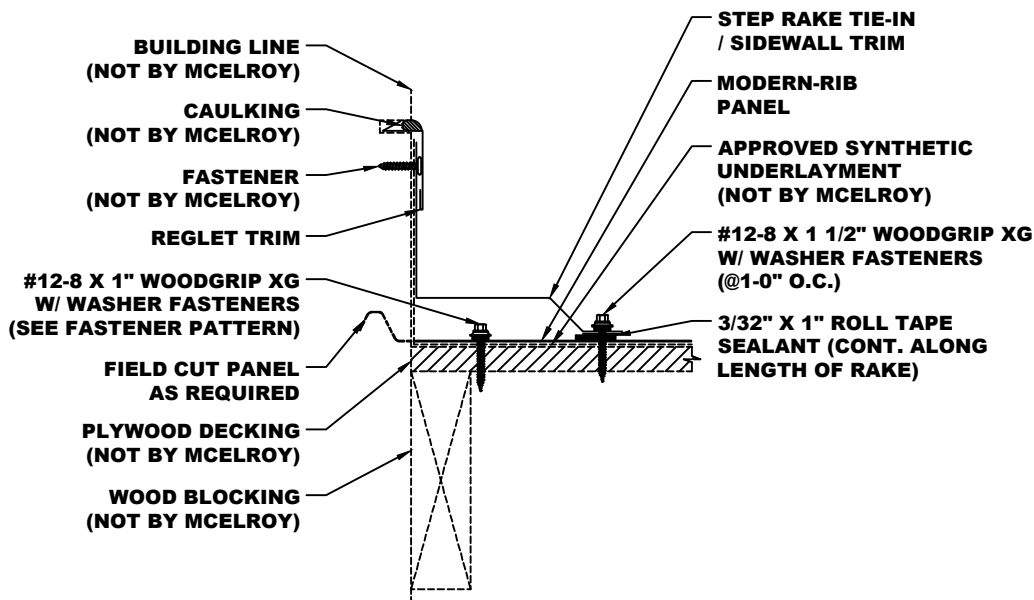

- NOTES:**
1. After completing all the Eave Detail requirements, field cut and install the Modern-Rib Panel with #12-8 x 1 1/2" Woodgrip XG w/ Washer Fasteners per the required fastener spacing and pattern.
 2. Apply a continuous bead of 3/32" x 1" Roll Tape Sealant along the length of the Step Rake Trim Tie-In / Sidewall Trim and then place in position as shown and attach with #12-8 x 1 1/2" Woodgrip XG w/ Washer Fasteners at 1'-0" O.C. making sure the fastener goes thru the Tape Sealant.
 3. Attach the Step Rake Tie-In / Sidewall Trim to the sidewall with fastener (not by McElroy) at spacing required.

*NOTE: SOME TRIM ITEMS AND FASTENERS HAVE BEEN REMOVED FOR CLARITY OF ISOMETRIC DETAIL.

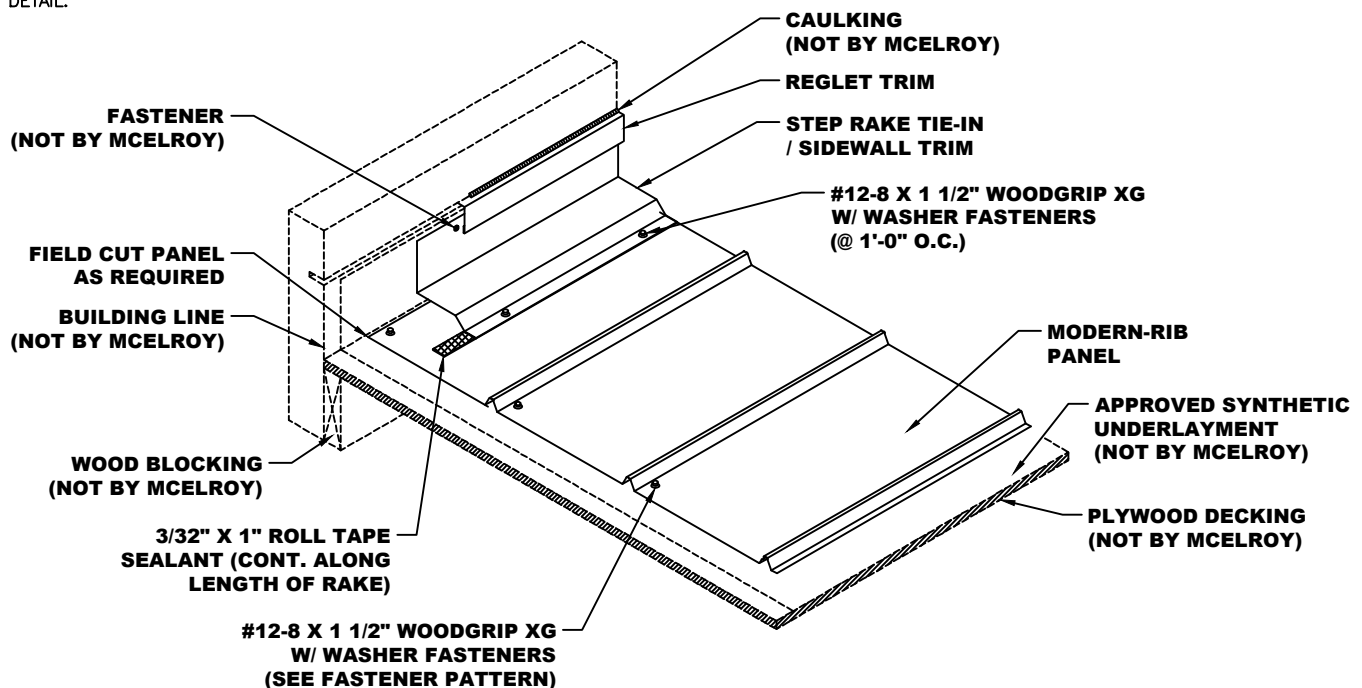

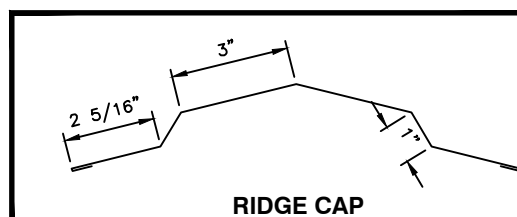
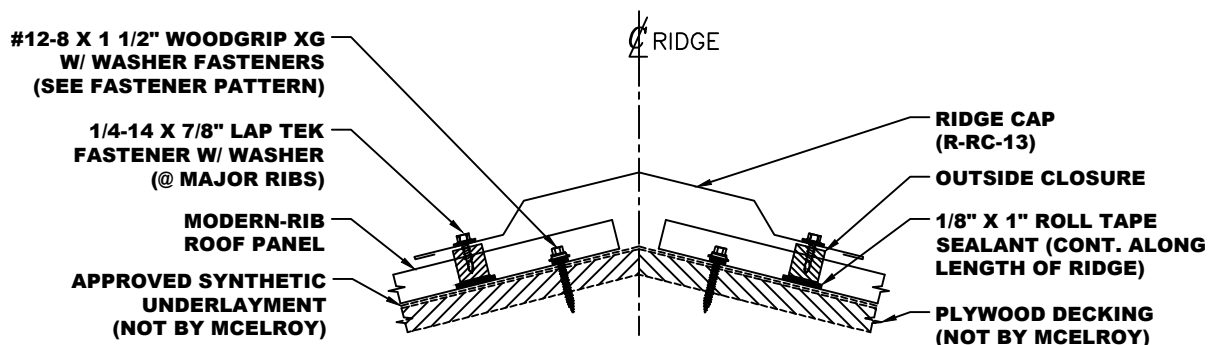

- NOTES:**
1. Install the Modern-Rib Panels 1" downhill of each side of the ridge. Attach with #12-8 x 1 1/2" Woodgrip XG w/ Washer Fastener per the required fastener spacing and pattern.
 2. Apply a continuous bead of 1/8" x 1" Roll Tape Sealant on the panels along the length of the ridge and then place Outside Closure in sealant.
 3. Attach the Ridge Cap as shown with 1/4-14 x 7/8" Lap Tek Fasteners w/ Washer to each major rib of the Modern-Rib Panel.

*NOTE: SOME TRIM ITEMS AND FASTENERS HAVE BEEN REMOVED FOR CLARITY OF ISOMETRIC DETAIL.

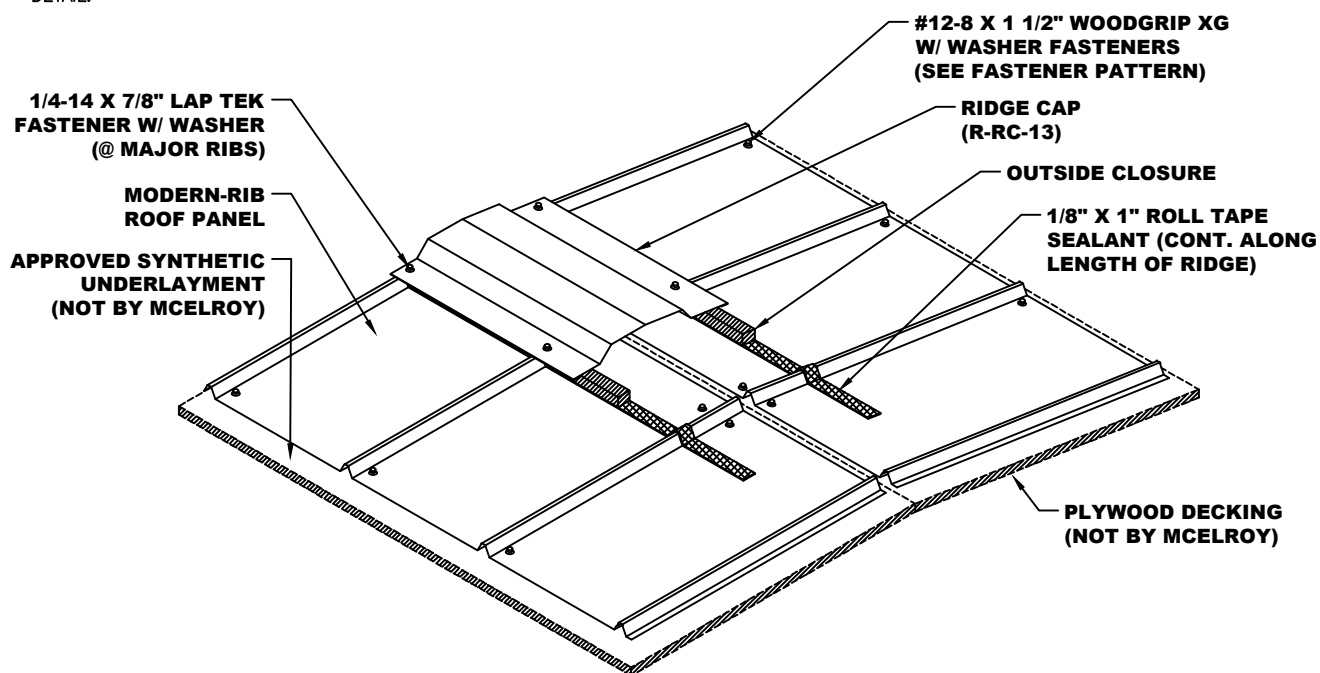

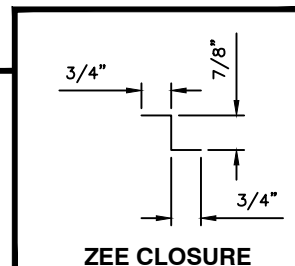
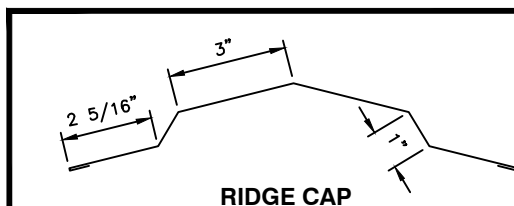
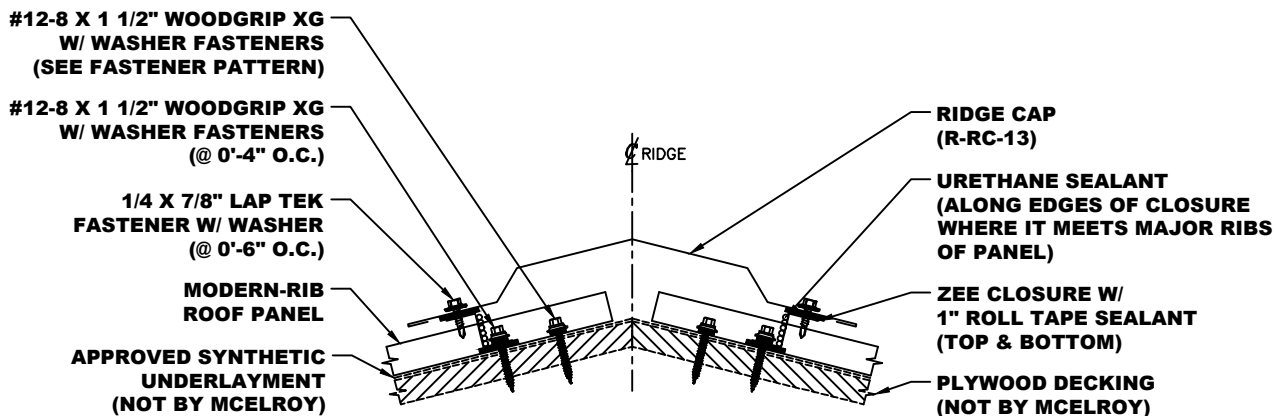

- NOTES:**
1. Install the Modern-Rib Panels 1" downhill of each side of the ridge. Attach with #12-8 x 1 1/2" Woodgrip XG w/ Washer Fasteners per the required fastener spacing and pattern.
 2. Cut Zee Closure to fit Modern-Rib Panel and apply 1" Roll Tape Sealant to the top and bottom flanges of the Zee Closure and attach with #12-8 x 1 1/2" Woodgrip XG w/ Washers Fasteners at 4" O.C.
 3. Apply a bead of Urethane Sealant along the edges of the Zee Closures where it meets the major ribs of the panel.
 4. Attach the Ridge Cap as shown with 1/4-14 x 7/8" Lap Tek Fasteners w/ Washer to the Zee Closure at 6" O.C.

*NOTE: SOME TRIM ITEMS AND FASTENERS HAVE BEEN REMOVED FOR CLARITY OF ISOMETRIC DETAIL.

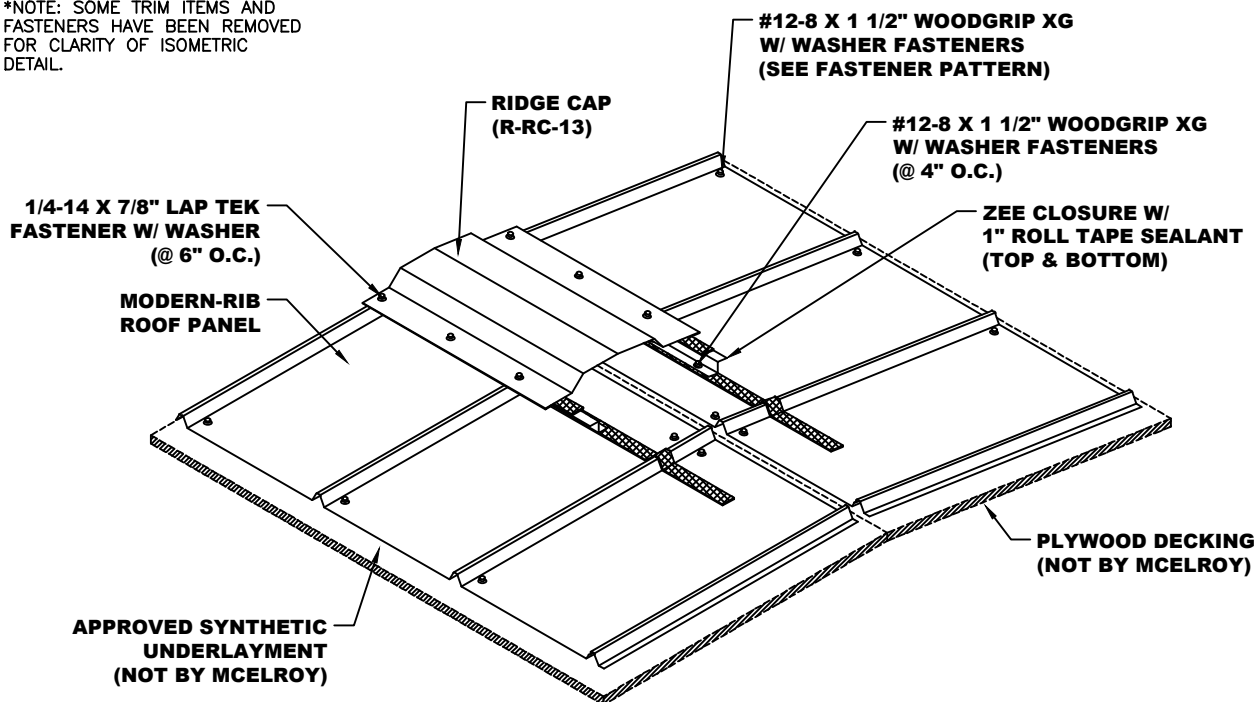

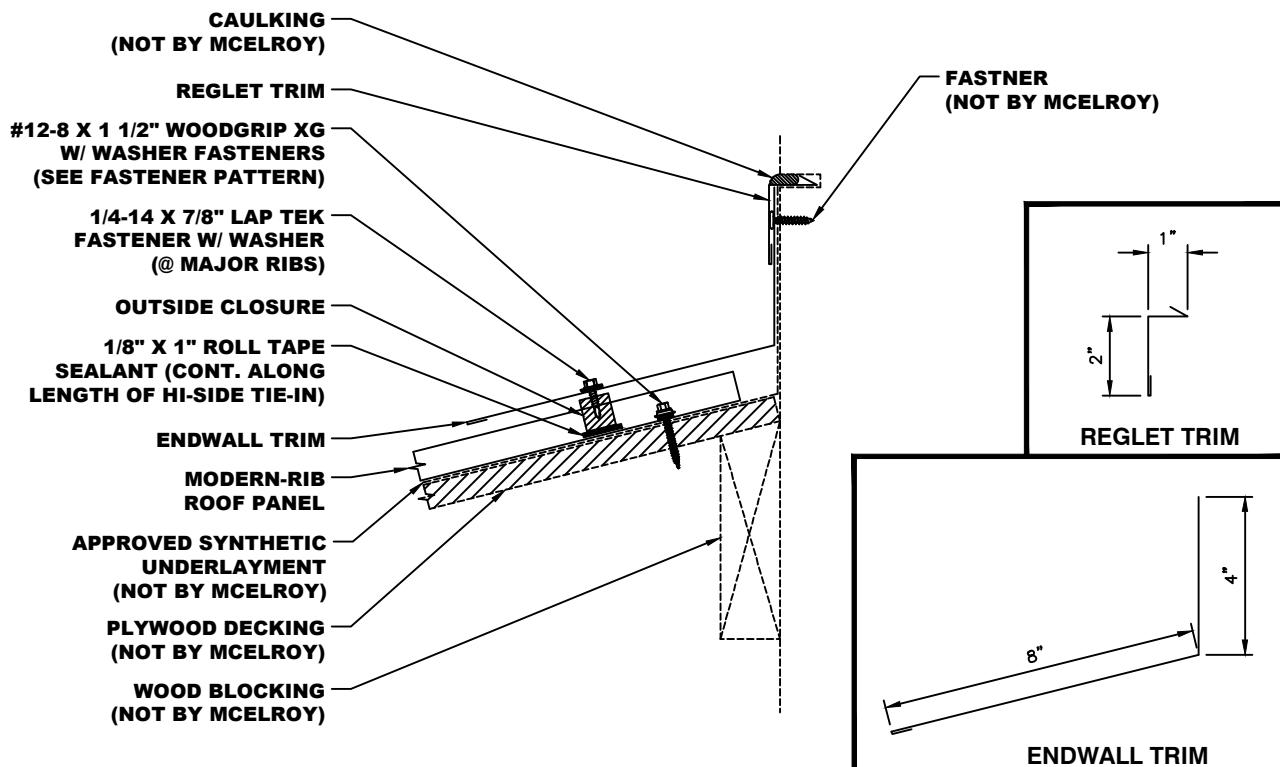

- NOTES:** 1. Install the Modern-Rib Panels 1" downhill of each side of the ridge. Attach with #12-8 x 1 1/2" Woodgrip XG w/ Washer Fasteners per the required fastener spacing and pattern.
2. Apply a continuous bead of 1/8" x 1" Roll Tape Sealant on the panels along the length of the Hi-Side Tie-In and then place Outside Closure in sealant.
3. Attach the Endwall Trim as shown with 1/4-14 x 7/8" Lap Tek w/ Washer Fasteners to each major rib of the Modern-Rib Panel.

*NOTE: SOME TRIM ITEMS AND FASTENERS HAVE BEEN REMOVED FOR CLARITY OF ISOMETRIC DETAIL.

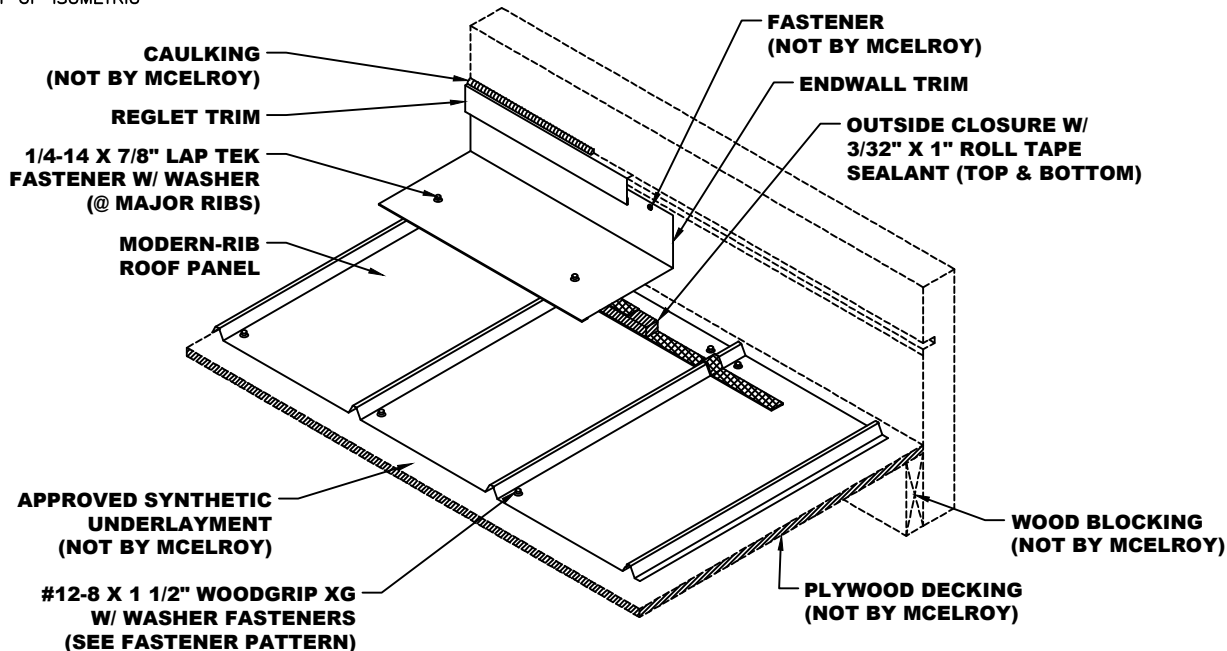

HI-SIDE TIE-IN / ENDWALL w/ ZEE CLOSURE DETAIL

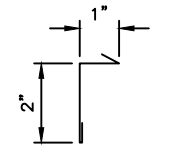
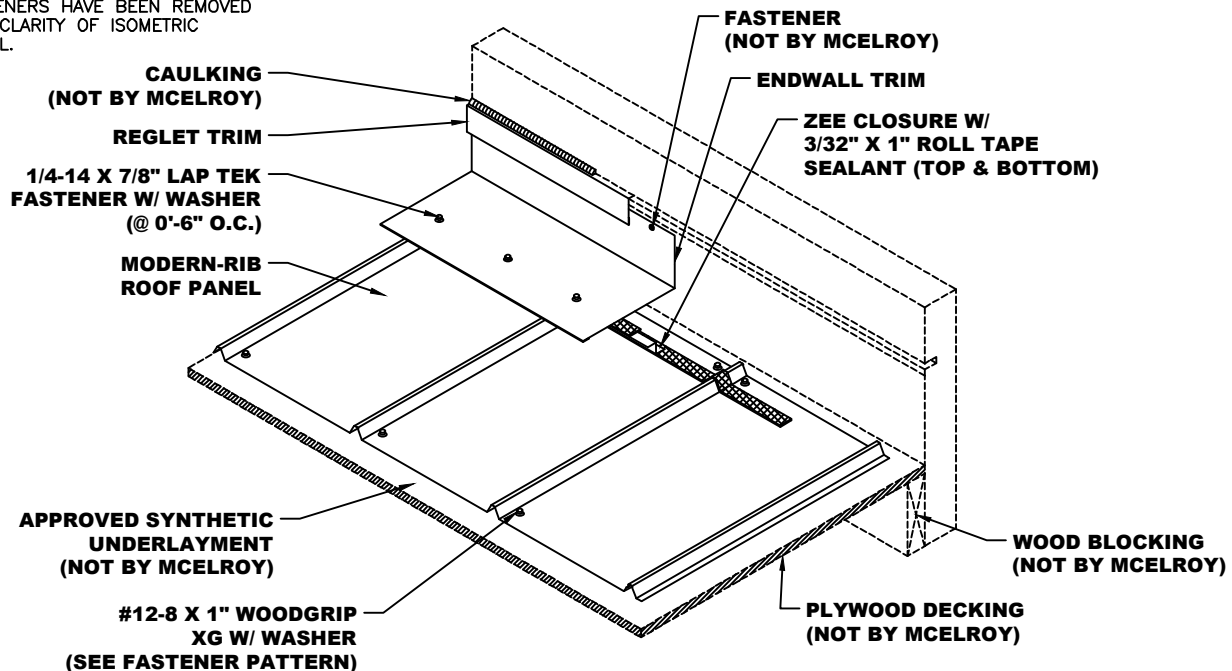
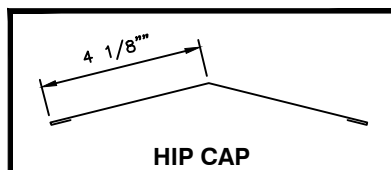
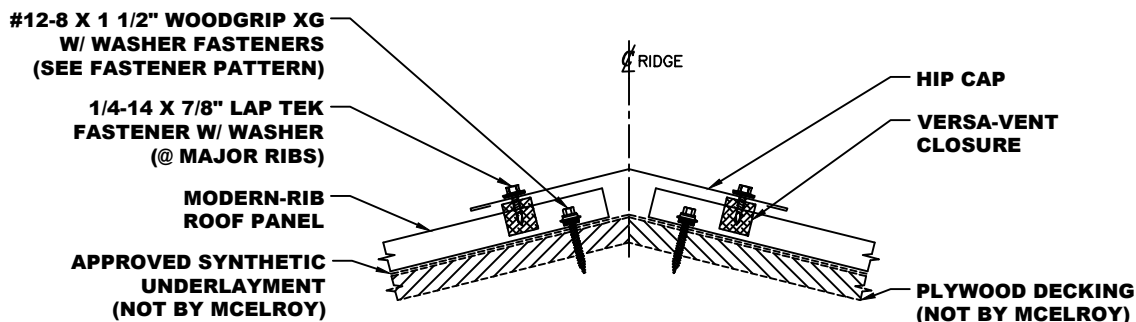

Diagram of a Tee section with dimensions: flange width $3/4"$, web height $7/8"$, and flange thickness $3/4"$.

ENDWALL TRIM

- *NOTE: SOME TRIM ITEMS AND FASTENERS HAVE BEEN REMOVED FOR CLARITY OF ISOMETRIC DETAIL.





- NOTES:**
1. Install the Modern-Rib Panels 1" downhill of each side of the ridge. Attach with #12-8 x 1 1/2" Woodgrip XG w/ Washer Fasteners per the required fastener spacing and pattern.
 2. Locate Hip Cap and turn over to expose the underside. Locate Versa-Vent Closure and roll off amount needed to cover length of Hip Cap up one side and down the other side of the trim. Remove protective paper to expose adhesive and stick Versa-Vent to the Hip Cap. Repeat on opposite side of trim.
 3. Attach the Hip Trim as shown with 1/4-14 x 7/8" Lap Tek Fasteners w/ Washer to each major rib of the Modern-Rib Panel.

*NOTE: SOME TRIM ITEMS AND FASTENERS HAVE BEEN REMOVED FOR CLARITY OF ISOMETRIC DETAIL.

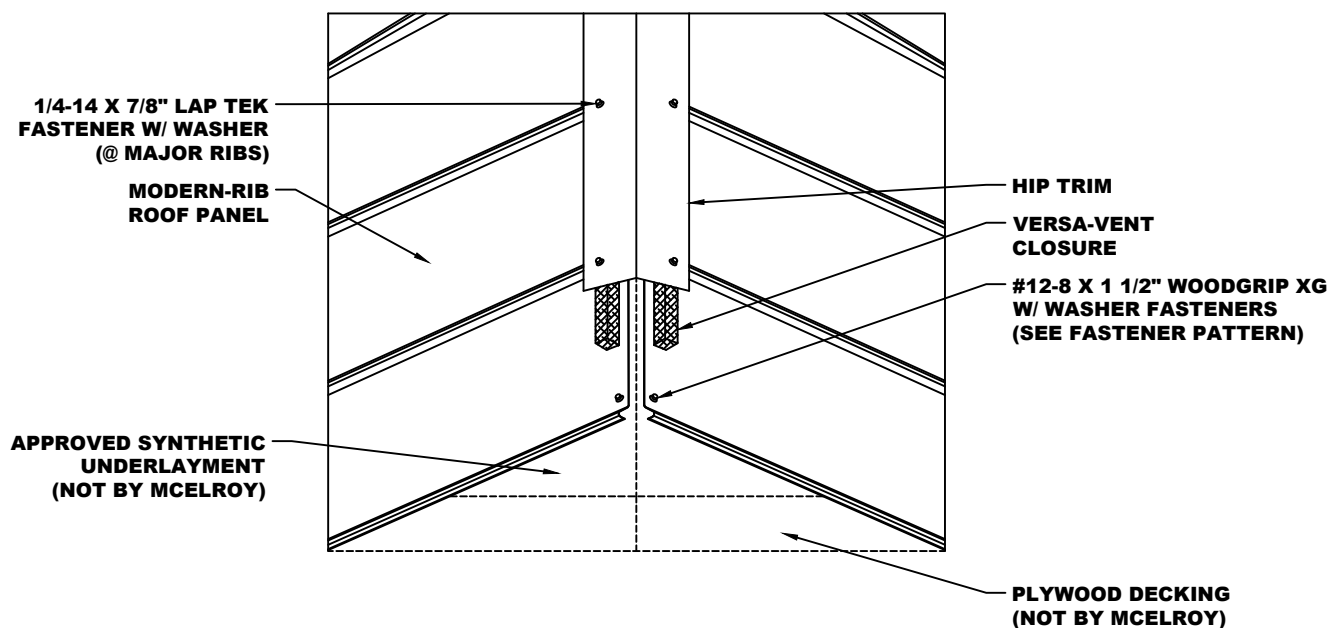

#12-8 X 1 1/2" WOODGRIP XG
W/ WASHER FASTENERS
(@ 0'-4" O.C.)

1/4-14 X 7/8" LAP TEK
FASTENER W/ WASHER
(@ 0'-6" O.C.)

MODERN-RIB
ROOF PANEL

APPROVED SYNTHETIC
UNDERLAYMENT
(NOT BY MCELROY)

RIDGE

HIP CAP

ZEE CLOSURE W/
3/32" X 1" ROLL TAPE
SEALANT (TOP & BOTTOM)

URETHANE SEALANT
(ALONG EDGES OF CLOSURE
WHERE IT MEETS MAJOR RIBS
OF PANEL)

PLYWOOD DECKING
(NOT BY MCELROY)

#12-8 X 1 1/2" WOODGRIP XG
W/ WASHER FASTENERS
(SEE FASTENER PATTERN)

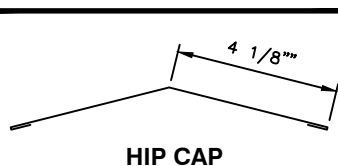
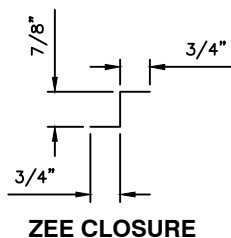

- NOTES:**
1. Install the Modern-Rib Panels 1" downhill of each side of the ridge. Attach with #12-8 x 1 1/2" Woodgrip XG w/ Washer Fasteners per the required fastener spacing and pattern.
 2. Cut Zee Closure to fit Modern-Rib Panel and apply 1" Roll Tape Sealant to the top and bottom flanges of the Zee Closure and attach with #12-8 x 1 1/2" Woodgrip XG w/ Washer Fasteners at 4" O.C.
 3. Apply a bead of Urethane Sealant along the edges of the Zee Closures where it meets the major ribs of the panel.
 4. Attach the Hip Trim as shown with 1/4-14 x 7/8" Lap Tek Fasteners w/ Washer 0'-6" O.C.

*NOTE: SOME TRIM ITEMS AND
FASTENERS HAVE BEEN REMOVED
FOR CLARITY OF ISOMETRIC
DETAIL.

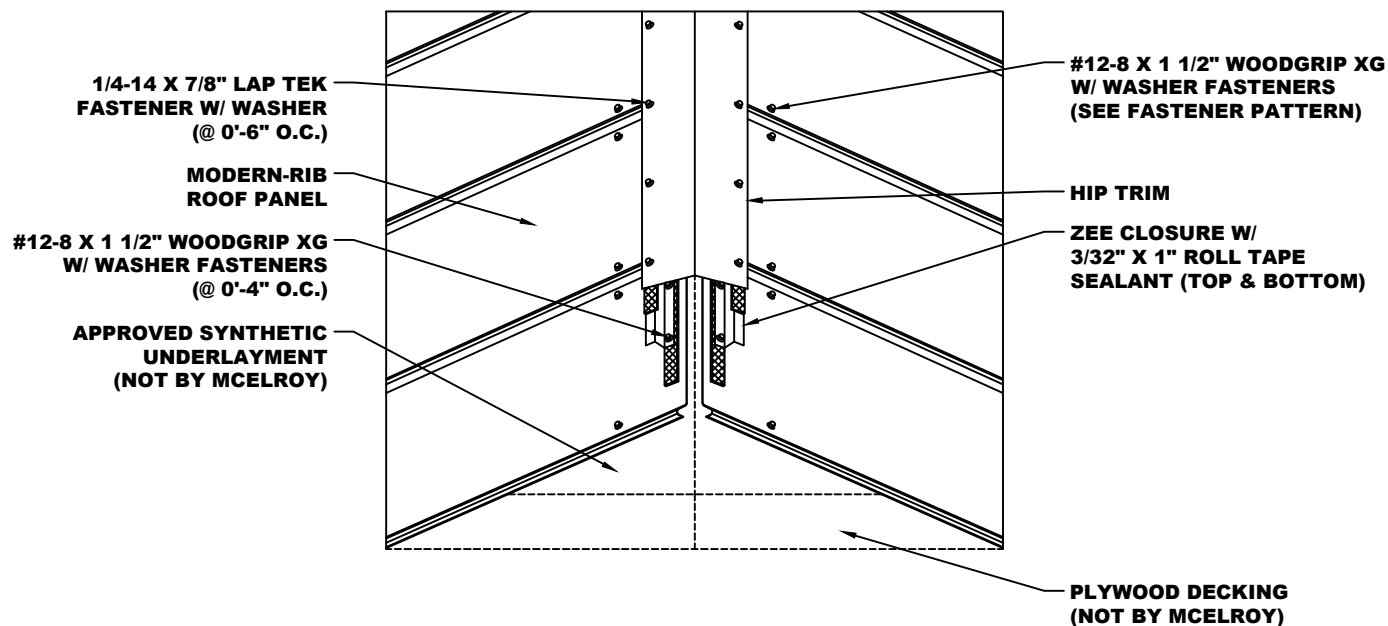

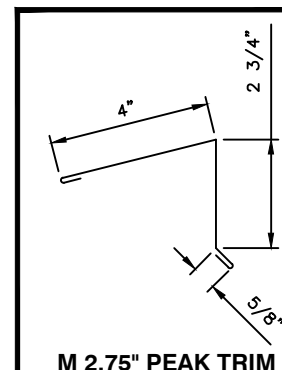
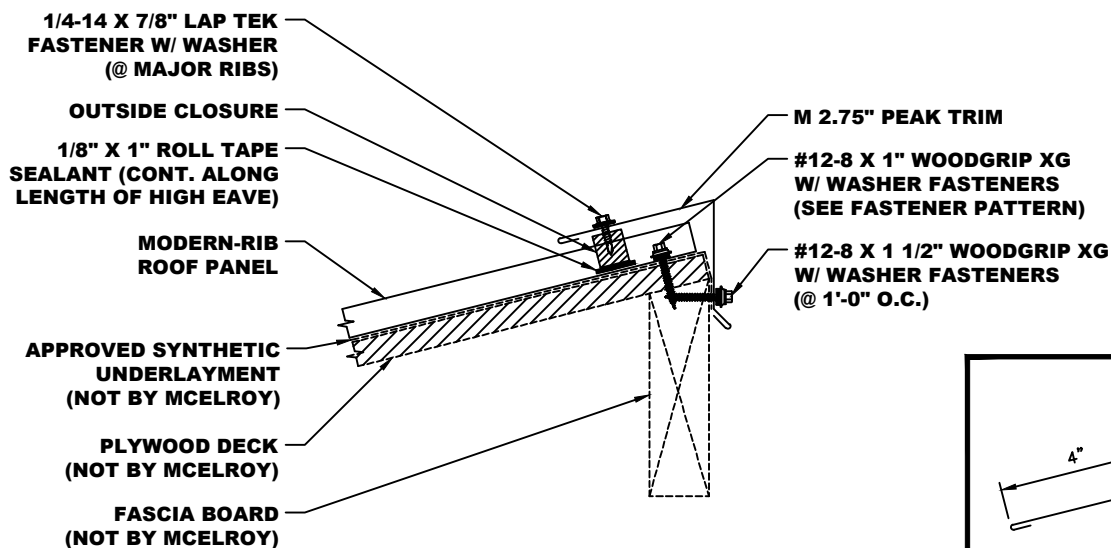

- NOTES:** 1. Install the Modern-Rib Panels 1" downhill of the high eave. Attach with #12-8 x 1 1/2" Woodgrip XG w/ Washer Fasteners per the required fastener spacing and pattern.
2. Apply a continuous bead of 1/8" x 1" Roll Tape Sealant on the panels along the length of the High Eave and then place Outside Closure in sealant.
3. Attach the M 2.75" Peak Trim as shown with #12-8 x 1 1/2" Woodgrip XG w/ Washer Fasteners to the fascia board and to each major rib of the Modern-Rib Panel with 1/4-14 x 7/8" Lap Tek w/ Washer Fasteners.

*NOTE: SOME TRIM ITEMS AND FASTENERS HAVE BEEN REMOVED FOR CLARITY OF ISOMETRIC DETAIL.

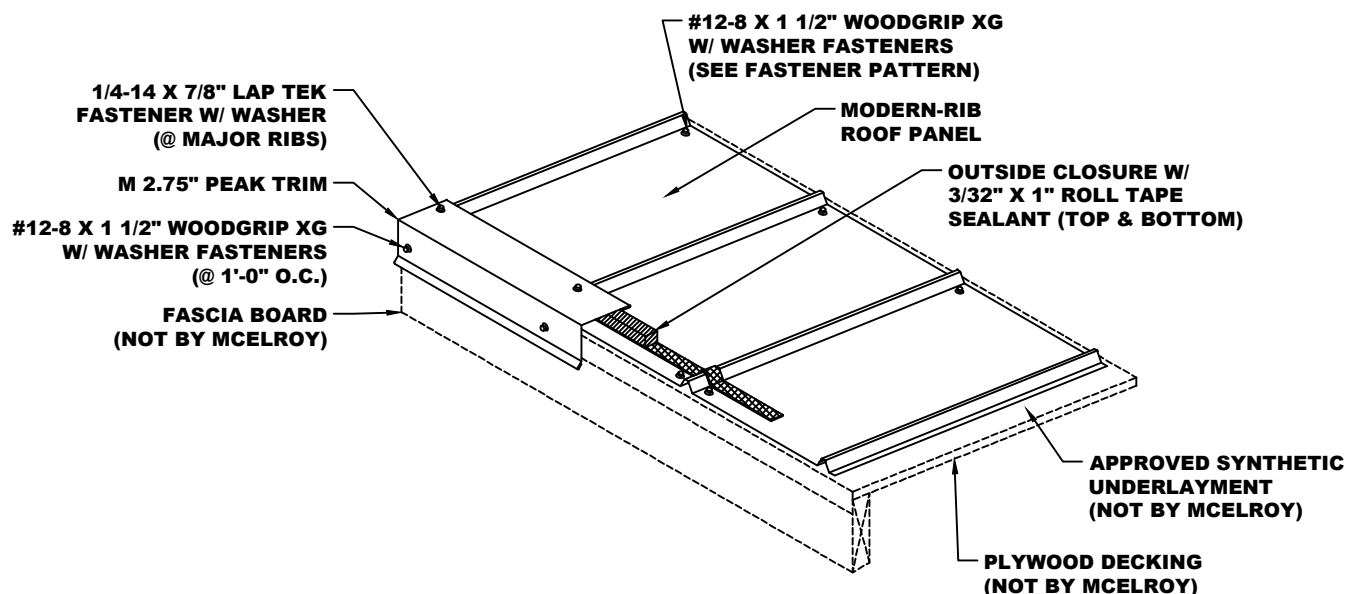

HIGH EAVE / M 2.75" PEAK TRIM w/ ZEE CLOSURE DETAIL

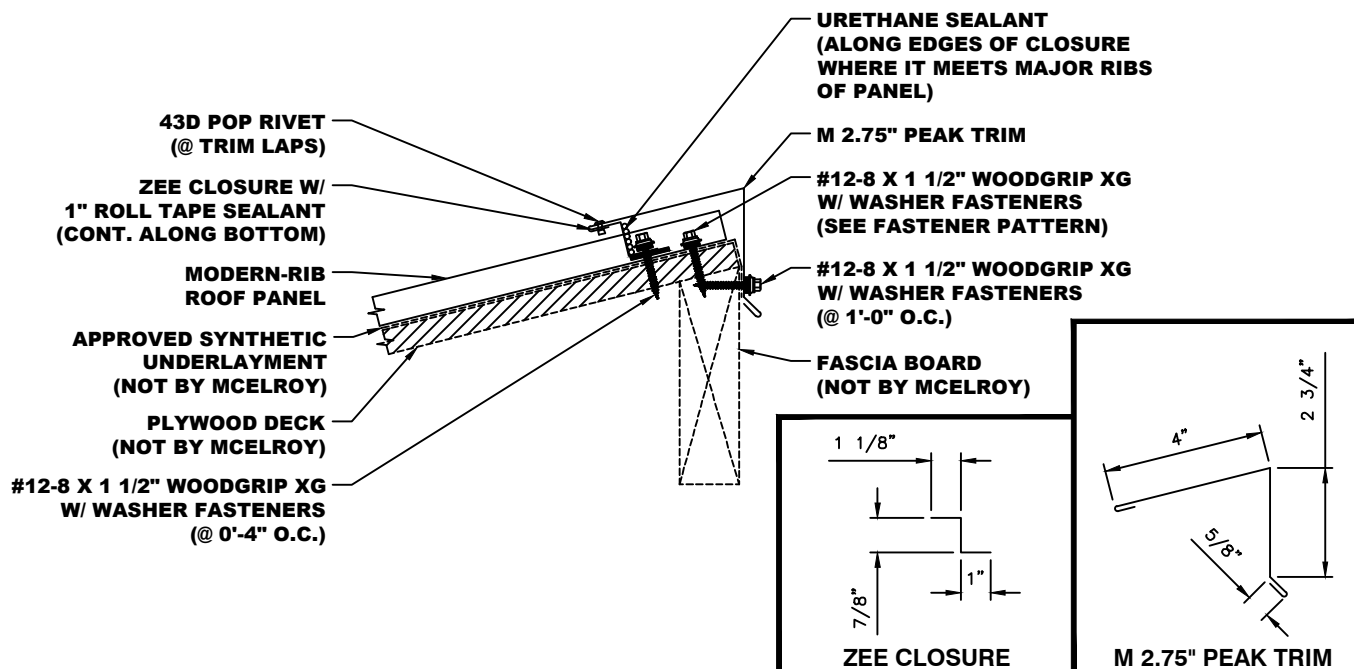

- NOTES:**
1. Install the Modern-Rib Panels 1" downhill of the high eave. Attach with #12-8 x 1 1/2" Woodgrip XG w/ Washer Fasteners per the required fastener spacing and pattern.
 2. Apply a continuous bead of 1/8" x 1" Roll Tape Sealant on the panels along the length of the High Eave
 3. Cut Zee Closure to fit Modern-Rib Panel and attach with #12-8 x 1 1/2" Woodgrip XG w/ Washer Fasteners at 4" O.C.
 4. Apply a bead of Urethane Sealant along the edges of the Zee Closures where it meets the major ribs of the panel.
 5. Attach the M 2.75" Peak Trim to the Zee Closure by hooking the open hem onto the Zee Closure flange. Then attached to the fascia board with #12-8 x 1 1/2" Woodgrip XG w/ Washer Fasteners at 1'-0" O.C. Secure the M 2.75" Peak Trim to the Zee Closure with 43D Pop Rivets at the trim laps.

*NOTE: SOME TRIM ITEMS AND FASTENERS HAVE BEEN REMOVED FOR CLARITY OF ISOMETRIC DETAIL.

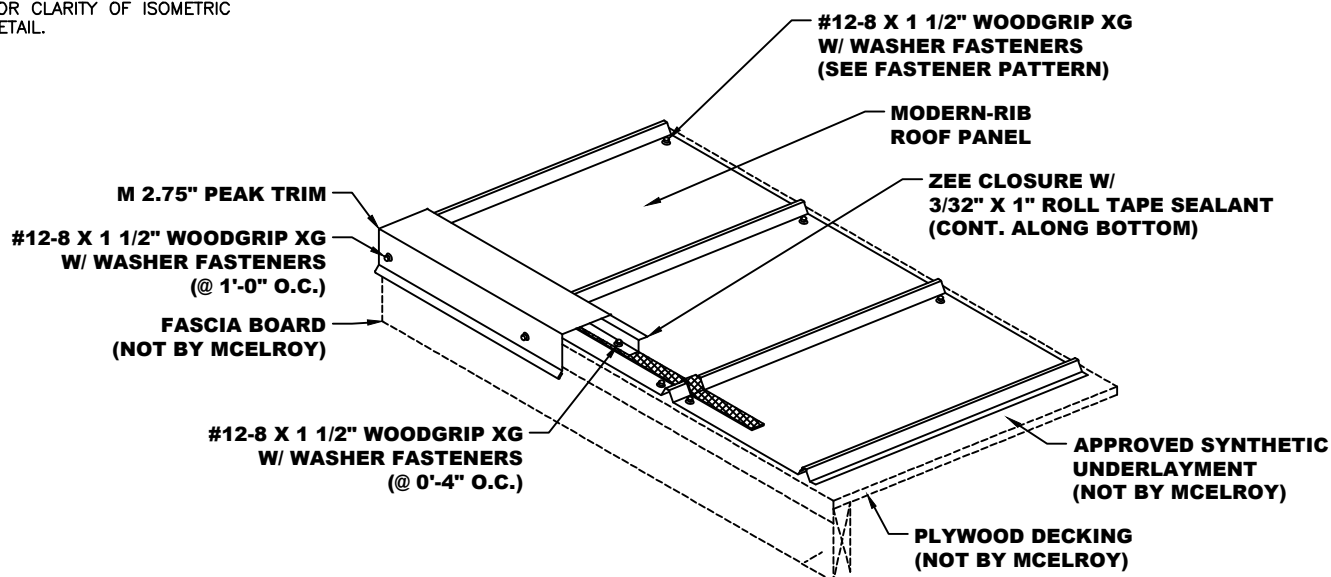

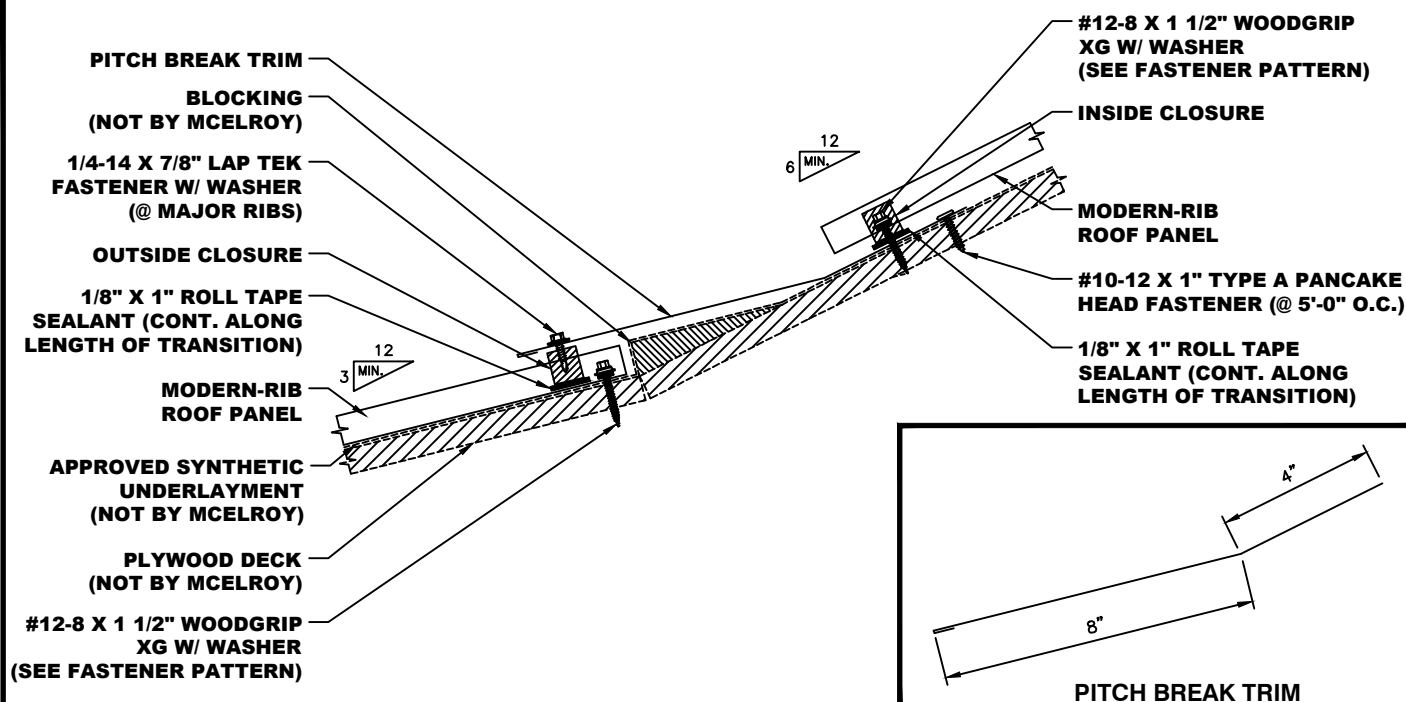

- NOTES:**
1. Install the Modern-Rib Panels 1/2" downhill of the Pitch Break. Attach with #12-8 x 1 1/2" Woodgrip XG w/ Washer Fasteners per the required fastener spacing and pattern.
 2. Apply a continuous bead of 1/8" x 1" Roll Tape Sealant on the panels along the length of the Pitch Break and then place Outside Closure in sealant.
 3. Attach the Pitch Break Trim to the major ribs of the lower Modern-Rib Panel with #9-15 x 1" and to the plywood decking above. Attach to the above plywood decking with #10-12 x 1" Type A Pancake Head Fasteners at 5'-0" O.C.
 4. Apply a continuous bead of 1/8" x 1" Roll Tape Sealant on the uphill portion of the Pitch Break Trim along the length of the transition and then place Inside Closure in sealant. Repeat the process of installing the panels.

*NOTE: SOME TRIM ITEMS AND FASTENERS HAVE BEEN REMOVED FOR CLARITY OF ISOMETRIC DETAIL.

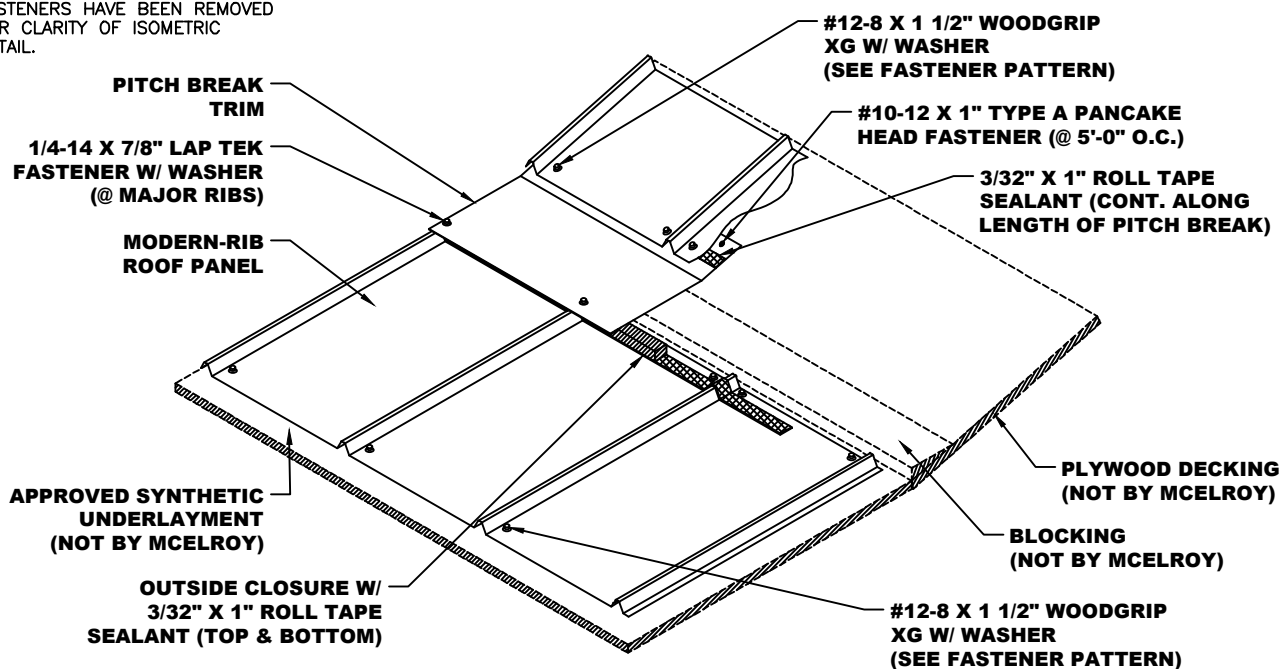

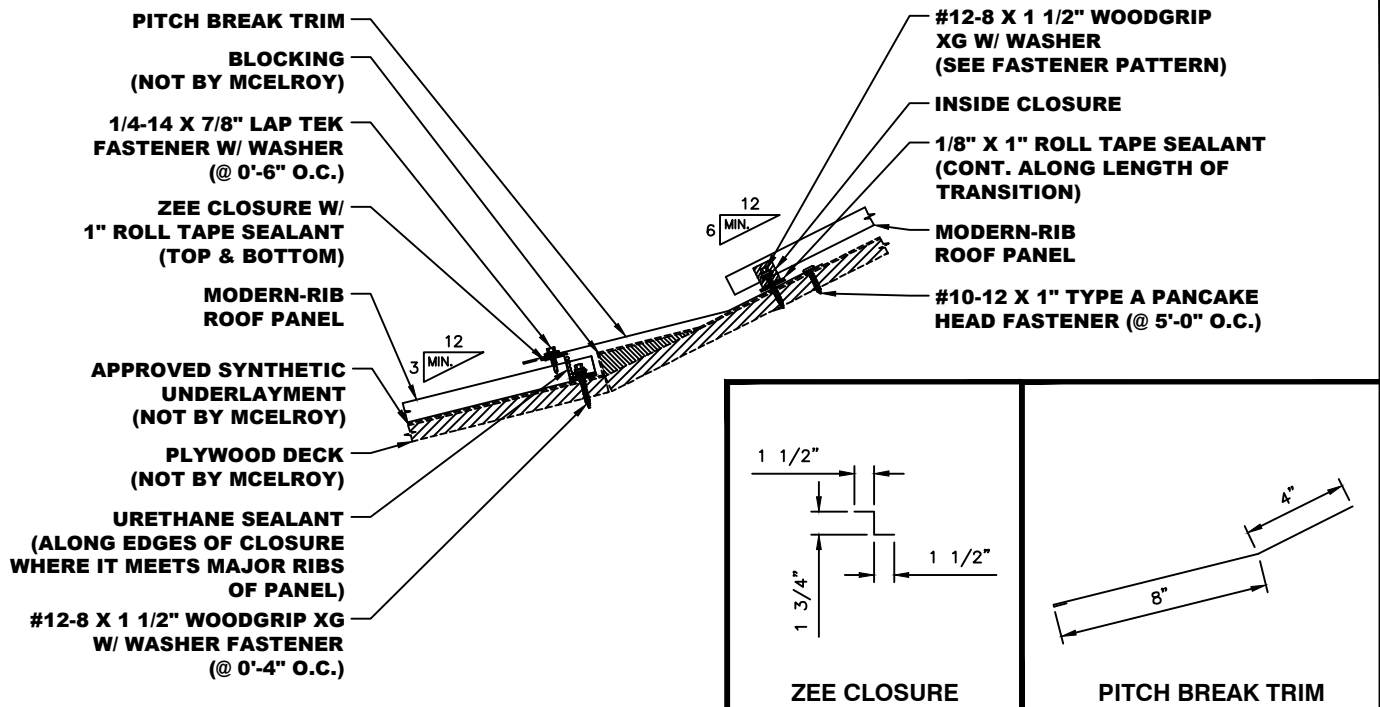

- NOTES:**
1. Install the Modern-Rib Panels 1/2" downhill of the Pitch Break. Attach with #12-8 x 1 1/2" Woodgrip XG w/ Washer Fasteners per the required fastener spacing and pattern.
 2. After cutting your Zee Closure to the required lengths, apply 1/8" x 1" Roll Tape Sealant to the bottom flange of the Zee Closure and set in place. Attach with #12-8 x 1 1/2" Woodgrip XG w/ Washer fasteners at 4" O.C.
 3. Apply a bead of Urethane Sealant along the edges of the Zee Closures where it meets the major ribs of the panel.
 4. Attach the Pitch Break Trim to the Zee Closures with 1/4-14 x 7/8" Lap Tek Fasteners w/ Washers and to the plywood decking above. Attach to the above plywood decking with #10-12 x 1" Type A Pancake Head Fasteners at 5'-0" O.C.
 5. Apply a continuous bead of 1/8" x 1" Roll Tape Sealant on the uphill portion of the Pitch Break Trim along the length of the transition and then place Inside Closure in sealant. Repeat the process of installing the panels.

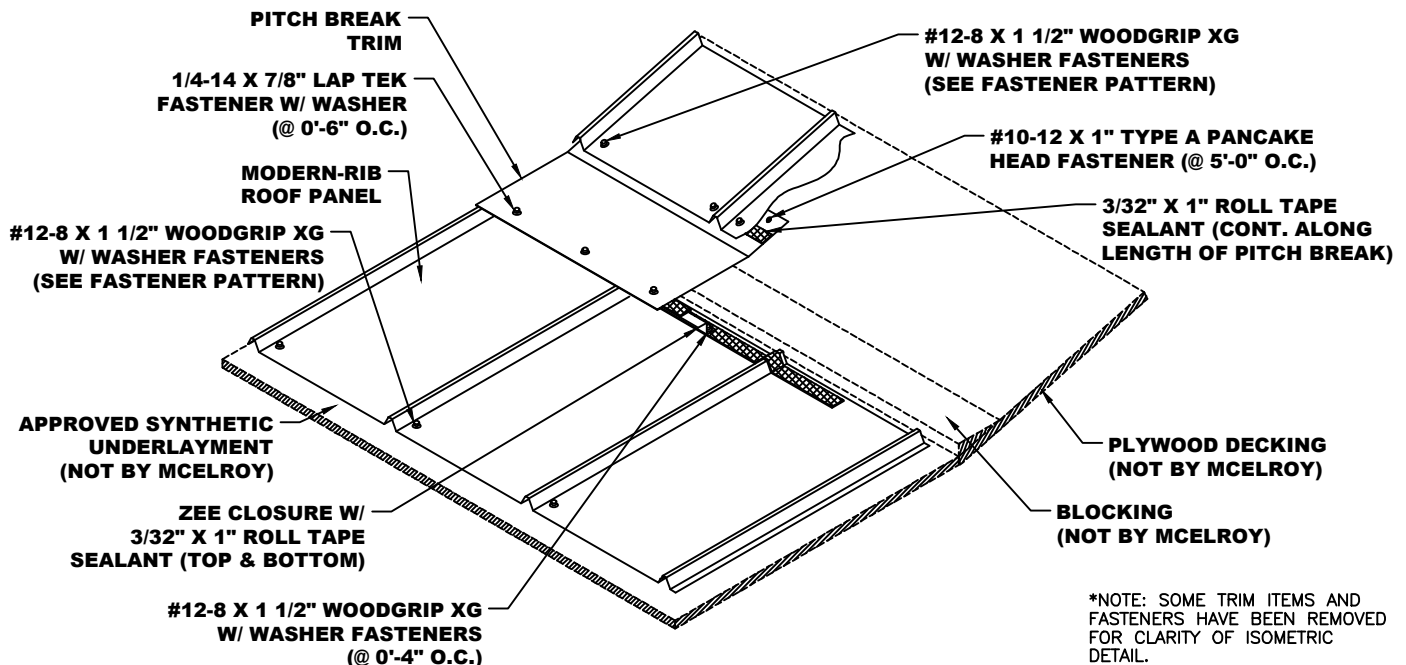

*NOTE: SOME TRIM ITEMS AND FASTENERS HAVE BEEN REMOVED FOR CLARITY OF ISOMETRIC DETAIL.

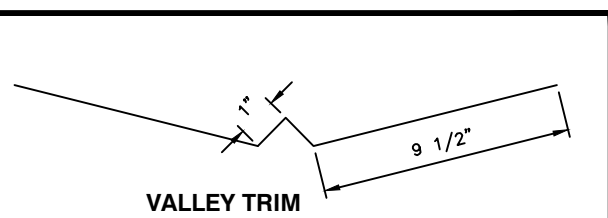
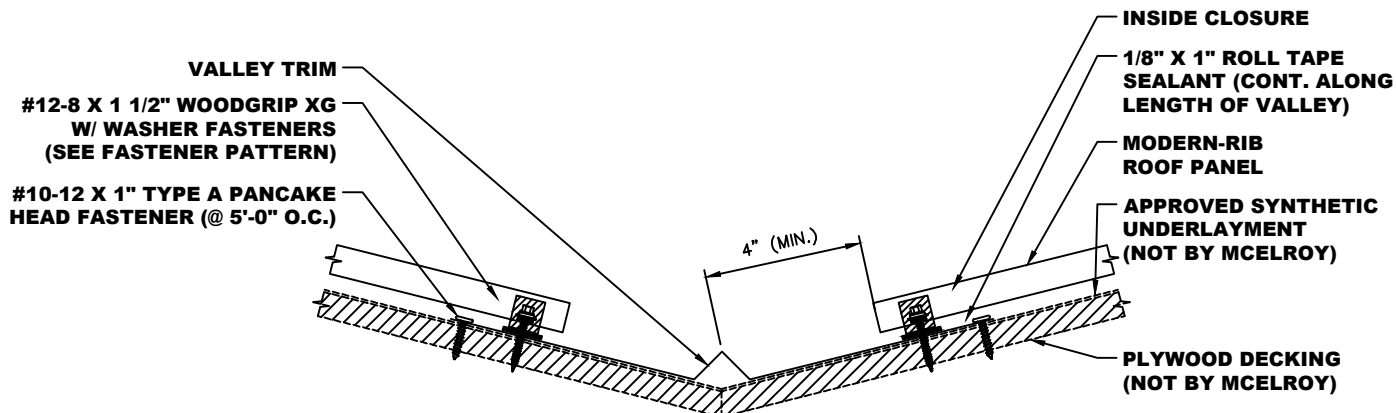

- NOTES:**
1. Install the Valley Trim as shown and attach with #10-12 x 1" Type A Pancake Head Fasteners at 5'-0" O.C.
 2. Apply a continuous bead of 1" Tape Sealant to the Valley Trim. Then set the Inside Closures onto the tape sealant.
 3. Field cut the Modern-Rib Panels to the correct valley angle and set in place as shown. Attach with #12-8 x 1 1/2" Woodgrip XG w/ Washer Fasteners per the fastener pattern.

*NOTE: SOME TRIM ITEMS AND FASTENERS HAVE BEEN REMOVED FOR CLARITY OF ISOMETRIC DETAIL.

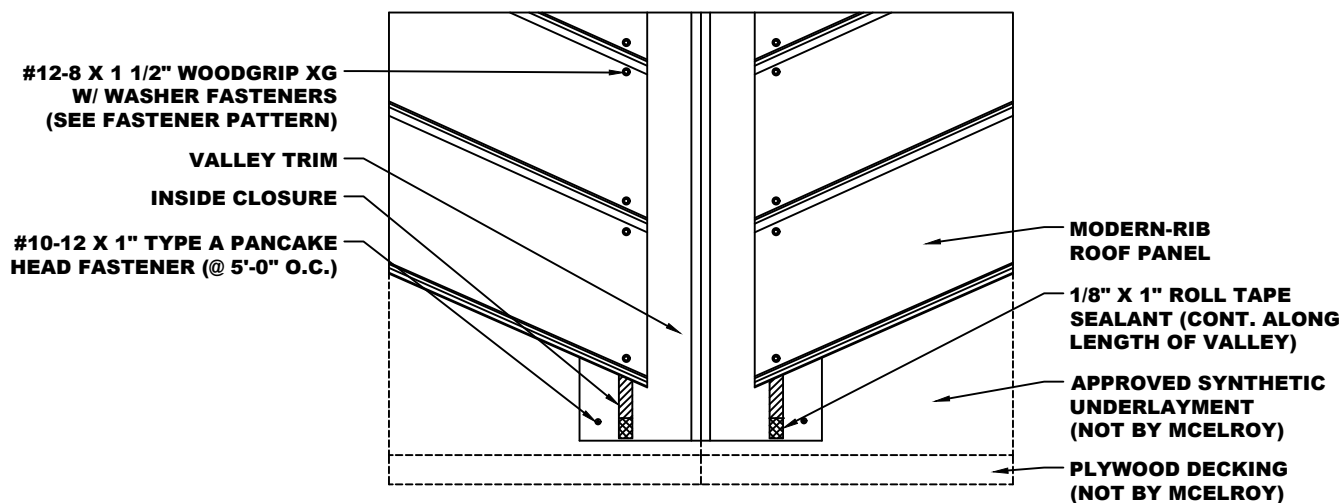

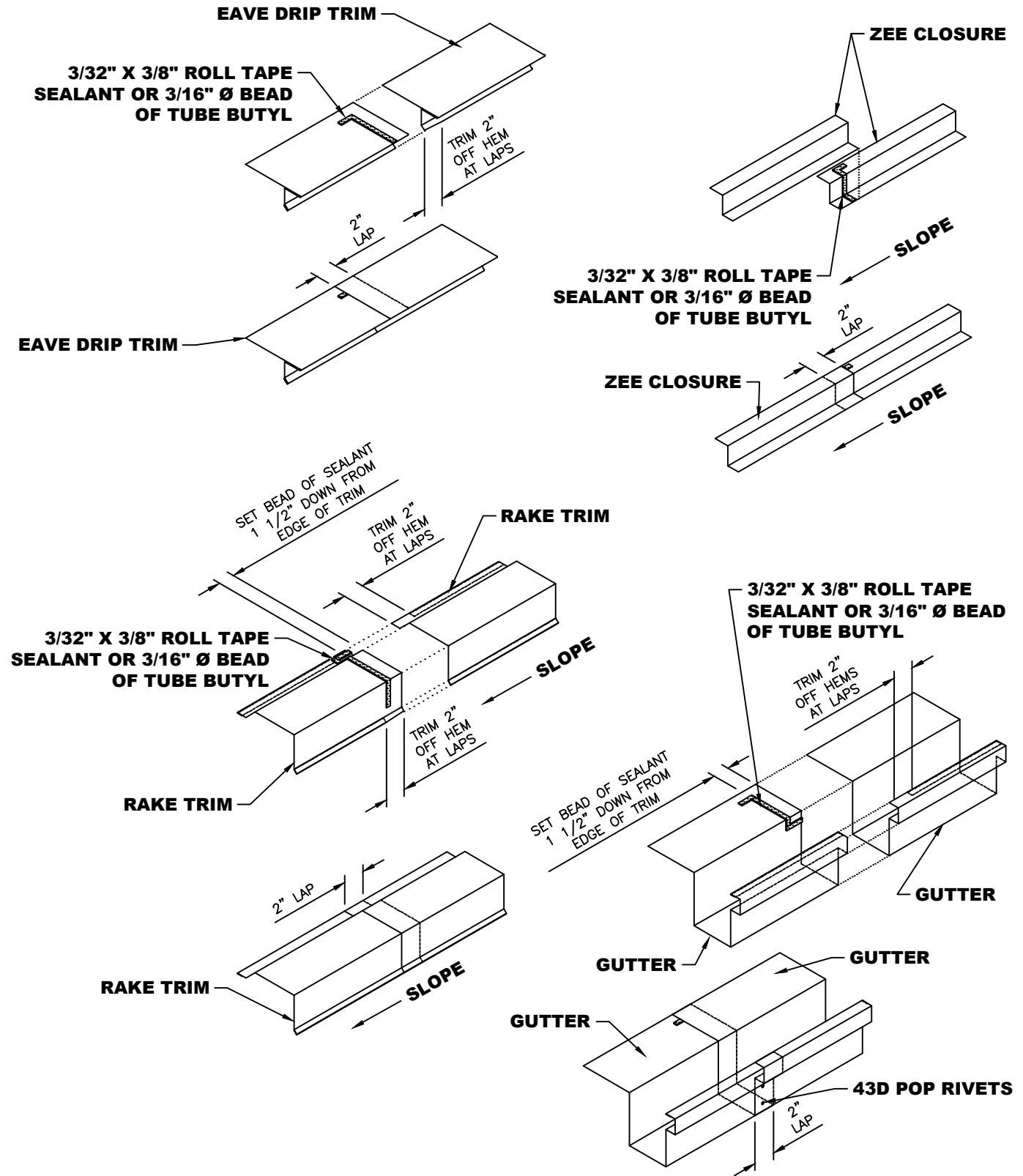

NOTE: 1. Apply specified Roll Tape Sealant or a 3/16" Ø bead of Tube Butyl 1 1/2" back from the edge of the trim. Also, apply a piece of tape sealant or bead of Tube Butyl as a Pigtail to completely seal joint.
 2. Notch the hems on the upper trim piece 2" so that the trim will fit flat in the lap joint.
 3. Secure trim laps with Pop Rivets as shown above.

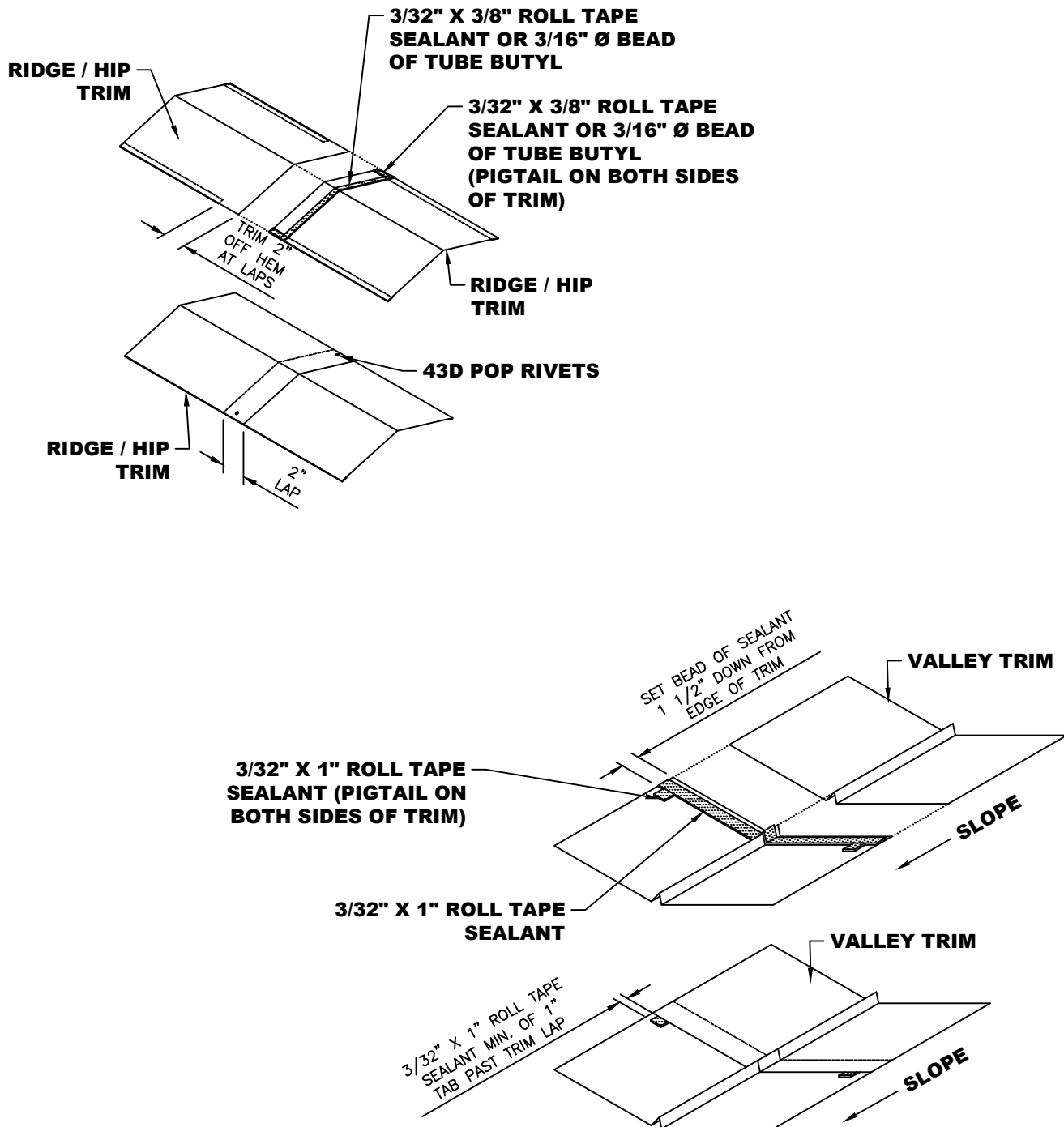

NOTE: 1. Apply specified Roll Tape Sealant or a 3/16" Ø bead of Tube Butyl 1 1/2" back from the edge of the trim. Also, apply a piece of tape sealant or bead of Tube Butyl as a Pigtail to completely seal joint.
 2. Notch the hems on the upper trim piece 2" so that the trim will fit flat in the lap joint.
 3. Secure trim laps with Pop Rivets as shown above.



☆ MANUFACTURING LOCATIONS ● SERVICE CENTERS ★ MANUFACTURING AND SERVICE CENTER



CORPORATE OFFICE
1500 HAMILTON RD.
BOSSIER CITY, LA 71111

MANUFACTURING LOCATIONS

ADELANTO, CA	ASHBURN, GA	BOSSIER CITY, LA	CLINTON, IL	DIAMOND, MO
HOUSTON, TX	LEWISPORT, KY	LOCKHART, TX	MARSHALL, MI	MAUSTON, WI
MERKEL, TX	PEACHTREE CITY, GA	SUNNYVALE, TX	WINCHESTER, VA	

McELROY METAL
SERVICE
CENTER
EMPLOYEE OWNED

17031 Koala Road Adelanto, CA 92301	5215 Leo St. Alexandria, LA 71301	1007 Wilso Dr, Baltimore, MD 21223	1500 Hamilton Rd. Bossier City, LA 71111
3052 Yadkin Road Chesapeake, VA 23323	9476 Meadowbrook Rd. Clinton, IL 61727	3215 Highway 59 Diamond, MO 64840	390 N. Valley Dell Dr. Fenton, MO 63026
409 Lovejoy Road Ft. Walton Beach, FL 32548	3014 Lincoln Court Garland, TX 75041	1440 Aldine Bender Road Houston, TX 77032	10504 E. 59th Street Indianapolis, IN 46236
32 Industrial Circle Lancaster, PA 17601	9435 US Hwy. 60 W. Lewisport, KY 42351	2701 Cahill Street Lockhart, TX 78644	1020 Veterans Street Mauston, WI 53948
5123 Terminal Dr. McFarland, WI 53558	514 Cave Road Nashville, TN 37210	8304 Hwy. 70 E. North Little Rock, AR 72117	613 North Bierdeman Rd. Pearl, MS 39208
8511 Industrial Drive Pearland, TX 77584	2755 Hwy 60 Pendergrass, GA 30567	7450 Tower Street Richland Hills, TX 76118	8200 Berry Ave. Suite 100 Sacramento, CA 95828
1365 Dean Forest Rd. Savannah, GA 31405	7355 Oakley Industrial Blvd. Union City, GA 30291	1144 Silstar Rd. West Columbia, SC 29170	325 McGhee Rd. Winchester, VA 22603

Website: www.mcelroymetal.com • E-mail: info@mcelroymetal.com