

MINI-RIB

INSTALLATION

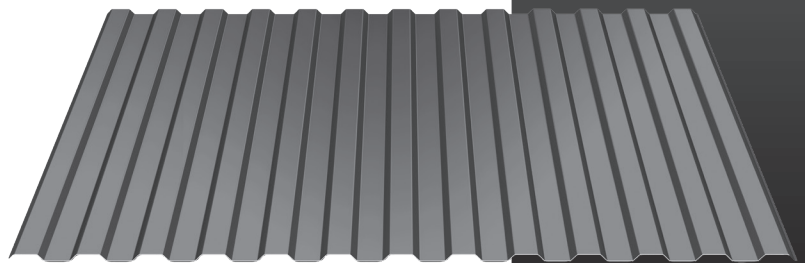

TABLE OF CONTENTS

PAGE NUMBER:	DETAIL DESCRIPTION
A-1.....	TABLE OF CONTENTS
A-2.....	GENERAL NOTES
B-1.....	FASTENER PATTERNS
<u>STANDARD VERTICAL INSTALLATION DETAILS - STEEL FRAMING</u>	
C-1.....	VERTICAL BASE DETAIL
C-2.....	VERTICAL JAMB DETAIL
C-3.....	VERTICAL JAMB (OFF MODULE) DETAIL
C-4.....	VERTICAL HEAD DETAIL
C-5.....	VERTICAL SILL DETAIL
C-6.....	VERTICAL OUTSIDE CORNER DETAIL
C-7.....	VERTICAL OUTSIDE CORNER (OFF MODULE) DETAIL
C-8.....	VERTICAL INSIDE CORNER DETAIL
C-9.....	VERTICAL INSIDE CORNER (OFF MODULE) DETAIL
<u>STANDARD VERTICAL INSTALLATION DETAILS - PLYWOOD</u>	
C-10.....	VERTICAL BASE DETAIL
C-11.....	VERTICAL JAMB DETAIL
C-12.....	VERTICAL JAMB (OFF MODULE) DETAIL
C-13.....	VERTICAL HEAD DETAIL
C-14.....	VERTICAL SILL DETAIL
C-15.....	VERTICAL OUTSIDE CORNER DETAIL
C-16.....	VERTICAL OUTSIDE CORNER (OFF MODULE) DETAIL
C-17.....	VERTICAL INSIDE CORNER DETAIL
C-18.....	VERTICAL INSIDE CORNER (OFF MODULE) DETAIL
<u>STANDARD HORIZONTAL INSTALLATION DETAILS - STEEL FRAMING</u>	
C-19.....	HORIZONTAL BASE DETAIL
C-20.....	HORIZONTAL JAMB DETAIL
C-21.....	HORIZONTAL HEAD DETAIL
C-22.....	HORIZONTAL HEAD (OFF MODULE) DETAIL
C-23.....	HORIZONTAL SILL DETAIL
C-24.....	HORIZONTAL SILL (OFF MODULE) DETAIL
C-25.....	HORIZONTAL OUTSIDE CORNER DETAIL
C-26.....	HORIZONTAL INSIDE CORNER DETAIL
<u>STANDARD HORIZONTAL INSTALLATION DETAILS - PLYWOOD</u>	
C-27.....	HORIZONTAL BASE DETAIL
C-28.....	HORIZONTAL JAMB DETAIL
C-29.....	HORIZONTAL HEAD DETAIL
C-30.....	HORIZONTAL HEAD (OFF MODULE) DETAIL
C-31.....	HORIZONTAL SILL DETAIL
C-32.....	HORIZONTAL SILL (OFF MODULE) DETAIL
C-33.....	HORIZONTAL OUTSIDE CORNER DETAIL
C-34.....	HORIZONTAL INSIDE CORNER DETAIL
C-35.....	TYPICAL TRIM LAPS DETAILS

GENERAL NOTES

The details shown on the following pages are suggestions or guidelines for installing the Mini-Rib wall panel system over wall girts and plywood. The installation details shown here are proven methods of construction, but they are not intended to cover all building requirements, designs or codes. The details may require changes or revisions due to individual project conditions.

Installation procedures shall be in accordance with the manufacturer's printed instructions, details or approved shop drawings. Installers should thoroughly familiarized themselves with all instructions prior to beginning the installation process.

The designer/installer is responsible to ensure the following:

That the details here meet the particular building requirements.

Awareness of and allowance for expansion/contraction of the wall panels.

That adequate water-tightness is maintained.

That a proper uniform substructure is used to avoid panel distortion and that the substructure meets necessary code requirements.

That all supporting members have been examined and are straight, level and plumb.

McElroy Metal can provide all flashings and accessories shown in the installation drawings unless noted otherwise. Panels, flashing and trim shall be installed true and in proper alignment with any exposed fasteners equally spaced for the best appearance. Sealant shall be field applied on a clean, dry surface.

Some field cutting and fitting of panels and flashings is to be expected and to be considered a part of normal installation work. Workmanship shall be of the best industry standards and with installation performed by experienced metal craftsmen.

Oil canning of metal panels is inherent in metal and is not a cause for rejection. Striated panels are recommended to reduce the appearance of oil canning.

Contents of this manual are subject to change without notice. To confirm this book is the most current copy, please visit McElroy Metal's website at www.mcelroymetal.com.

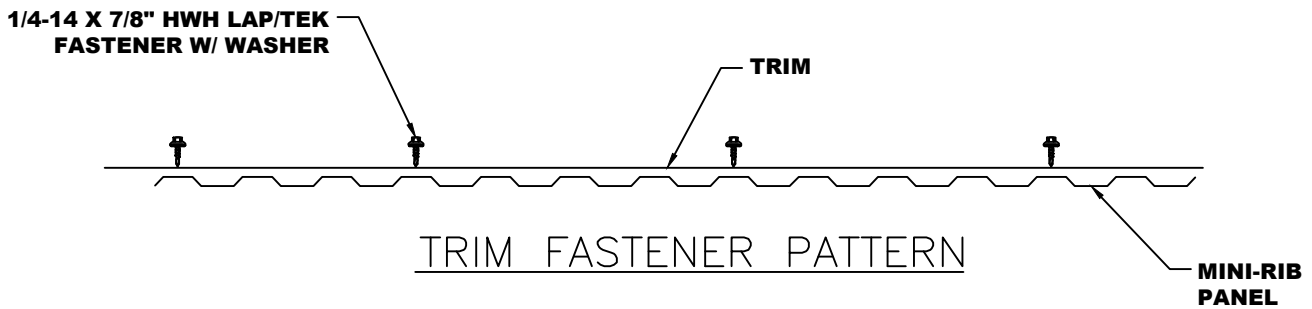
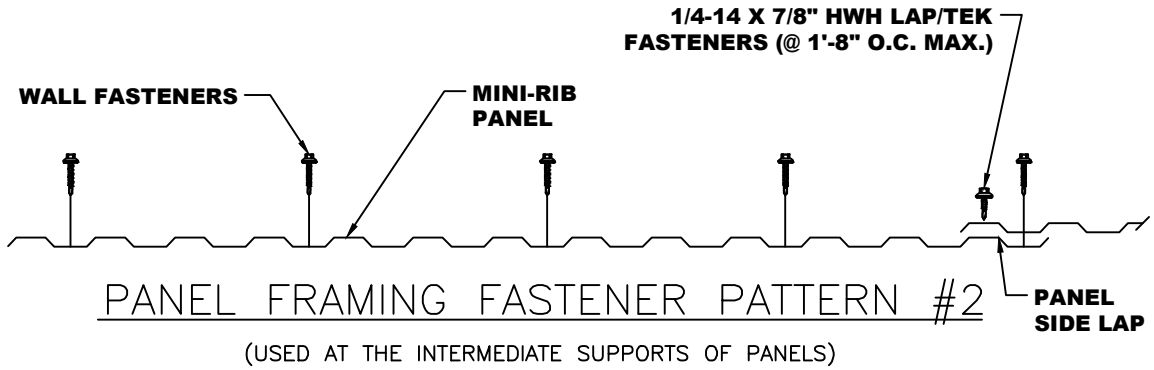
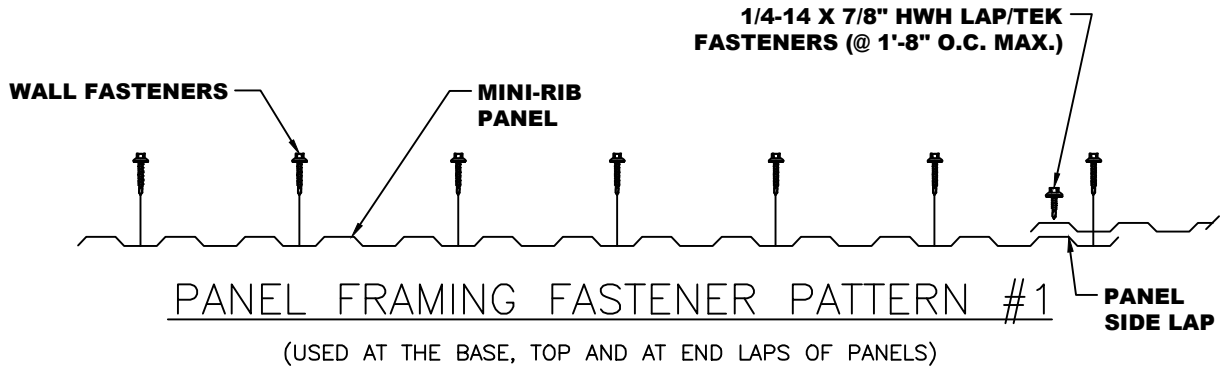

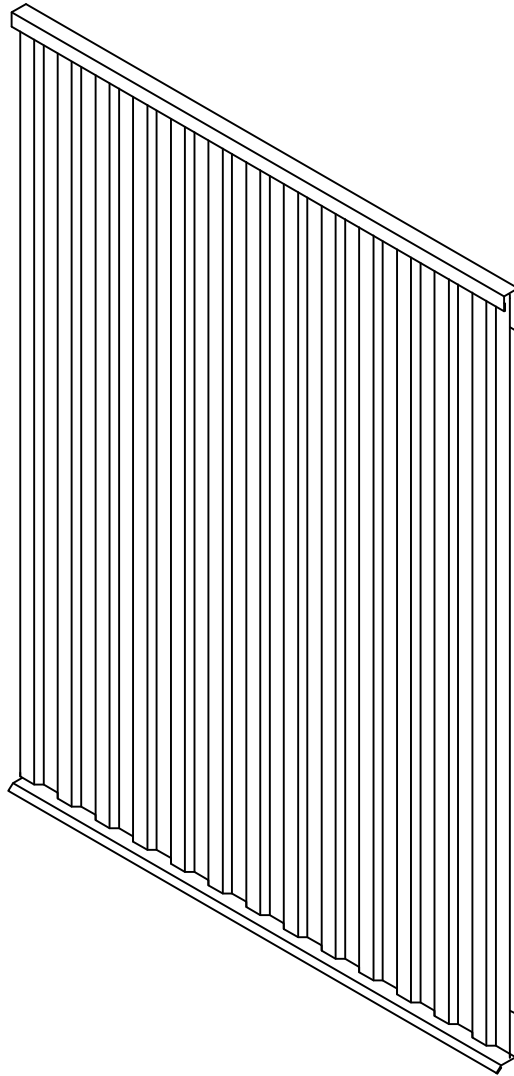

STANDARD VERTICAL INSTALLATION DETAILS

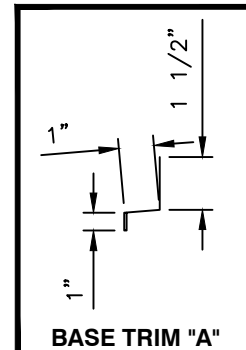
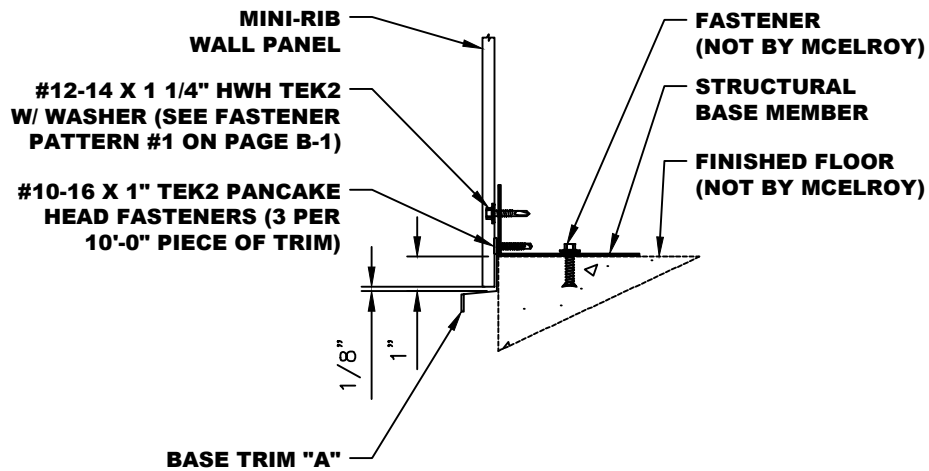

- NOTES:**
1. Base Structural Member set flush with edge of finished floor.
 2. Set Base Trim "A" 1" down face of finished floor and attach to Structural Base Member with #10-16 x 1" Tek2 Pancake Head Fasteners. Use three (3) fasteners per 10'-0" piece of trim.
 3. Set Mini-Rib Wall Panel in place. Make sure to leave a 1/8" gap between base trim and panel.
 4. Attach Mini-Rib Panel with #12-14 x 1 1/4" HWH Tek2 w/ Washer Fasteners per Fastening Pattern #1 shown on page B-1 of this manual.

*NOTE: SOME TRIM ITEMS AND FASTENERS HAVE BEEN REMOVED FOR CLARITY OF ISOMETRIC DETAIL.

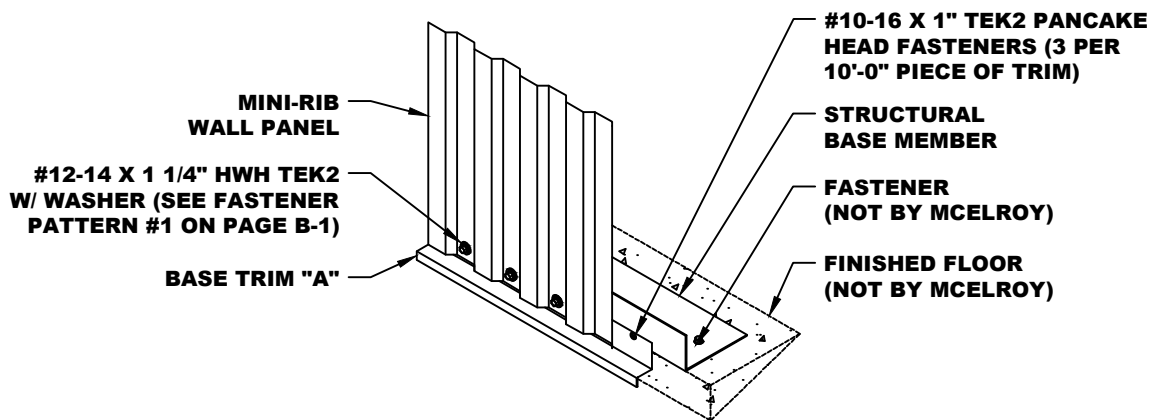

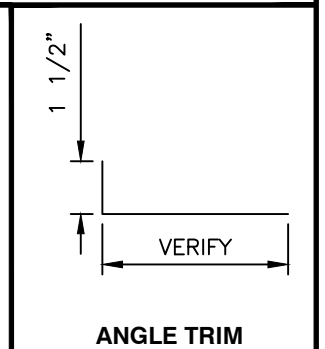
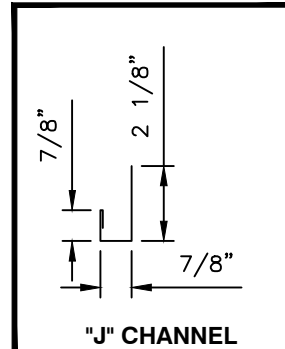
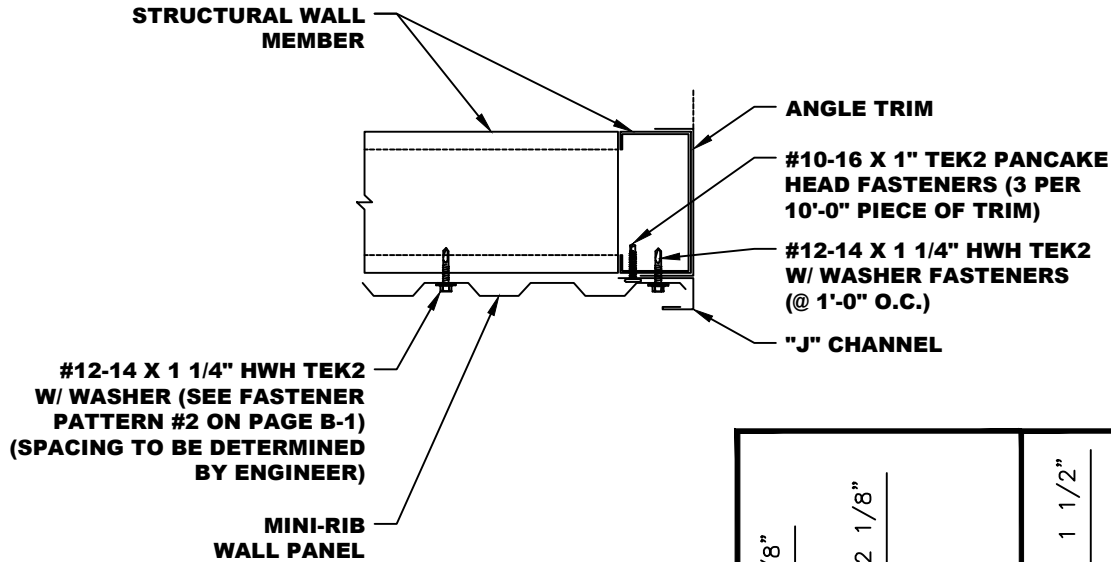

- NOTES:**
1. Attach Angle Trim to Structural Wall Member. If you ordered trim wider than Structural Member, fold back as shown in detail. You can hold in place with temporary fasteners if needed.
 2. Set "J" Channel in place as shown and attach to Structural Wall Member with #10-16 x 1" Tek2 Pancake Head Fasteners. Use three (3) fasteners per 10'-0" piece of trim.
 3. Set Mini-Rib Wall Panel in place and fasten to Structural Wall Members with #12-14 x 1 1/4" HWH Tek2 w/ Washer Fasteners per Fastener Pattern #2 shown on page B-1 of this manual.

*NOTE: SOME TRIM ITEMS AND FASTENERS HAVE BEEN REMOVED FOR CLARITY OF ISOMETRIC DETAIL.

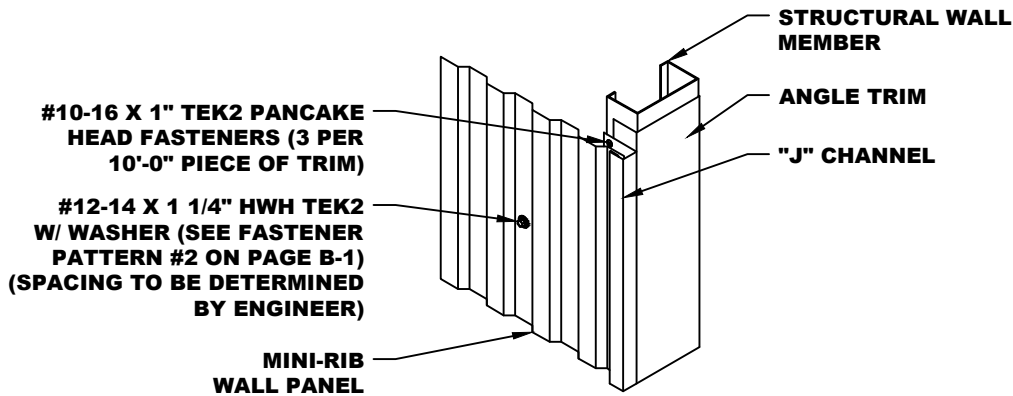

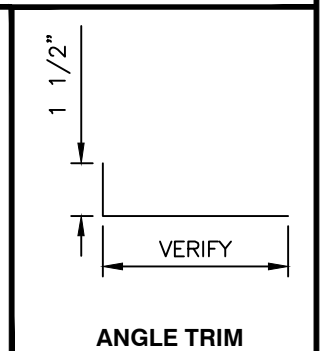
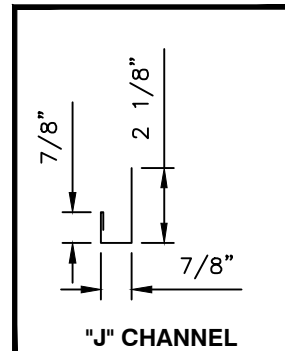
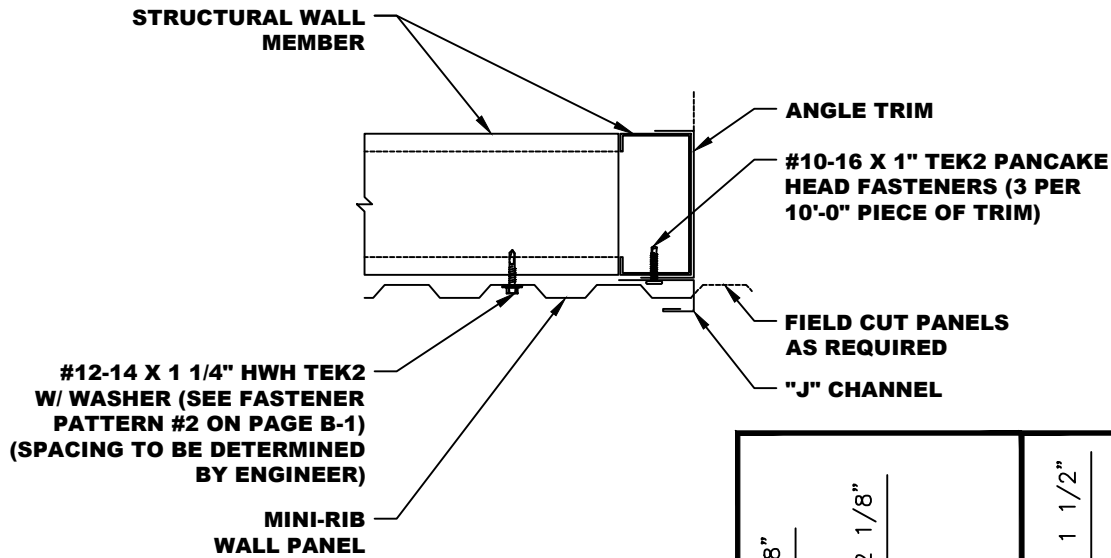

- NOTES:**
1. Attach Angle Trim to Structural Wall Member. If you ordered trim wider than Structural Member, fold back as shown in detail. You can hold in place with temporary fasteners if needed.
 2. Set "J" Channel in place as shown and attach to Structural Wall Member with #10-16 x 1" Tek2 Pancake Head Fasteners. Use three (3) fasteners per 10'-0" piece of trim.
 3. Field Cut Mini-Rib Panel as required and set in place and fasten to Structural Wall Members with #12-14 x 1 1/4" HWH Tek2 w/ Washer Fasteners per Fastener Pattern #2 on page B-1 on this manual.

*NOTE: SOME TRIM ITEMS AND FASTENERS HAVE BEEN REMOVED FOR CLARITY OF ISOMETRIC DETAIL.

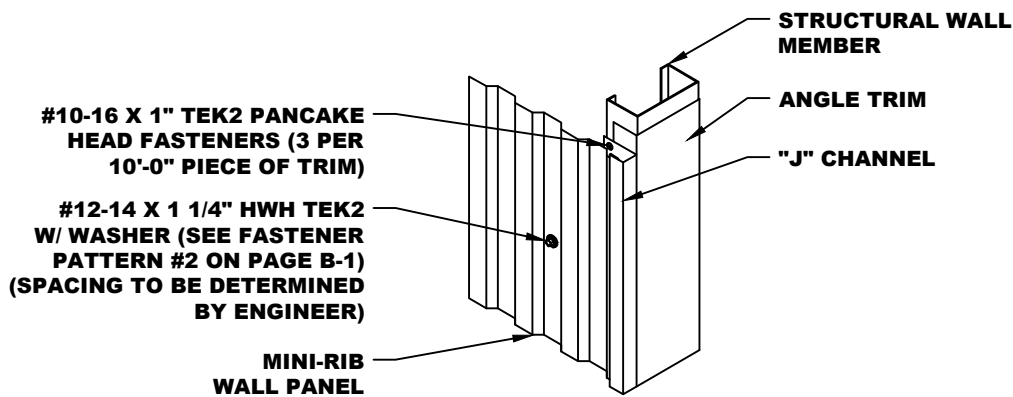

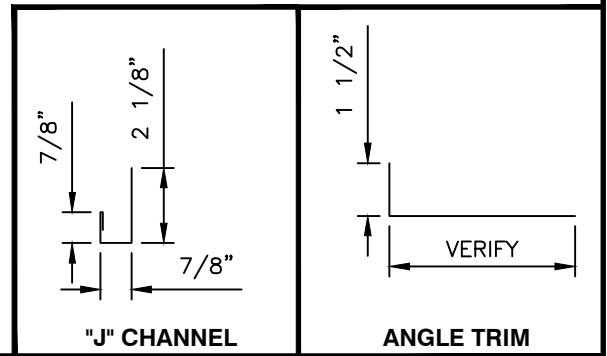
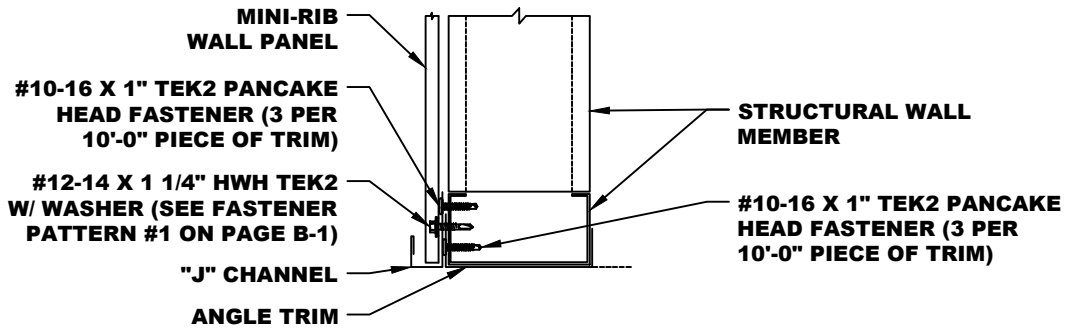

- NOTES:**
1. Attach Angle Trim to Structural Wall Member. If you ordered trim wider than Structural Member, fold back as shown in detail. Attach with #10-16 x 1" Tek2 Pancake Head Fasteners three (3) per 10'-0" piece of trim.
 2. Set "J" Channel in place as shown and attach to Structural Wall Member with #10-16 x 1" Tek2 Pancake Head Fasteners three (3) fasteners per 10'-0" piece of trim.
 3. Set Mini-Rib Wall Panel in place and fasten to Structural Wall Members with #12-14 x 1 1/4" HWH Tek2 w/ Washer Fasteners per Fastener Pattern #1 on page B-1 of this manual.

*NOTE: SOME TRIM ITEMS AND FASTENERS HAVE BEEN REMOVED FOR CLARITY OF ISOMETRIC DETAIL.

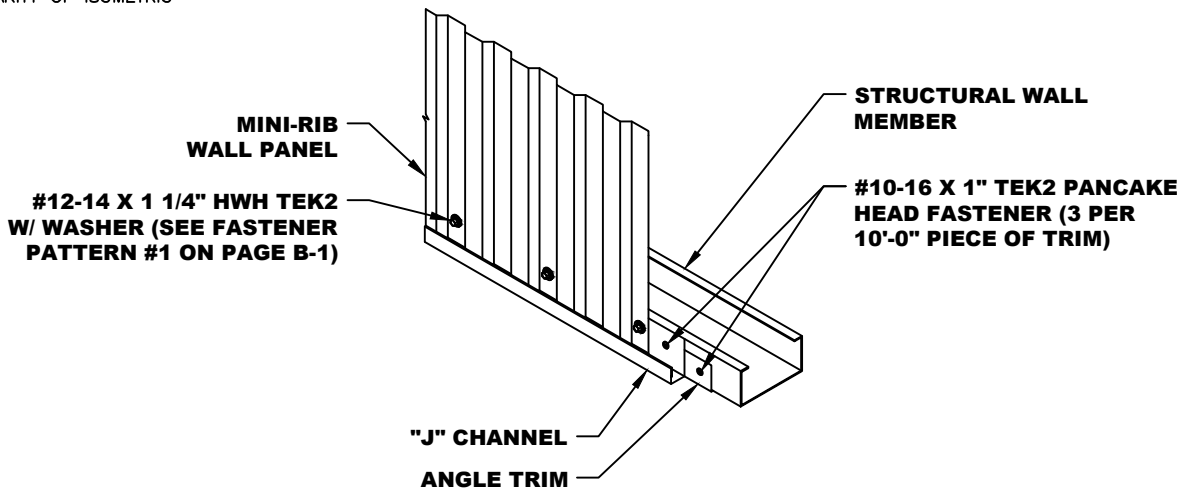

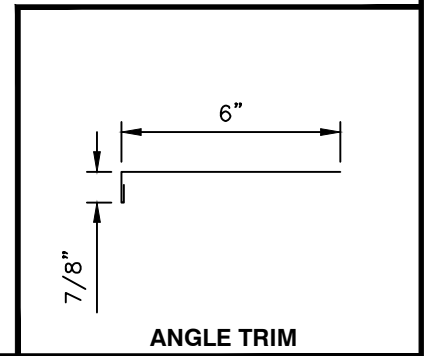
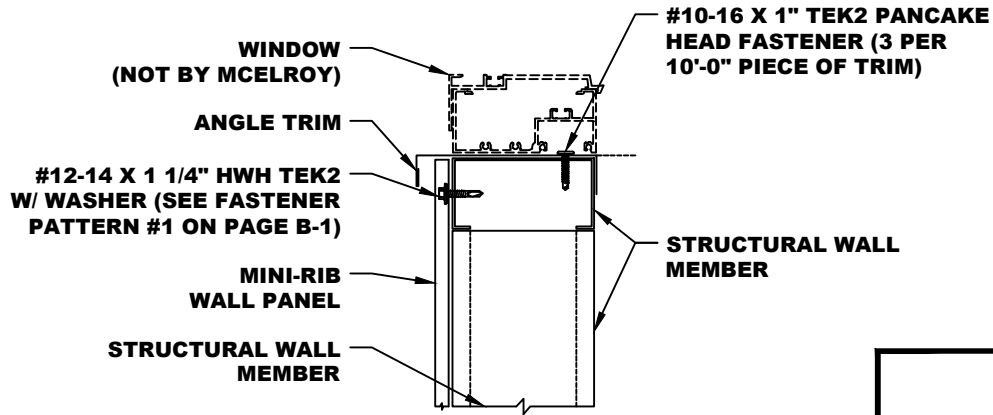

- NOTES:**
1. Measure and cut Mini-Rib Panel to fit around window as required.
 2. Set Mini-Rib Panel in place and attach to Structural Wall Member with #12-14 x 1 1/4" HWH Tek2 w/ Washer Fasteners per fastener pattern #1 on page B-1 of this manual.
 3. Cut Angle Trim to fit as required and attach to Structural Wall Member with #10-16 x 1" Tek2 Pancake Fasteners at three (3) per 10'-0" piece of trim.

*NOTE: SOME TRIM ITEMS AND FASTENERS HAVE BEEN REMOVED FOR CLARITY OF ISOMETRIC DETAIL.

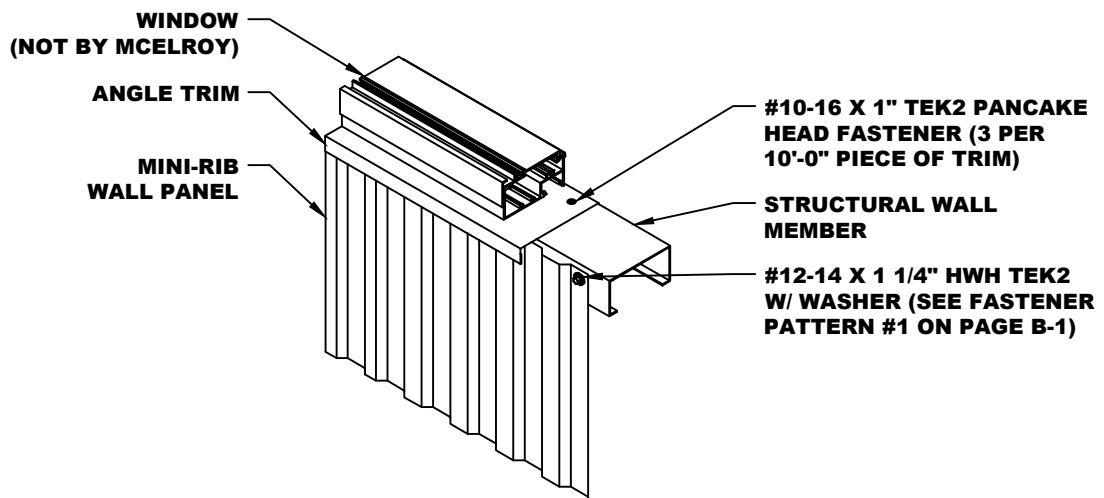

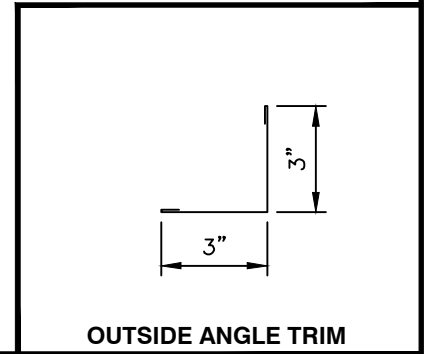
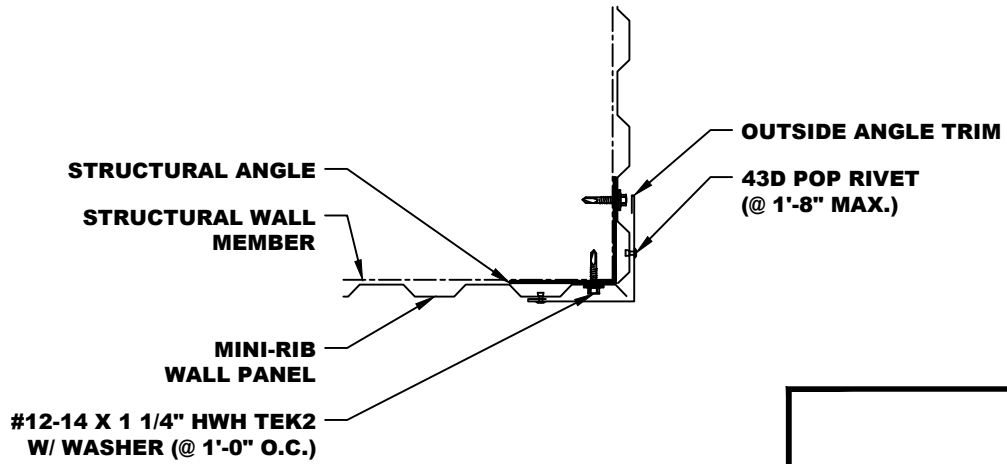

- NOTES:** 1. Attach Mini-Rib Panels to framework with #12-14 x 1 1/4" HWH Tek2 w/ Washer Fastener at 1'-0" O.C.
2. Outside Corner Trim to run from Base Trim to top of wall panel.
3. Attach Outside Corner Trim to Mini-Rib Panel with 43D Pop Rivets at 1'-8" O.C. (Max.).

*NOTE: SOME TRIM ITEMS AND FASTENERS HAVE BEEN REMOVED FOR CLARITY OF ISOMETRIC DETAIL.

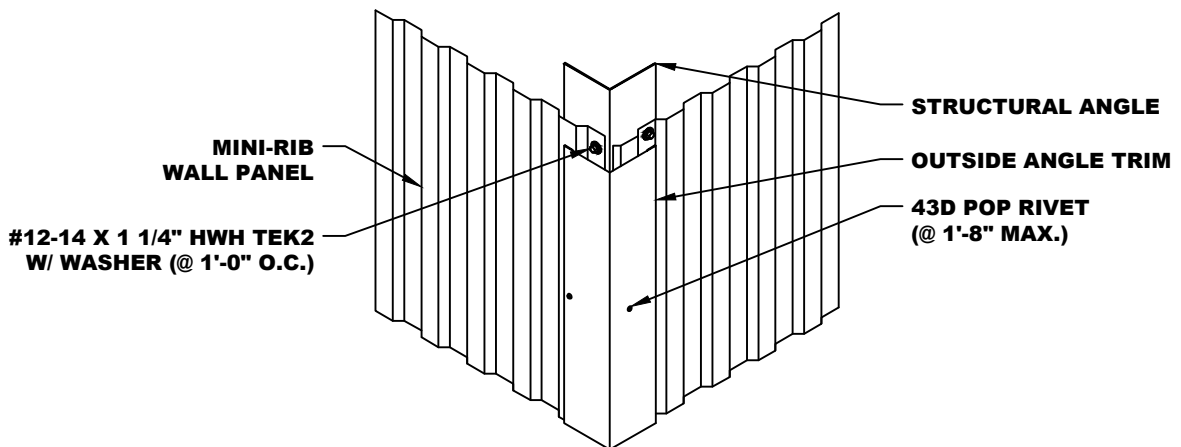

VERTICAL OUTSIDE CORNER (OFF MODULE) DETAIL

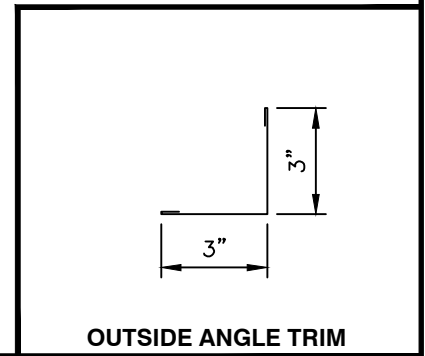
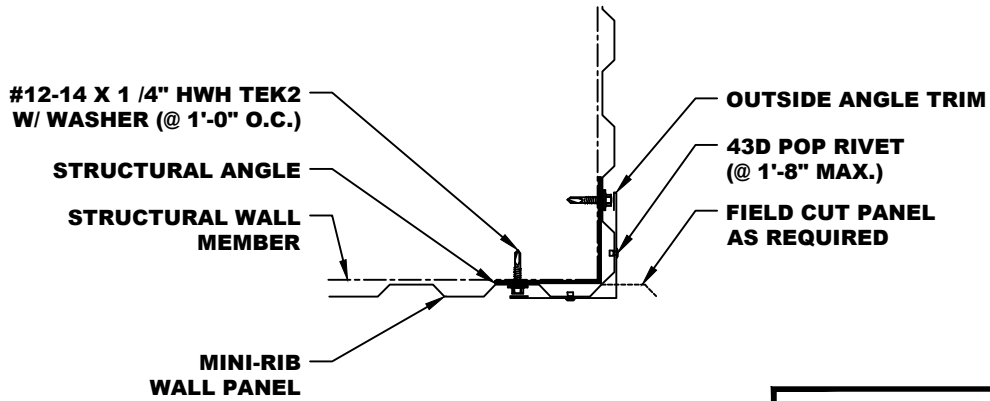

- NOTES:**
1. Measure and Field Cut Mini-Rib Panel as required. Attach panels to framework with #12-14 x 1/4" HWH Tek2 w/ Washer Fastener at 1'-0" O.C.
 2. Outside Corner Trim to run from Base Trim to top of wall panel.
 3. Attach Outside Corner Trim to Mini-Rib Panel with 43D Pop Rivets at 1'-8" O.C. (Max.).

*NOTE: SOME TRIM ITEMS AND FASTENERS HAVE BEEN REMOVED FOR CLARITY OF ISOMETRIC DETAIL.

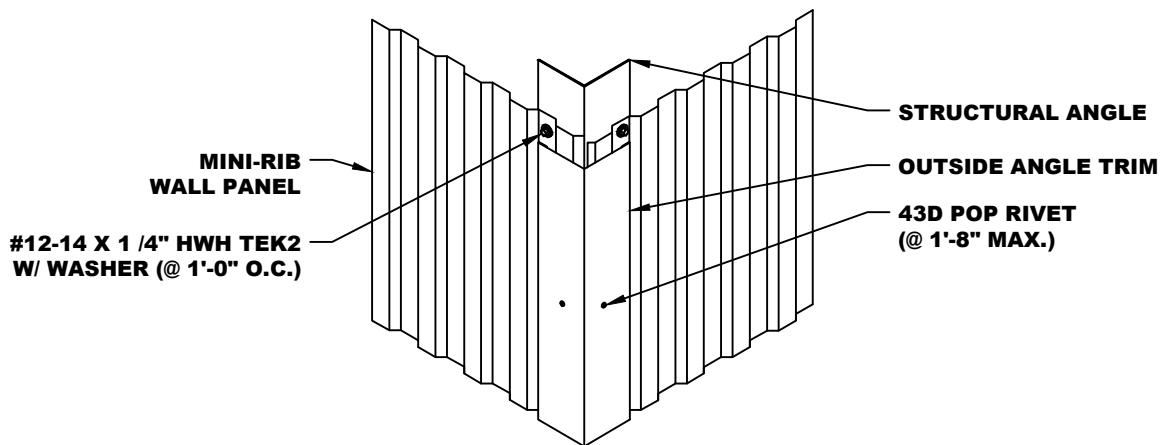

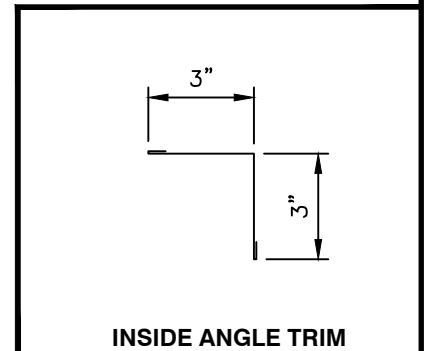
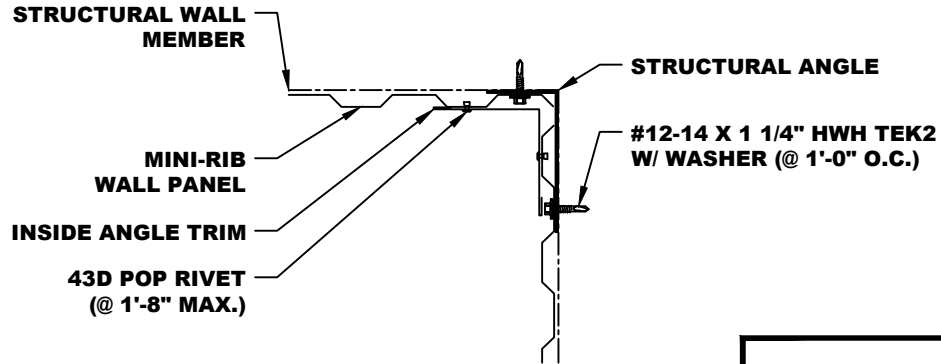

- NOTES:**
1. Attach Mini-Rib Panels to framework with #12-14 x 1 1/4" HWH Tek2 w/ Washer Fastener at 1'-0" O.C.
 2. Inside Corner Trim to run from Base Trim to top of wall panel.
 3. Attach Inside Corner Trim to Mini-Rib Panel with 43D Pop Rivets at 1'-8" O.C. (Max.).

*NOTE: SOME TRIM ITEMS AND FASTENERS HAVE BEEN REMOVED FOR CLARITY OF ISOMETRIC DETAIL.

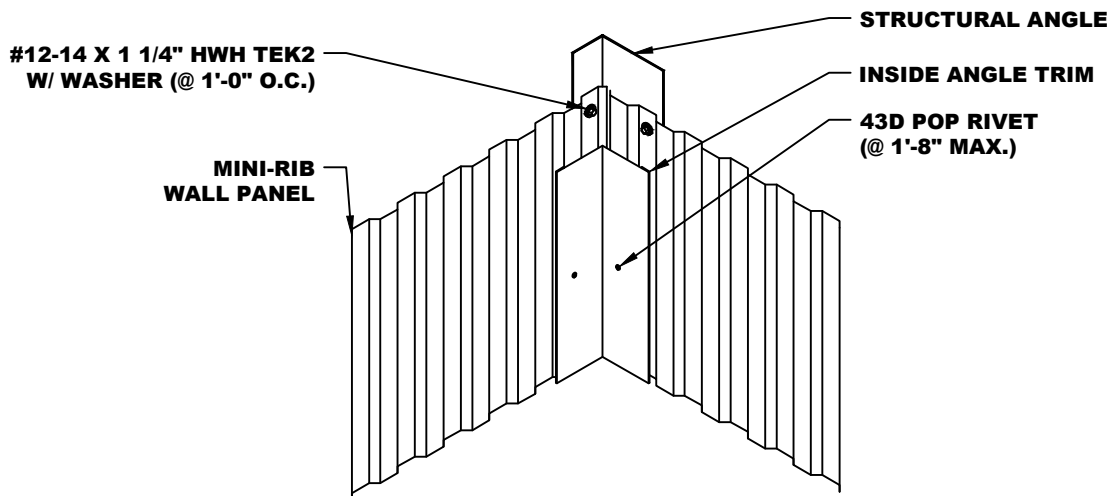

VERTICAL INSIDE CORNER (OFF MODULE) DETAIL

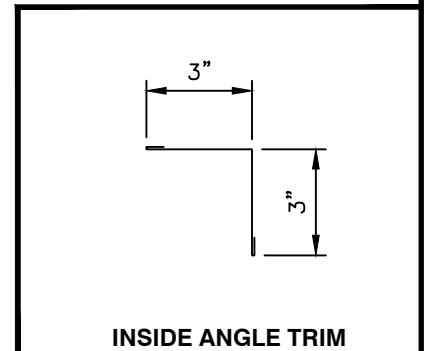
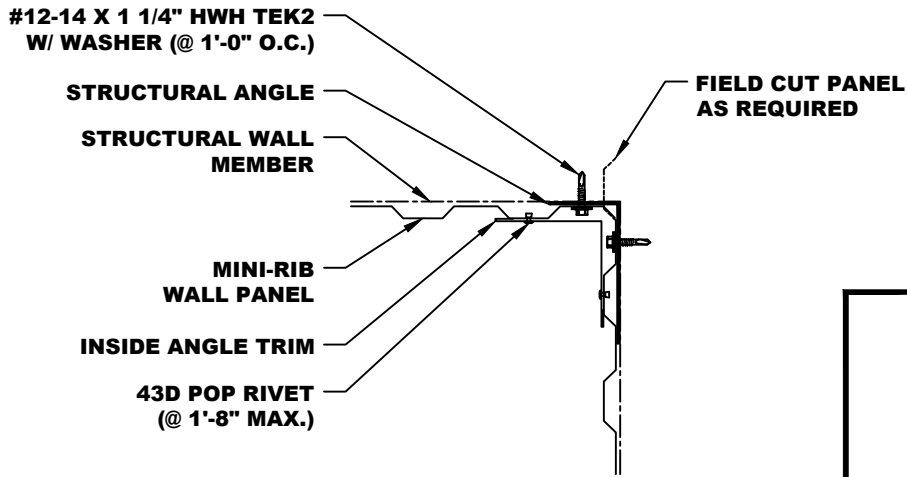

- NOTES:** 1. Measure and Field Cut Mini-Rib Panel as require. Attach panels to framework with #12-14 x 1 1/4" HWH Tek2 w/ Washer Fastener at 1'-0" O.C.
2. Inside Corner Trim to run from Base Trim to top of wall panel.
3. Attach Inside Corner Trim to Mini-Rib Panel with 43D Pop Rivets at 1'-8" O.C. (Max.).

*NOTE: SOME TRIM ITEMS AND FASTENERS HAVE BEEN REMOVED FOR CLARITY OF ISOMETRIC DETAIL.

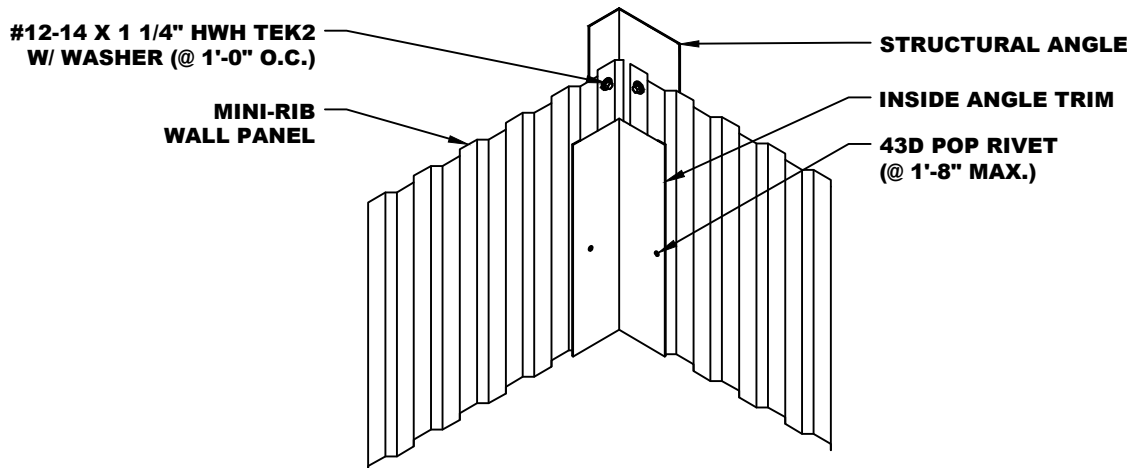

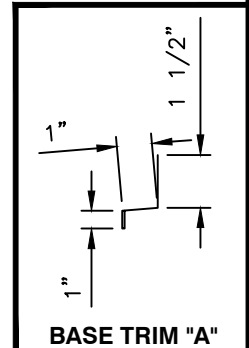
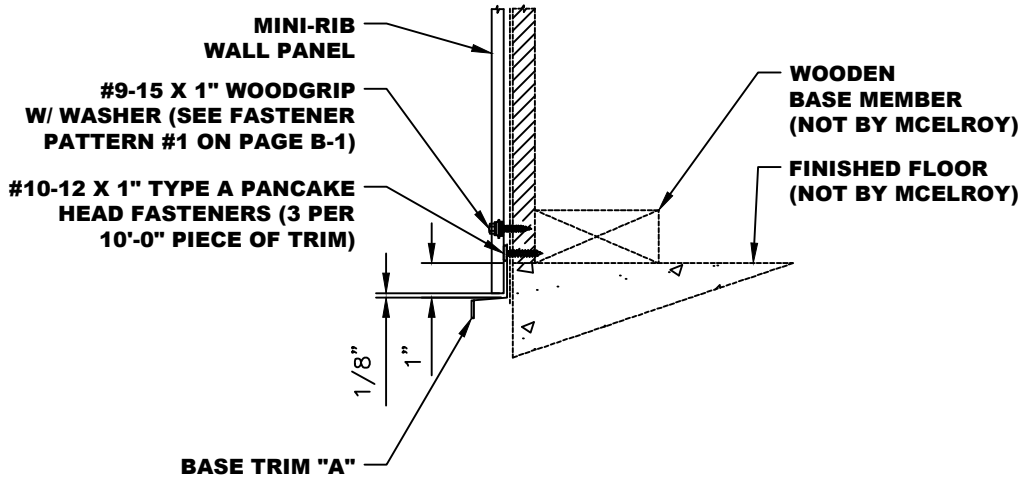

- NOTES:**
1. Plywood set flush with edge of finished floor.
 2. Set Base Trim "A" 1" down face of finished floor and attach to Plywood with #10-12 x 1" Type A Pancake Head Fasteners. Use three (3) fasteners per 10'-0" piece of trim.
 3. Set Mini-Rib Wall Panel into place. Make sure to leave a 1/8" gap between base trim and panel.
 4. Attach panel with #9-15 x 1" Woodgrip w/ Washer Fasteners per Fastening Pattern #1 shown on page B-1, B-1 of this manual.

*NOTE: SOME TRIM ITEMS AND FASTENERS HAVE BEEN REMOVED FOR CLARITY OF ISOMETRIC DETAIL.

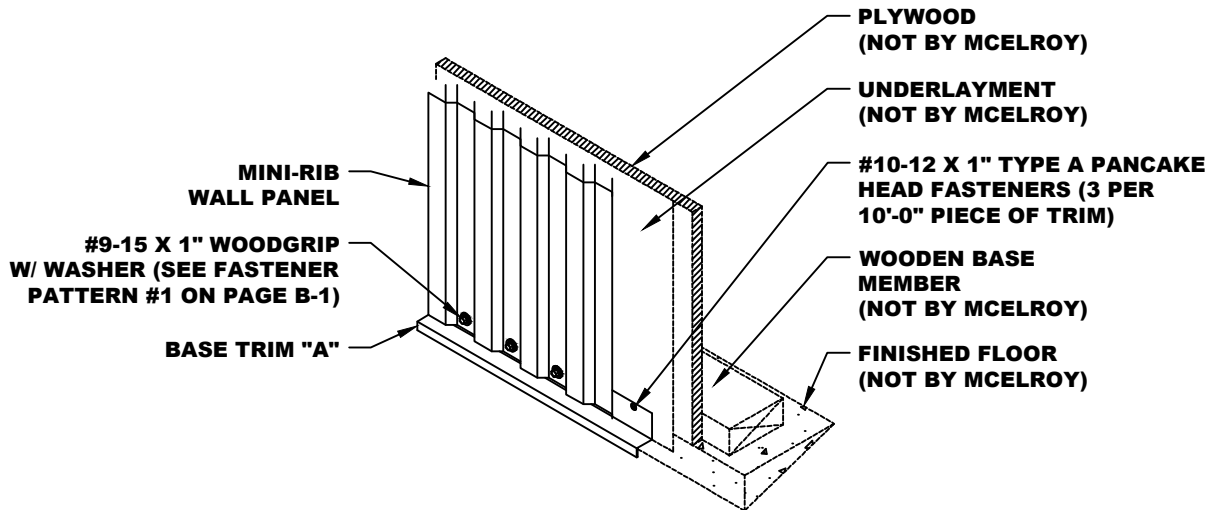

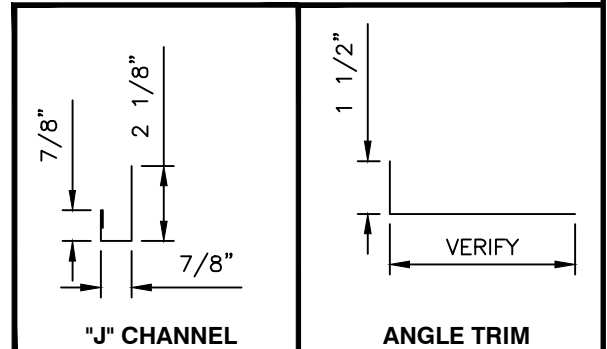
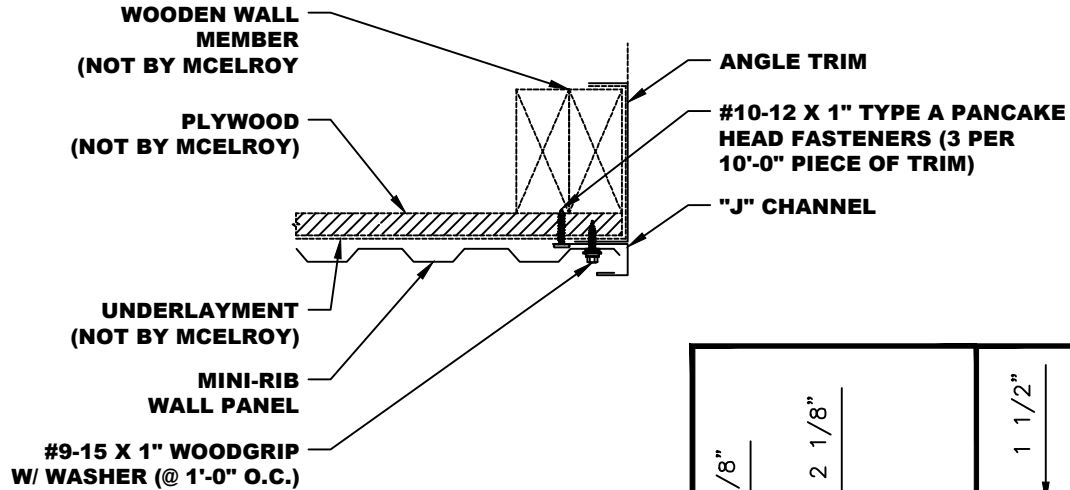

- NOTES:**
1. Attach Angle Trim to Structural Wall Member. If you ordered trim wider than Structural Member, fold back as shown in detail. You can hold in place with temporary fasteners if needed.
 2. Set "J" Channel in place as shown and attach to Structural Wall Member with #10-12 x 1" Type A Pancake Head Fasteners. Use three (3) fasteners per 10'-0" piece of trim.
 3. Set Mini-Rib Wall Panel in place and fasten to Plywood with #9-15 x 1" Type A Woodgrip w/ Washer Fasteners at 1'-0" O.C.

*NOTE: SOME TRIM ITEMS AND FASTENERS HAVE BEEN REMOVED FOR CLARITY OF ISOMETRIC DETAIL.

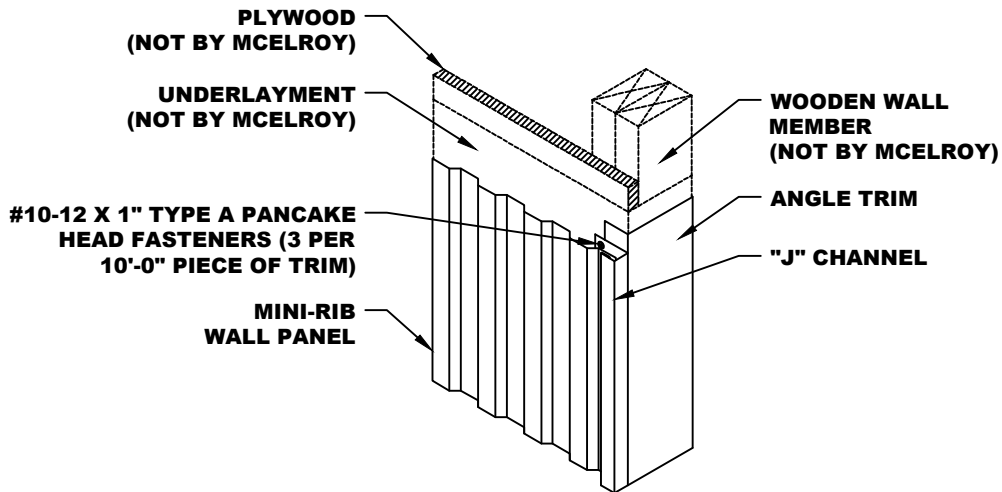

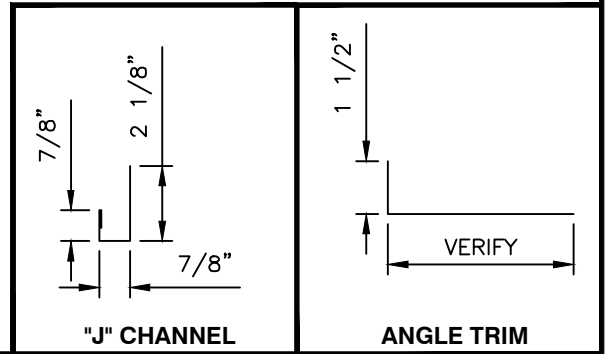
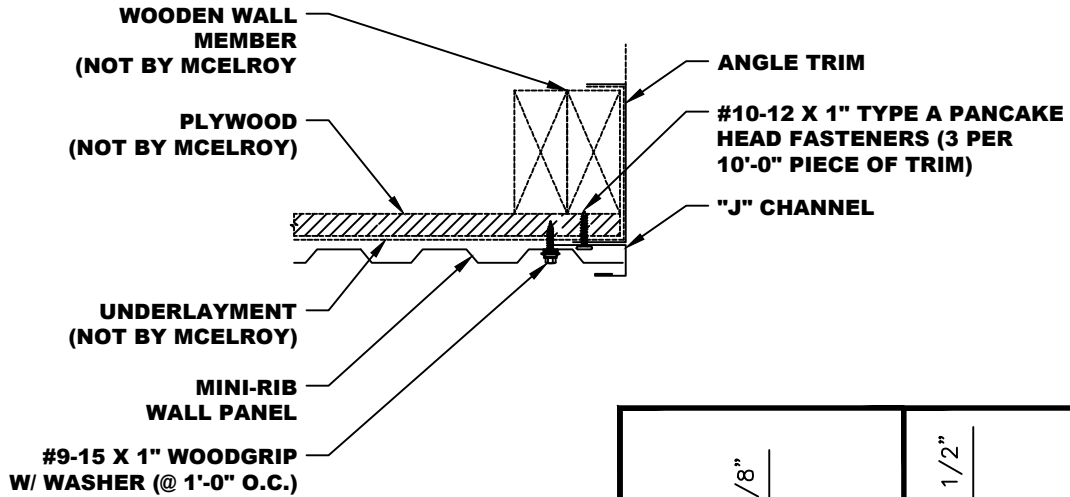

- NOTES:**
1. Attach Angle Trim to Structural Wall Member. If you ordered trim wider than Structural Member, fold back as shown in detail. You can hold in place with temporary fasteners if needed.
 2. Set "J" Channel in place as shown and attach to Structural Wall Member with #10-12 x 1" Type A Pancake Head Fasteners. Use three (3) fasteners per 10'-0" piece of trim.
 3. Field Cut Mini-Rib Panel as required and set in place and attach to Plywood with #9-15 x 1" Woodgrip w/ Washer Fasteners at 1'-0" O.C.

*NOTE: SOME TRIM ITEMS AND FASTENERS HAVE BEEN REMOVED FOR CLARITY OF ISOMETRIC DETAIL.

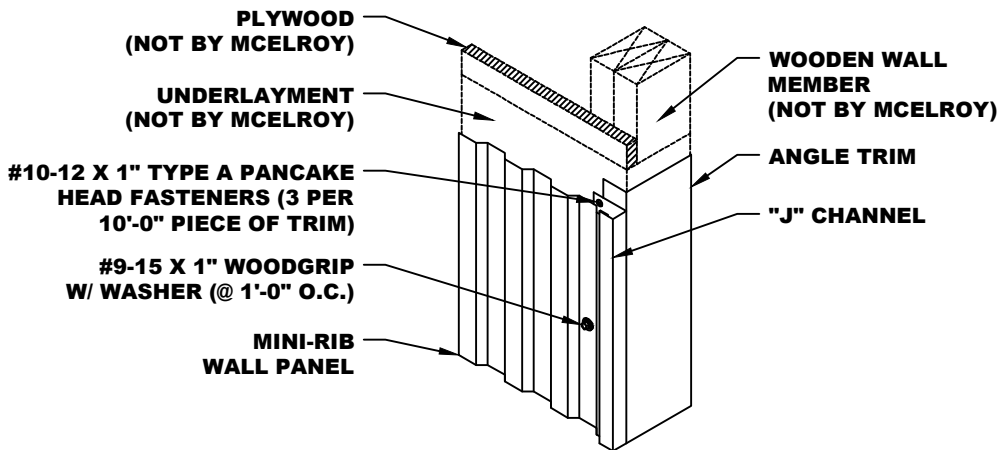

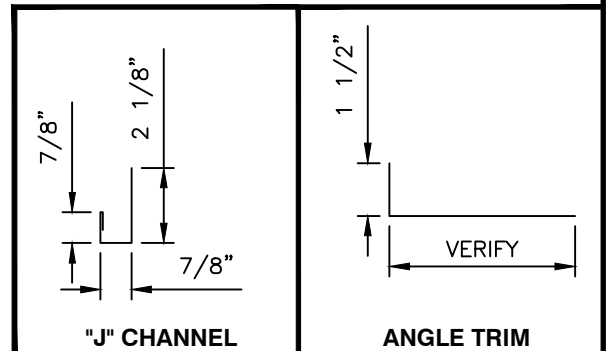
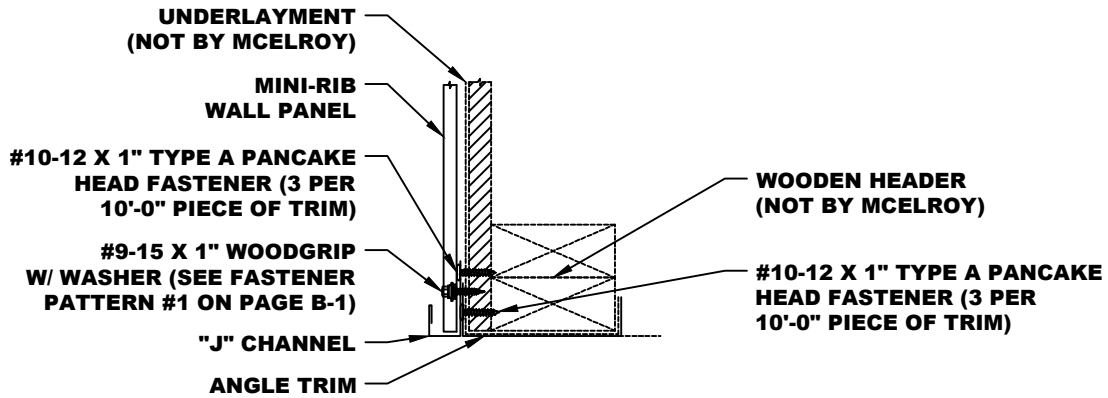

- NOTES:**
1. Attach Angle Trim to Structural Wall Member. If you ordered trim wider than Structural Member, fold back as shown in detail. Attach with #10-12 x 1" Type A Pancake Head Fasteners three (3) per 10'-0" piece of trim.
 2. Set "J" Channel in place as shown and attach to Structural Wall Member with #10-16 x 1" Tek2 Pancake Head Fasteners three (3) fasteners per 10'-0" piece of trim.
 3. Set Mini-Rib Wall Panel in place and fasten to Plywood with #9-15 x 1: Woodgrip w/ Washer Fasteners per Fastener Pattern #1 on page B-1 of this manual.

*NOTE: SOME TRIM ITEMS AND FASTENERS HAVE BEEN REMOVED FOR CLARITY OF ISOMETRIC DETAIL.

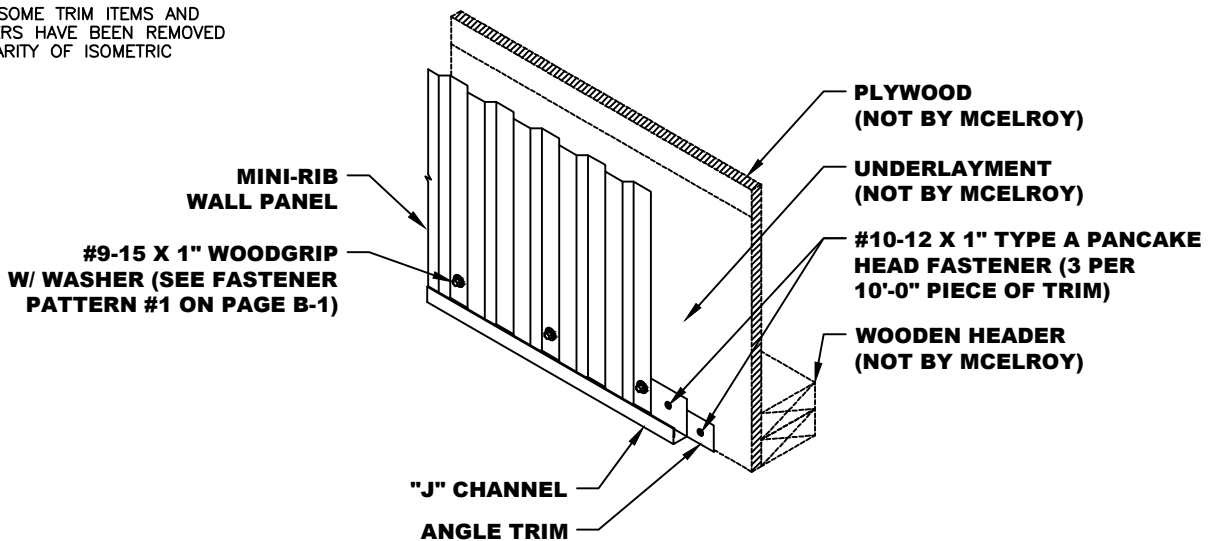

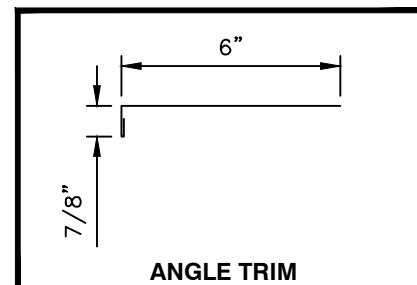
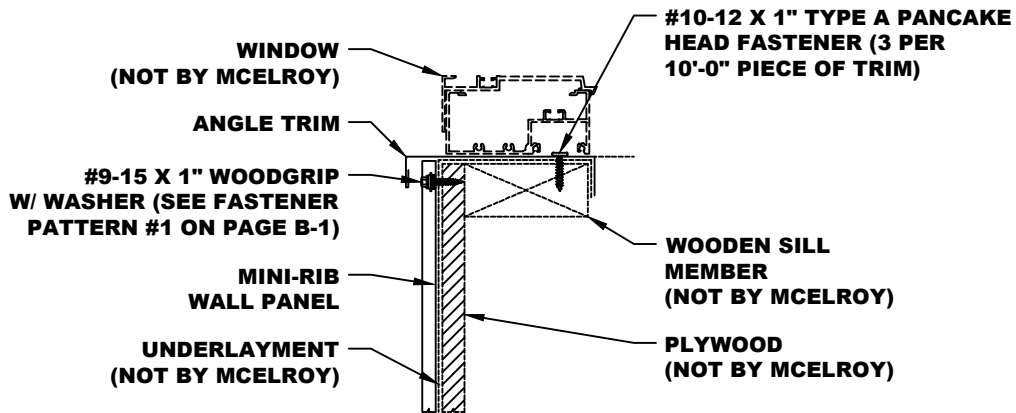

- NOTES:**
1. Measure and cut Mini-Rib Panel to fit around window as required.
 2. Set Mini-Rib Panel in place and attach to Plywood with #9-15 x 1" Woodgrip w/ Washer Fasteners per fastener pattern #1 on page B-1.
 3. Cut Angle Trim to fit as required and attach to Structural Wall Member with #10-12 x 1" Type A Pancake Head Fasteners at three (3) per 10'-0" piece of trim.

*NOTE: SOME TRIM ITEMS AND FASTENERS HAVE BEEN REMOVED FOR CLARITY OF ISOMETRIC DETAIL.

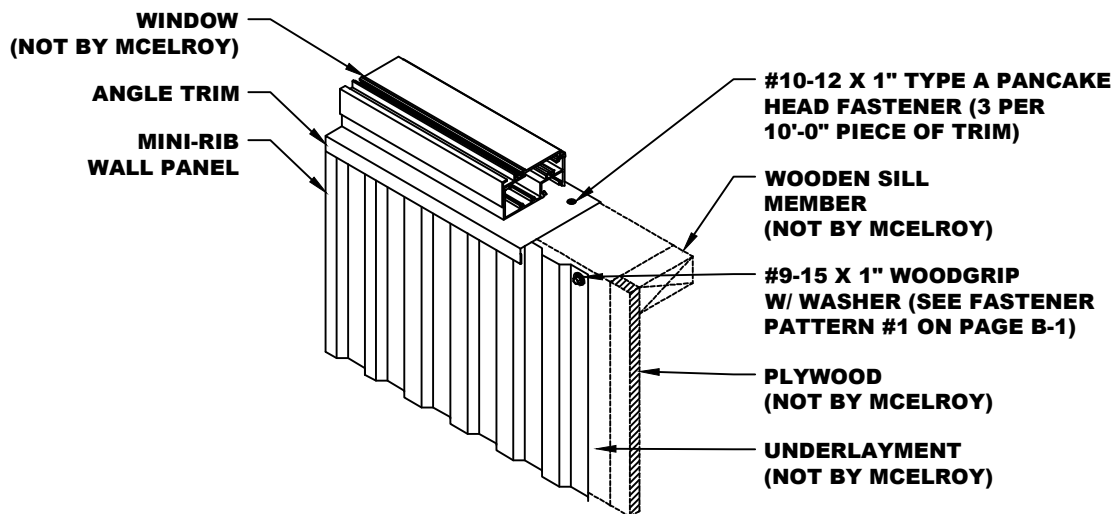

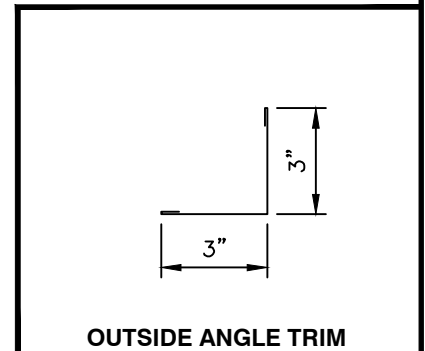
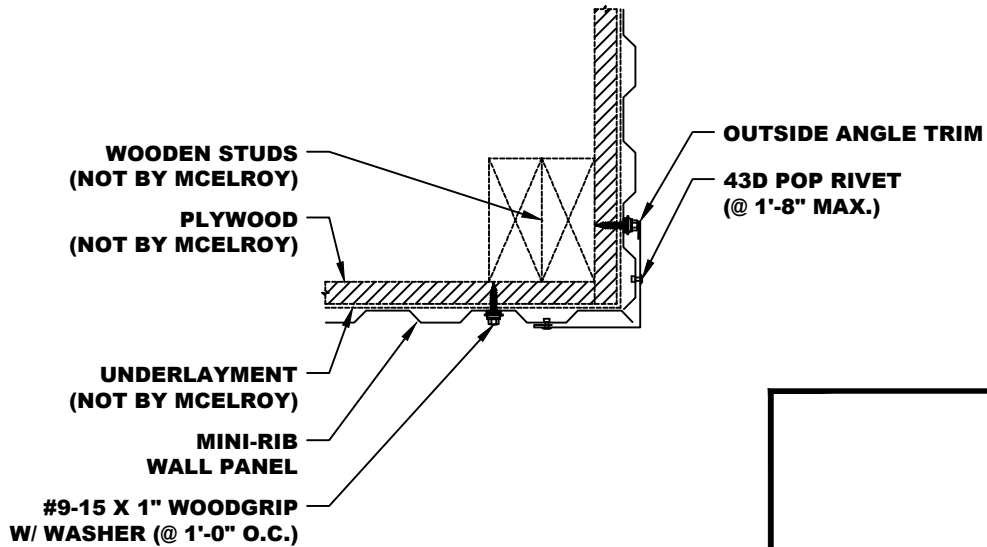

- NOTES:** 1. Attach Mini-Rib Panels to Plywood with #9-15 x 1" Woodgrip w/ Washer Fastener at 1'-0" O.C.
 2. Outside Corner Trim to run from Base Trim to top of wall panel.
 3. Attach Outside Corner Trim to Mini-Rib Panel with 43D Pop Rivets at 1'-8" O.C. (Max.).

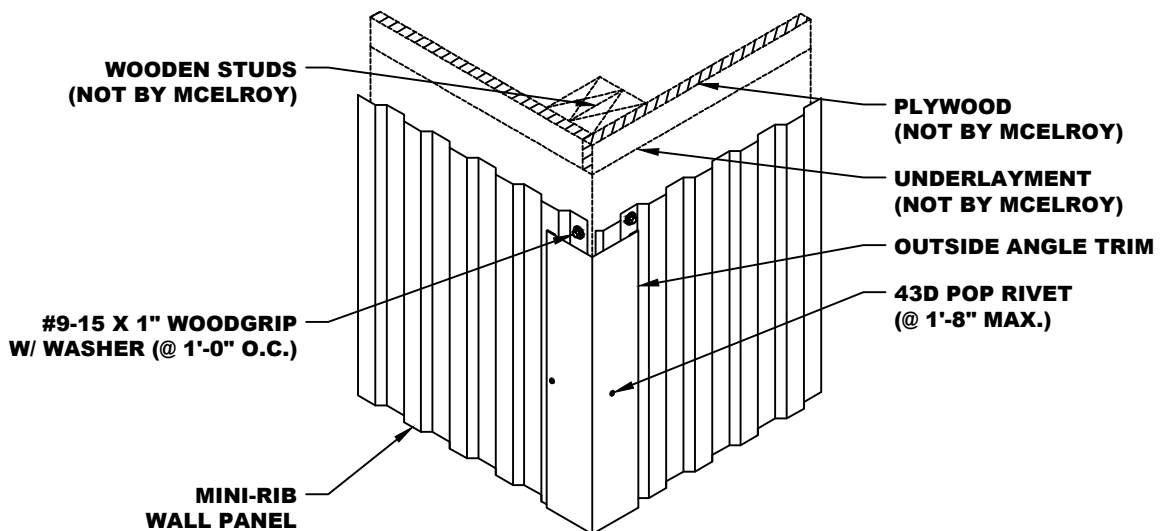

*NOTE: SOME TRIM ITEMS AND FASTENERS HAVE BEEN REMOVED FOR CLARITY OF ISOMETRIC DETAIL.

VERTICAL OUTSIDE CORNER DETAIL (OFF MODULE) DETAIL

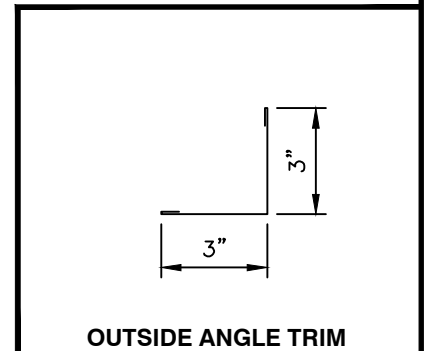
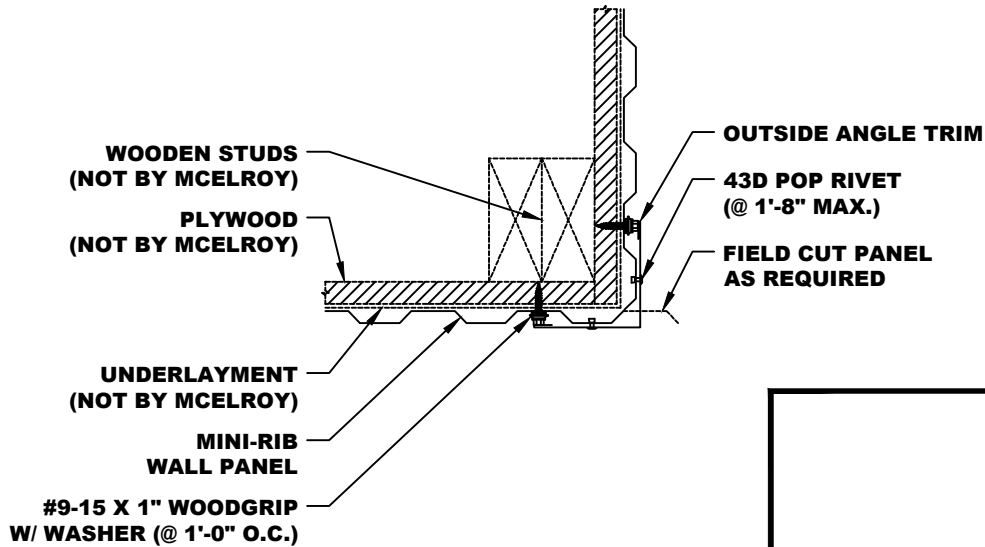

- NOTES:**
1. Measure and Field Cut Mini-Rib Panel as required. Attach panels to Plywood with #9-15 x 1" Woodgrip w/ Washer Fastener at 1'-0" O.C.
 2. Outside Corner Trim to run from Base Trim to top of wall panel.
 3. Attach Outside Corner Trim to Mini-Rib Panel with 43D Pop Rivets at 1'-8" O.C. (Max.).

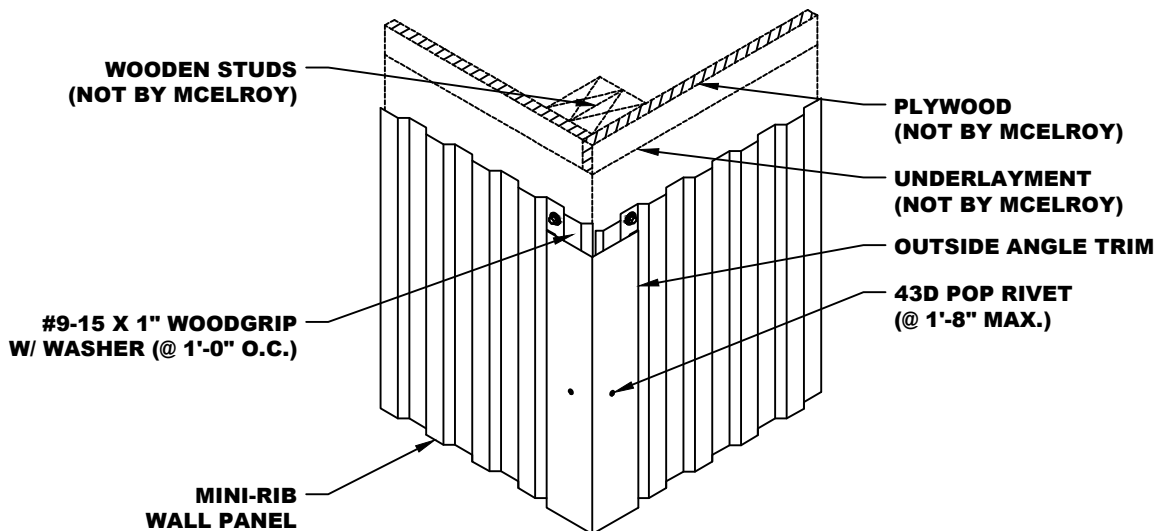

*NOTE: SOME TRIM ITEMS AND FASTENERS HAVE BEEN REMOVED FOR CLARITY OF ISOMETRIC DETAIL.

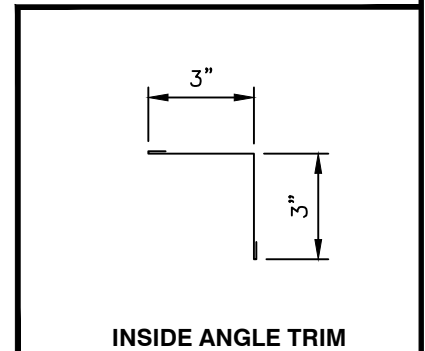
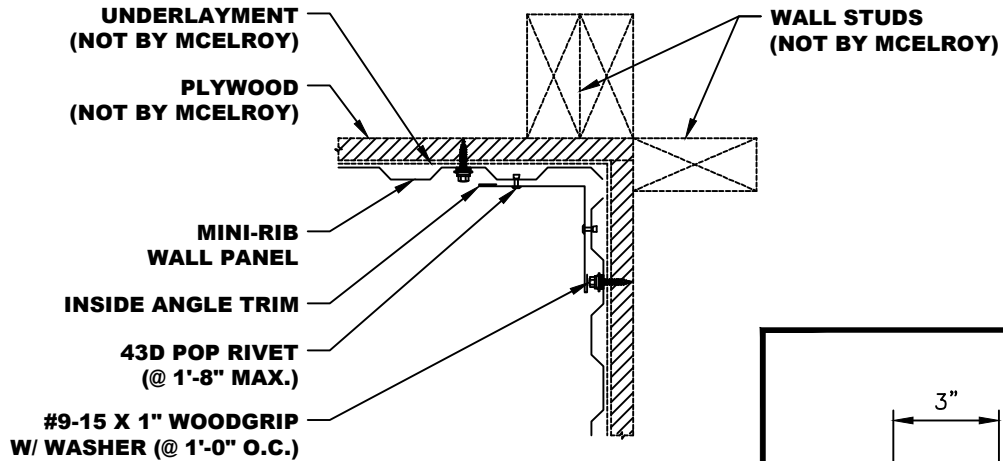

- NOTES:**
1. Attach Mini-Rib Panels to Plywood with #9-15 x 1" Woodgrip w/ Washer Fastener at 1'-0" O.C.
 2. Inside Corner Trim to run from Base Trim to top of wall panel.
 3. Attach Inside Corner Trim to Mini-Rib Panel with 43D Pop Rivets at 1'-8" O.C. (Max.).

*NOTE: SOME TRIM ITEMS AND FASTENERS HAVE BEEN REMOVED FOR CLARITY OF ISOMETRIC DETAIL.

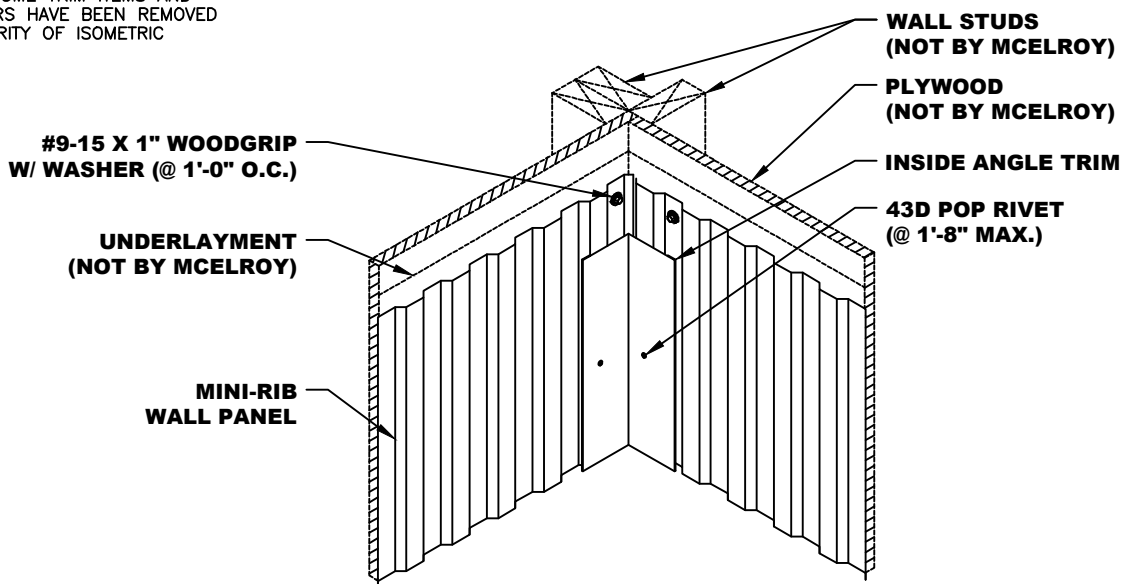

VERTICAL INSIDE CORNER (OFF MODULE) DETAIL

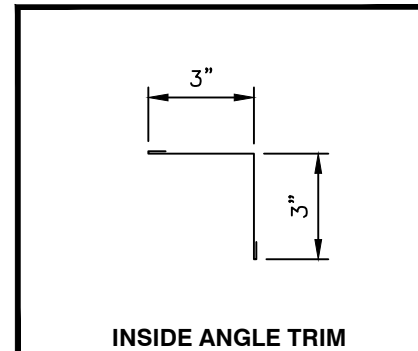
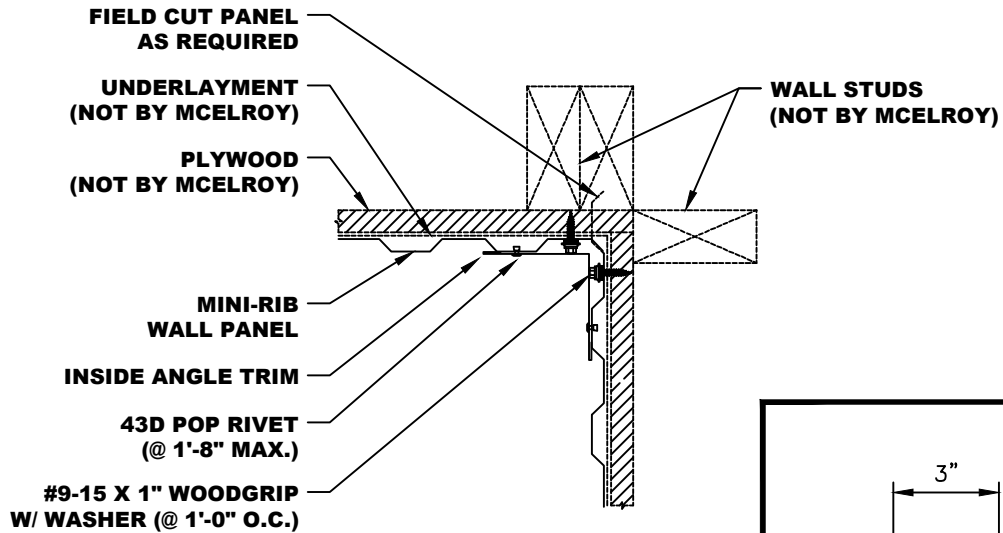

- NOTES:**
1. Measure and Field Cut Mini-Rib Panel as require. Attach panels to Plywood with #9-15 x 1" Woodgrip w/ Washer Fastener at 1'-0" O.C.
 2. Inside Corner Trim to run from Base Trim to top of wall panel.
 3. Attach Inside Corner Trim to Mini-Rib Panel with 43D Pop Rivets at 1'-8" O.C. (Max.).

*NOTE: SOME TRIM ITEMS AND FASTENERS HAVE BEEN REMOVED FOR CLARITY OF ISOMETRIC DETAIL.

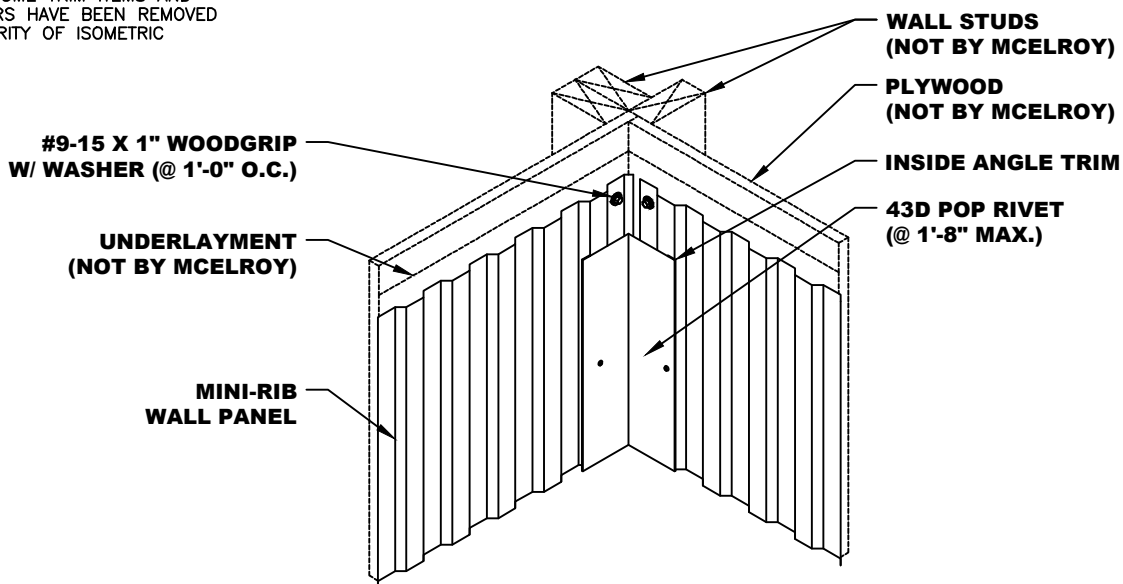

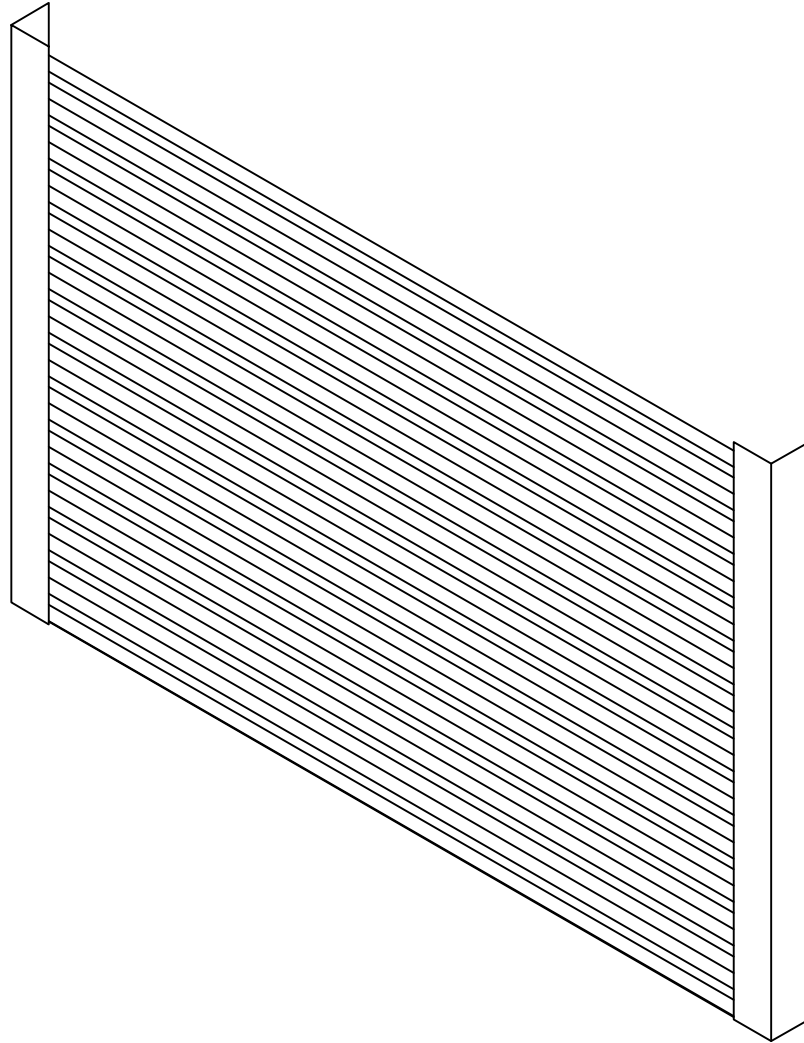

STANDARD HORIZONTAL INSTALLATION DETAILS

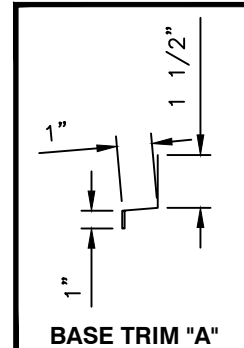
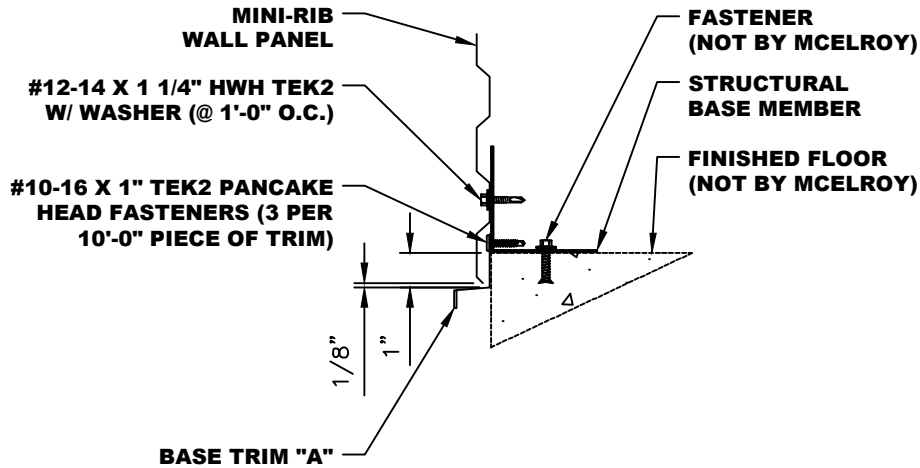

- NOTES:**
1. Base Structural Member set flush with edge of finished floor.
 2. Set Base Trim "A" 1" down face of finished floor and attach to Structural Base Member with #10-16 x 1" Tek2 Pancake Head Fasteners. Use three (3) fasteners per 10'-0" piece of trim.
 3. Set Mini-Rib Wall Panel into place. Make sure to leave a 1/8" gap between base trim and panel.
 4. Attach Mini-Rib Panel with #12-14 x 1 1/4" HWH Tek2 Fasteners at 1'-0" O.C.

*NOTE: SOME TRIM ITEMS AND FASTENERS HAVE BEEN REMOVED FOR CLARITY OF ISOMETRIC DETAIL.

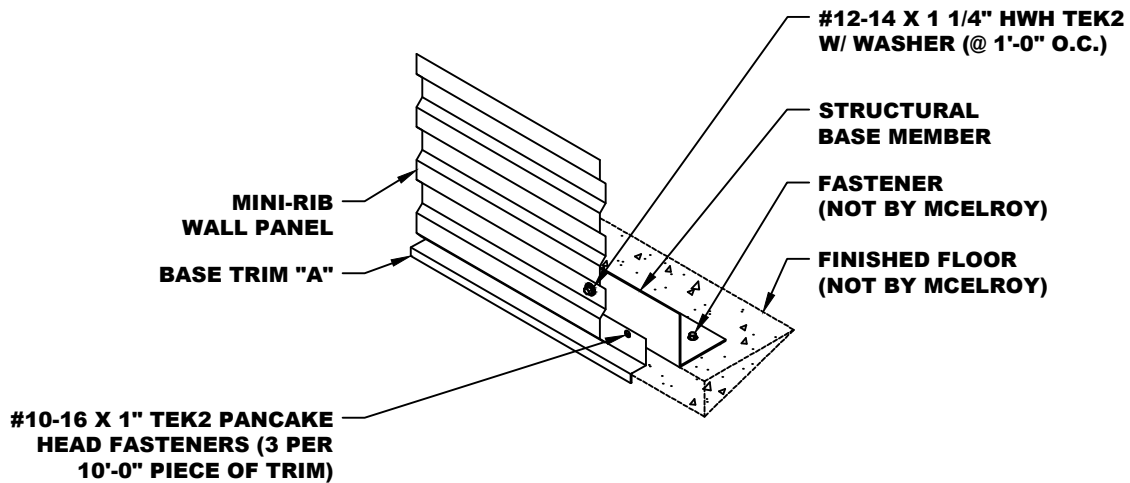

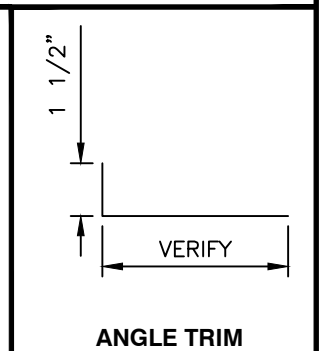
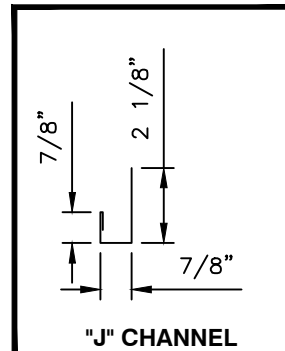
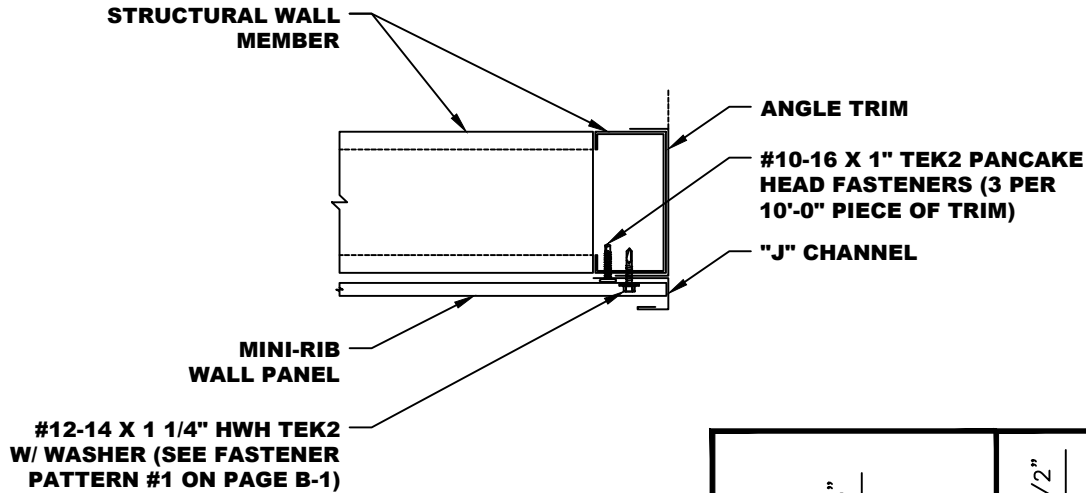

- NOTES:**
1. Attach Angle Trim to Structural Wall Member. If you ordered trim wider than Structural Member, fold back as shown in detail. You can hold in place with temporary fasteners if needed.
 2. Set "J" Channel in place as shown and attach to Structural Wall Member with #10-16 x 1" Tek2 Pancake Head Fasteners. Use three (3) fasteners per 10'-0" piece of trim.
 3. Set Mini-Rib Wall Panel in place and fasten to Structural Wall Members with #12-14 x 1 1/4" HWH Tek2 w/ Washer Fasteners per Fastener Pattern #1 on page B-1 of this manual.

*NOTE: SOME TRIM ITEMS AND FASTENERS HAVE BEEN REMOVED FOR CLARITY OF ISOMETRIC DETAIL.

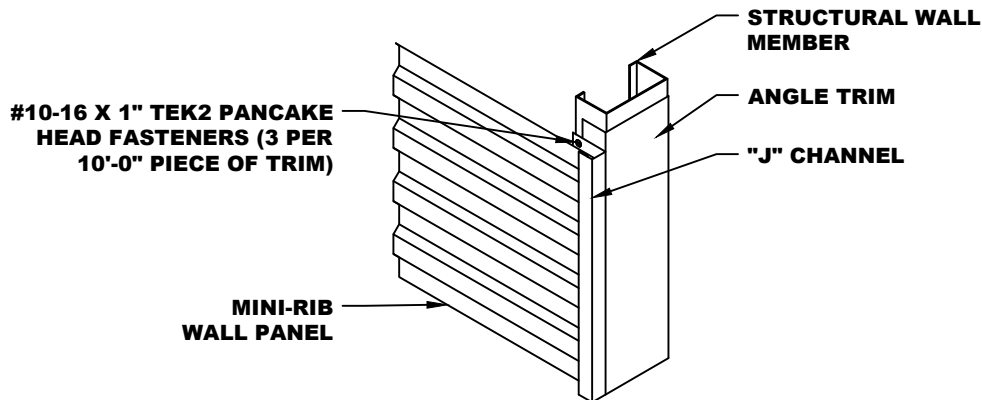

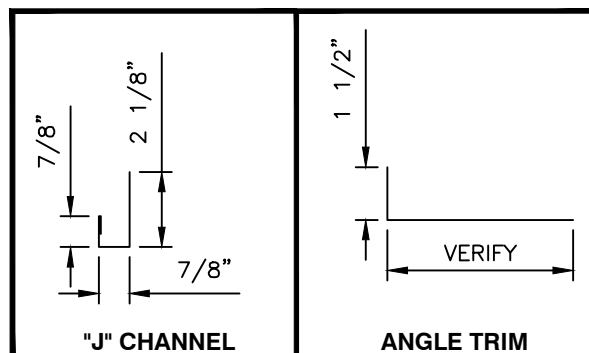
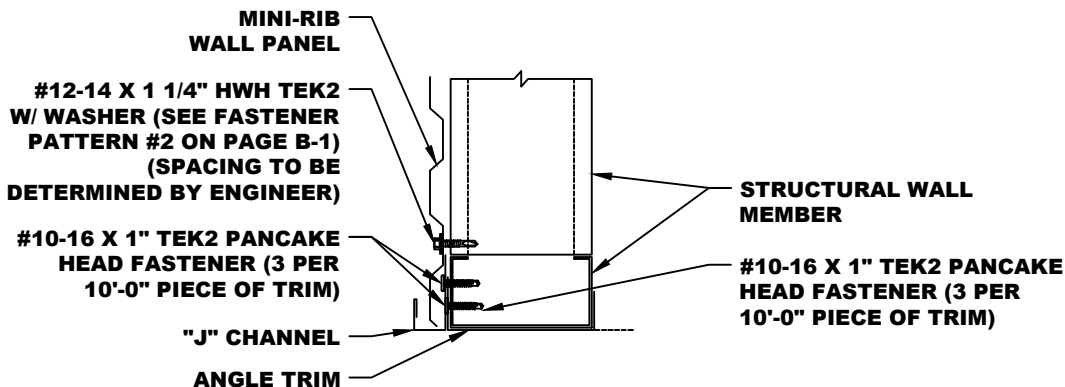

- NOTES:**
1. Attach Angle Trim to Structural Wall Member. If you ordered trim wider than Structural Member, fold back as shown in detail. Attach with #10-16 x 1" Tek2 Pancake Head Fasteners three (3) per 10'-0" piece of trim.
 2. Set "J" Channel in place as shown and attach to Structural Wall Member with #10-16 x 1" Tek2 Pancake Head Fasteners three (3) fasteners per 10'-0" piece of trim.
 3. Attach Mini-Rib Panel with #12-14 x 1 1/4" HWH Tek2 Fasteners per Fastener Pattern #2 on page B-1 of this manual. Spacing of fasteners to be determined by an Engineer.

*NOTE: SOME TRIM ITEMS AND FASTENERS HAVE BEEN REMOVED FOR CLARITY OF ISOMETRIC DETAIL.

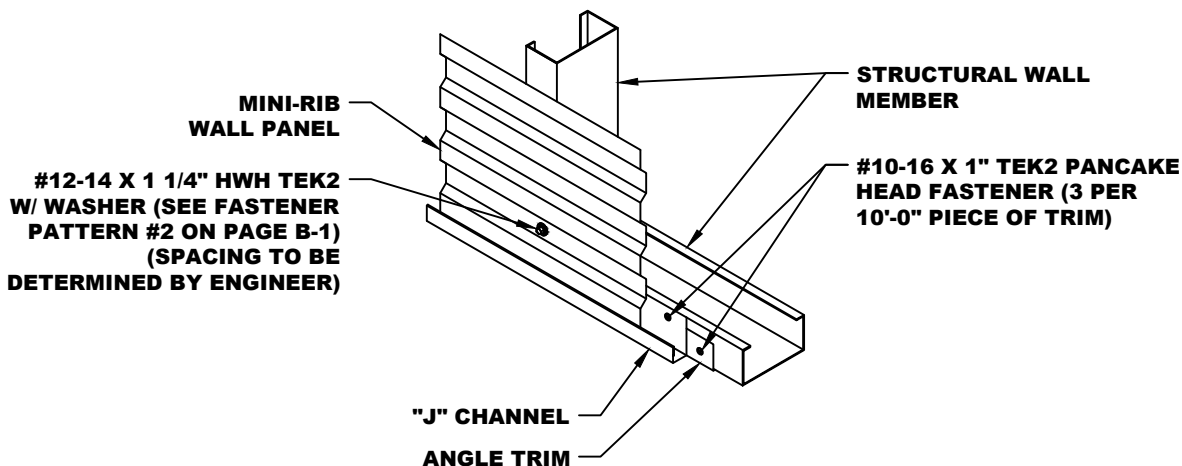

MINI-RIB HORIZONTAL HEAD (OFF MODULE) DETAIL

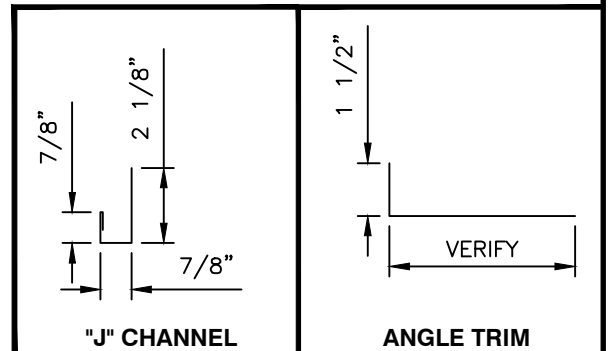
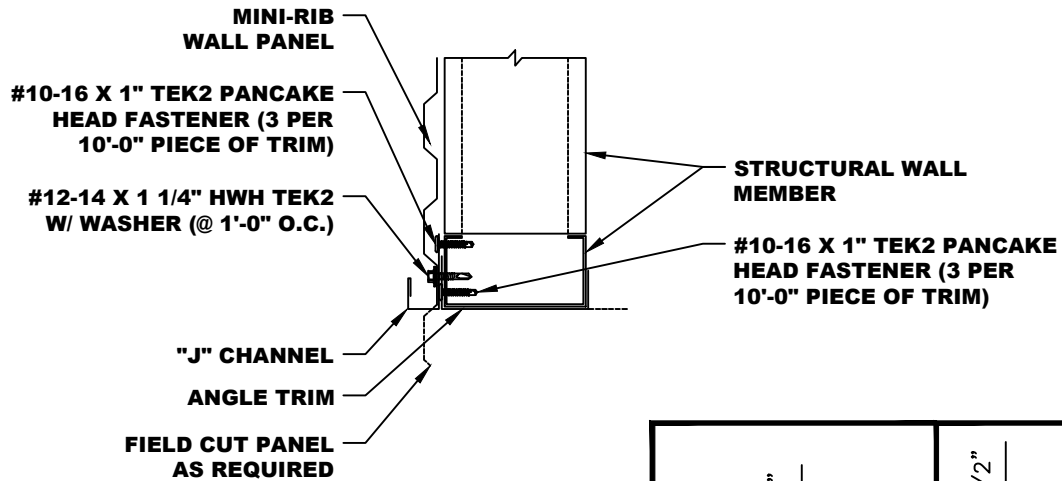

- NOTES:**
1. Attach Angle Trim to Structural Wall Member. If you ordered trim wider than Structural Member, fold back as shown in detail. Attach with #10-16 x 1" Tek2 Pancake Head Fasteners three (3) per 10'-0" piece of trim.
 2. Set "J" Channel in place as shown and attach to Structural Wall Member with #10-16 x 1" Tek2 Pancake Head Fasteners three (3) fasteners per 10'-0" piece of trim.
 3. Field Cut Mini-Rib Panel as required and attach panel with #12-14 x 1 1/4" HWH Tek2 Fasteners at 1'-0" O.C.

*NOTE: SOME TRIM ITEMS AND FASTENERS HAVE BEEN REMOVED FOR CLARITY OF ISOMETRIC DETAIL.

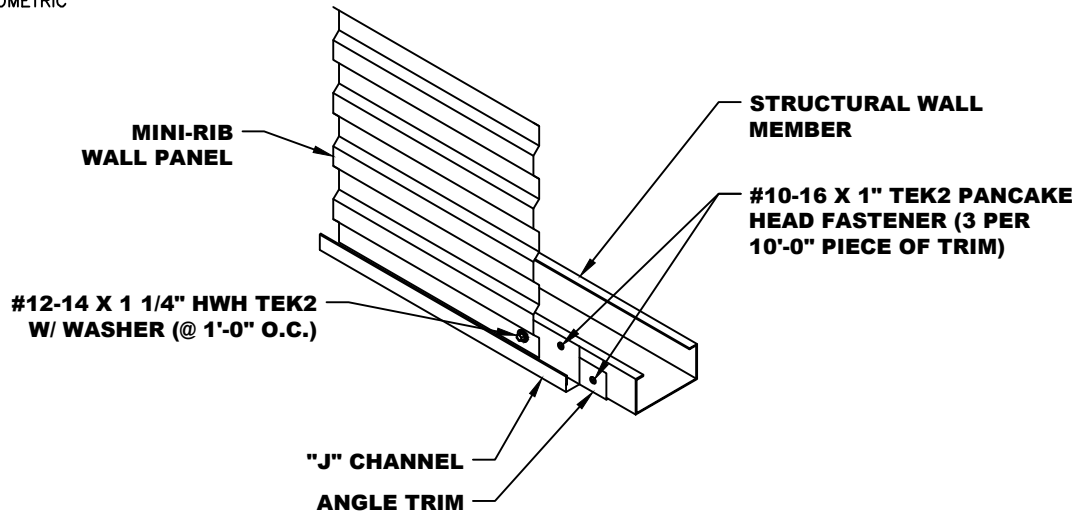

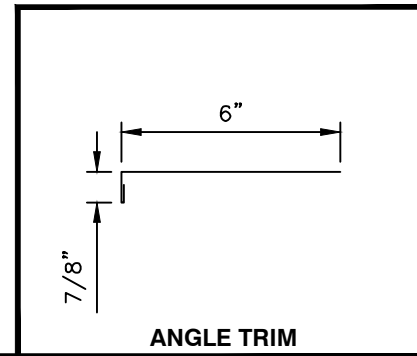
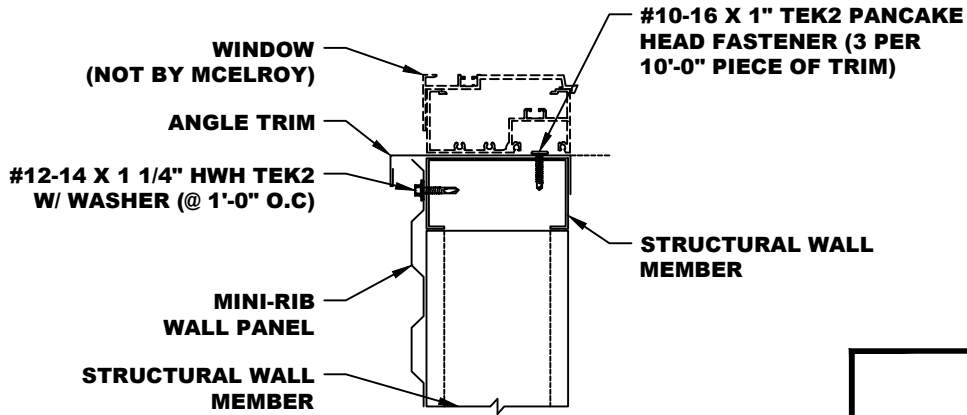

- NOTES:**
1. Measure and cut Mini-Rib Panel to fit around window as required.
 2. Set Mini-Rib Panel in place and attach to Structural Wall Member with #12-14 x 1 1/4" HWH Tek2 w/ Washer Fasteners at 1'-0" O.C.
 3. Cut Angle Trim to fit as required and attach to Structural Wall Member with #10-16 x 1" Tek2 Pancake Fasteners at three (3) per 10'-0" piece of trim.

*NOTE: SOME TRIM ITEMS AND FASTENERS HAVE BEEN REMOVED FOR CLARITY OF ISOMETRIC DETAIL.

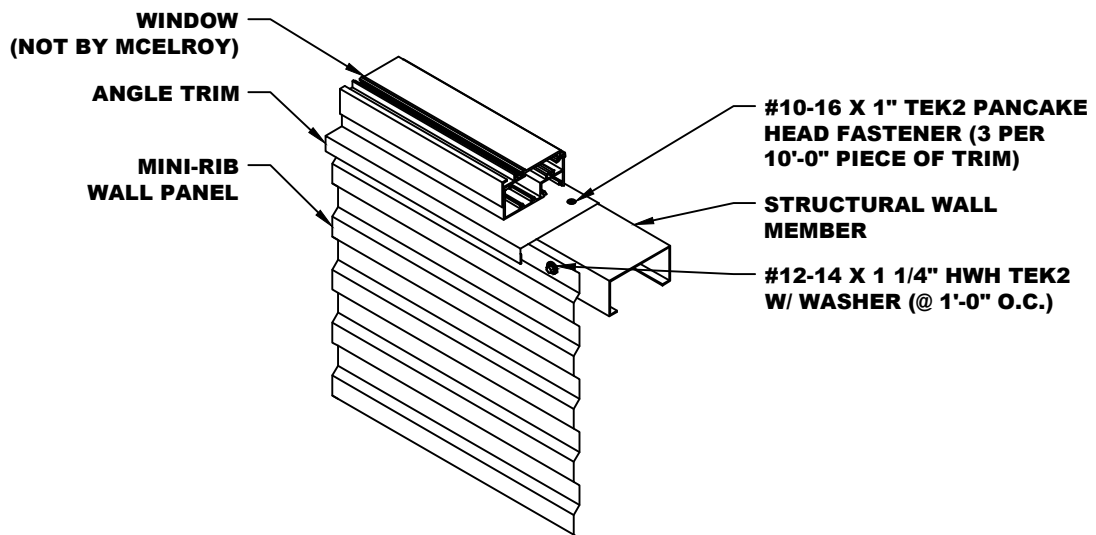

MINI-RIB HORIZONTAL SILL (OFF MODULE) DETAIL

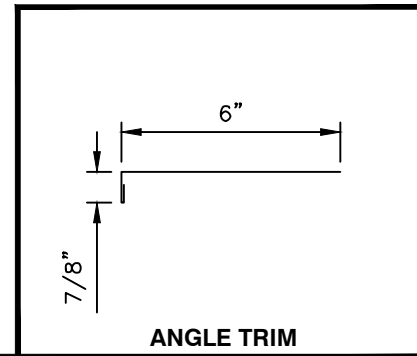
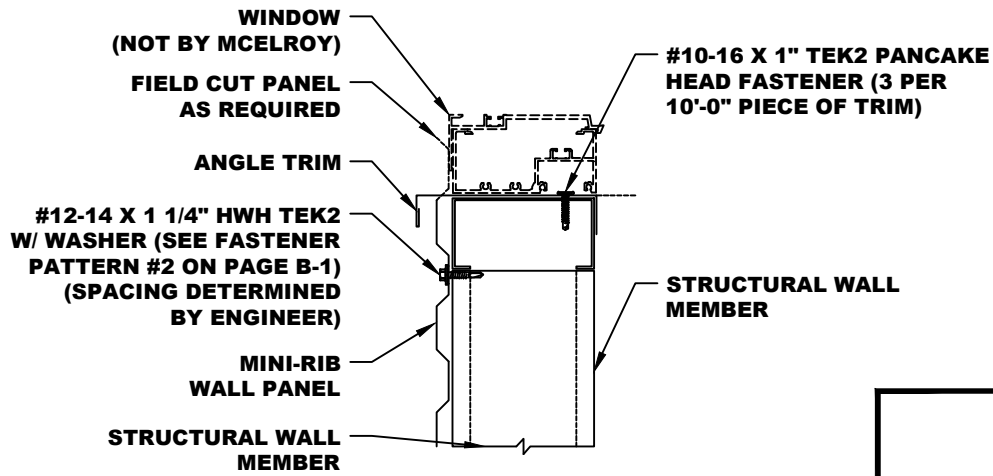

- NOTES:**
1. Measure and cut Mini-Rib Panel to fit around window as required.
 2. Set Mini-Rib Panel in place and attach to Structural Wall Member with #12-14 x 1 1/4" HWH Tek2 w/ Washer Fasteners at 1'-0" O.C. or equally spaced across framed opening.
 3. Cut Angle Trim to fit as required and attach to Structural Wall Member with #10-16 x 1" Tek2 Pancake Fasteners at three (3) per 10'-0" piece of trim.

*NOTE: SOME TRIM ITEMS AND FASTENERS HAVE BEEN REMOVED FOR CLARITY OF ISOMETRIC DETAIL.

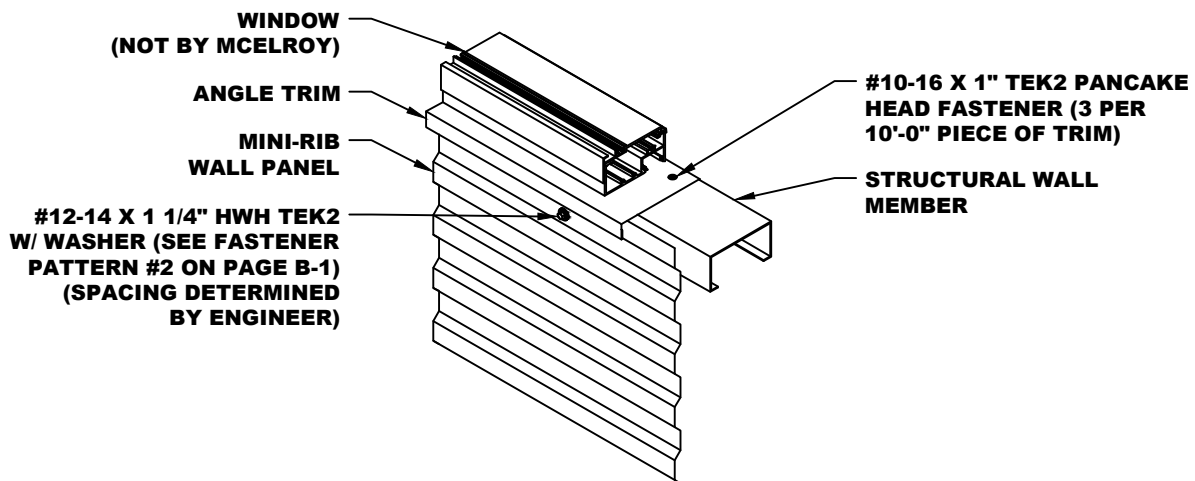

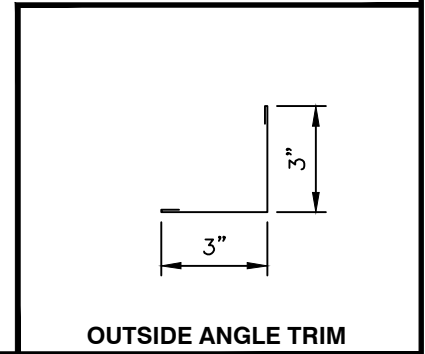
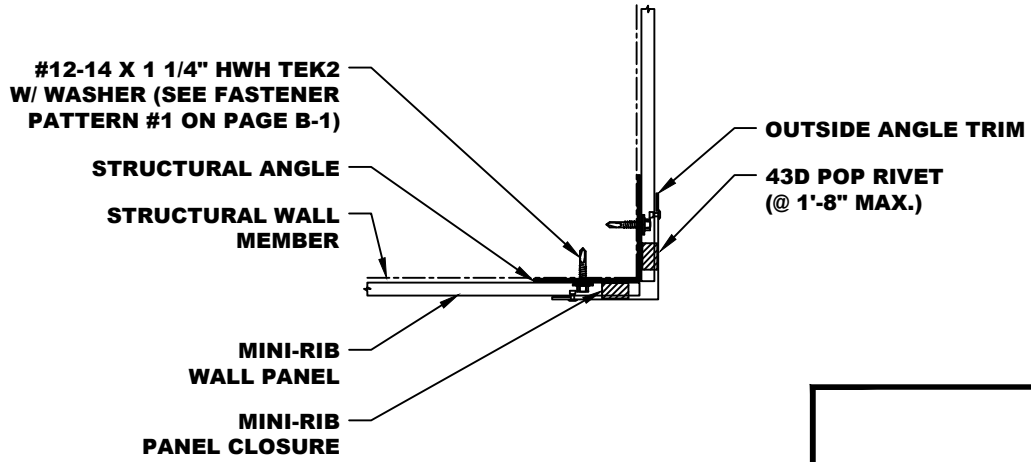

- NOTES:**
1. Attach Mini-Rib Panels to framework with #12-14 x 1 1/4" HWH Tek2 w/ Washer Fastener per fastener pattern on page B-1.
 2. Install Mini-Rib Panel Closures.
 2. Outside Corner Trim to run from Base Trim to top of wall panel.
 3. Attach Outside Corner Trim to Mini-Rib Panel with 43D Pop Rivets at 1'-8" O.C. (Max.).

*NOTE: SOME TRIM ITEMS AND FASTENERS HAVE BEEN REMOVED FOR CLARITY OF ISOMETRIC DETAIL.

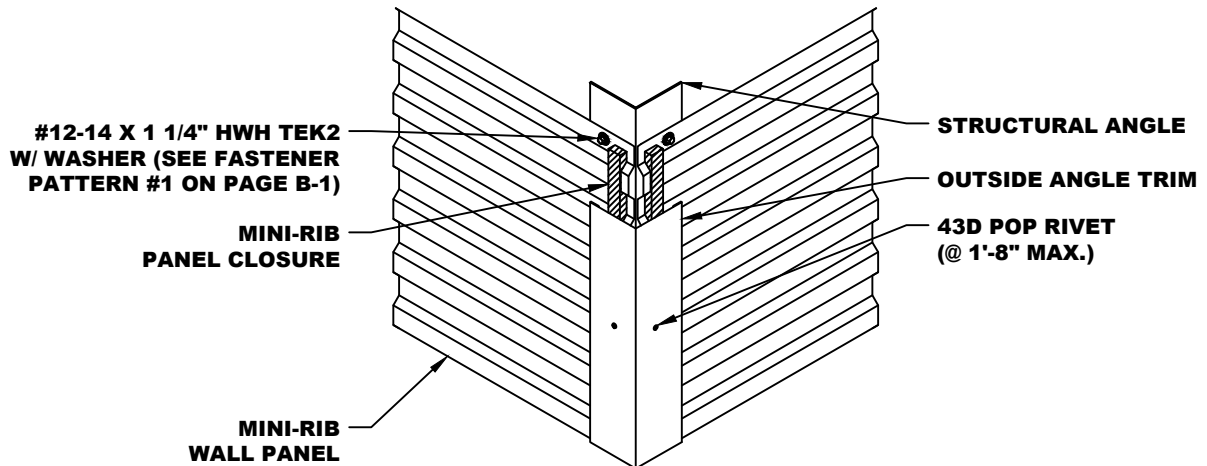

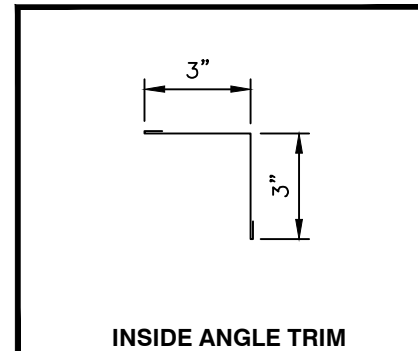
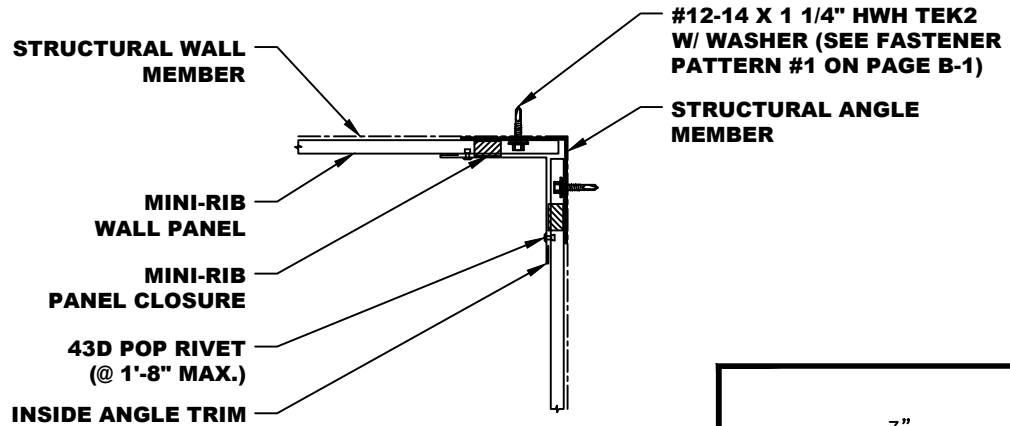

- NOTES:**
1. Attach Mini-Rib Panels to framework with #12-14 x 1 1/4" HWH Tek2 w/ Washer Fastener per fastener pattern on page B-1.
 2. Install Mini-Rib Panel Closures.
 3. Inside Corner Trim to run from Base Trim to top of wall panel.
 4. Attach Inside Corner Trim to Mini-Rib Panel with 43D Pop Rivets at 1'-8" O.C. (Max.).

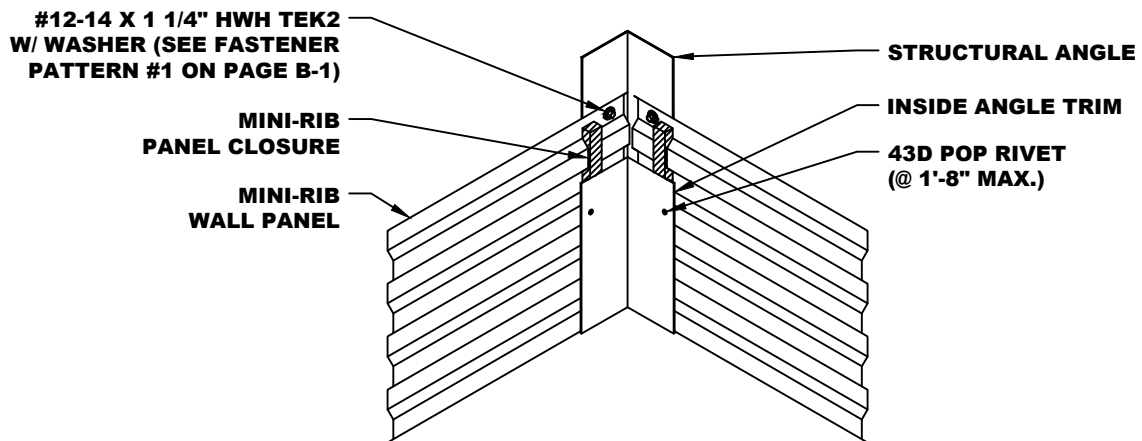

*NOTE: SOME TRIM ITEMS AND FASTENERS HAVE BEEN REMOVED FOR CLARITY OF ISOMETRIC DETAIL.

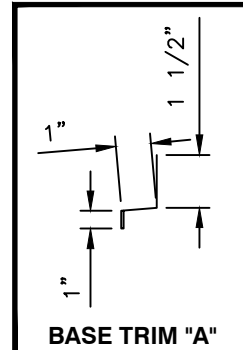
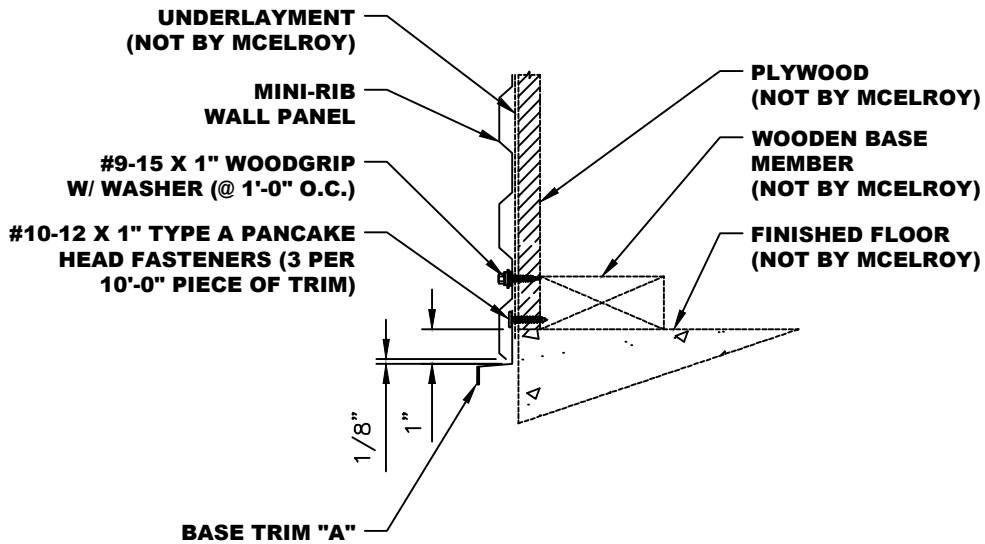

- NOTES:**
1. Plywood set flush with edge of finished floor.
 2. Set Base Trim "A" 1" down face of finished floor and attach to Plywood with #10-12 x 1" Type A Pancake Head Fasteners. Use three (3) fasteners per 10'-0" piece of trim.
 3. Set Mini-Rib Wall Panel into place. Make sure to leave a 1/8" gap between base trim and panel.
 4. Attach Mini-Rib Panel with #12-14 x 1 1/4" HWH Tek2 Fasteners at 1'-0" O.C.

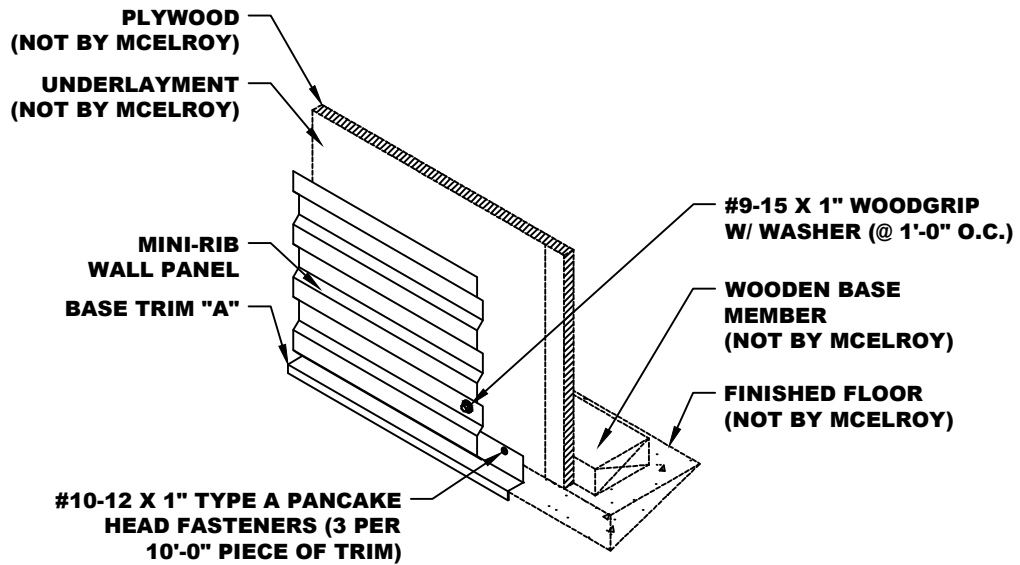

*NOTE: SOME TRIM ITEMS AND FASTENERS HAVE BEEN REMOVED FOR CLARITY OF ISOMETRIC DETAIL.

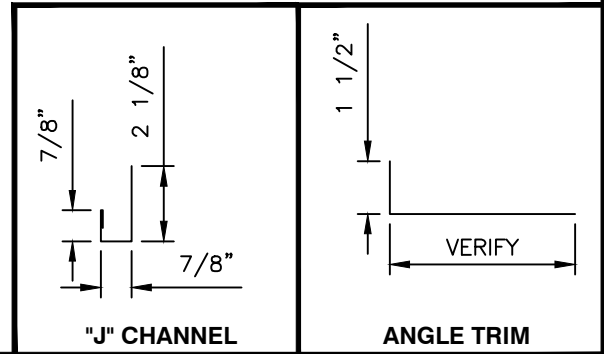
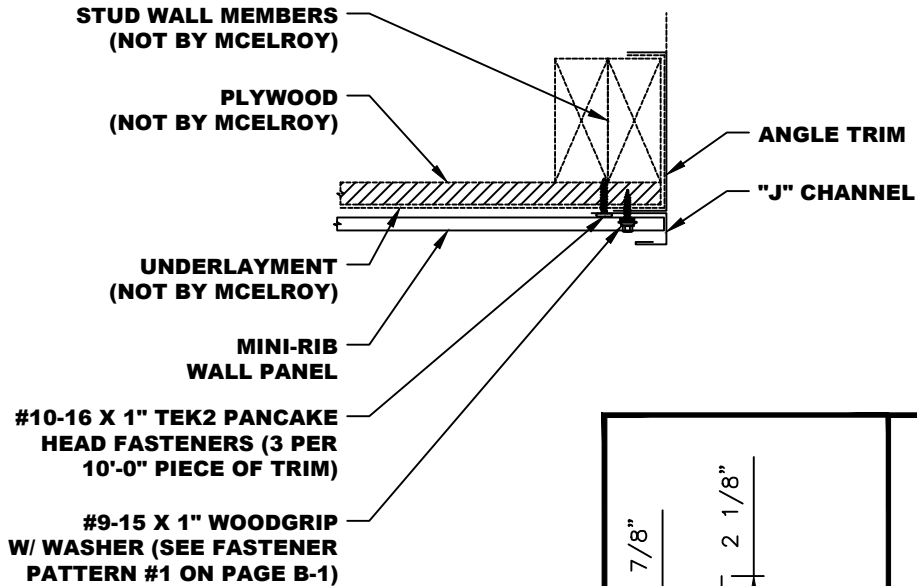

- NOTES:**
1. Attach Angle Trim to Structural Wall Member. If you ordered trim wider than Structural Member, fold back as shown in detail. You can hold in place with temporary fasteners if needed.
 2. Set "J" Channel in place as shown and attach to Structural Wall Member with #10-12 x 1" Type A Pancake Head Fasteners. Use three (3) fasteners per 10'-0" piece of trim.
 3. Set Mini-Rib Wall Panel in place and fasten to Plywood with #9-15 x 1" Type A Woodgrip w/ Washer Fasteners per fastener pattern on page B-1 on this manual.

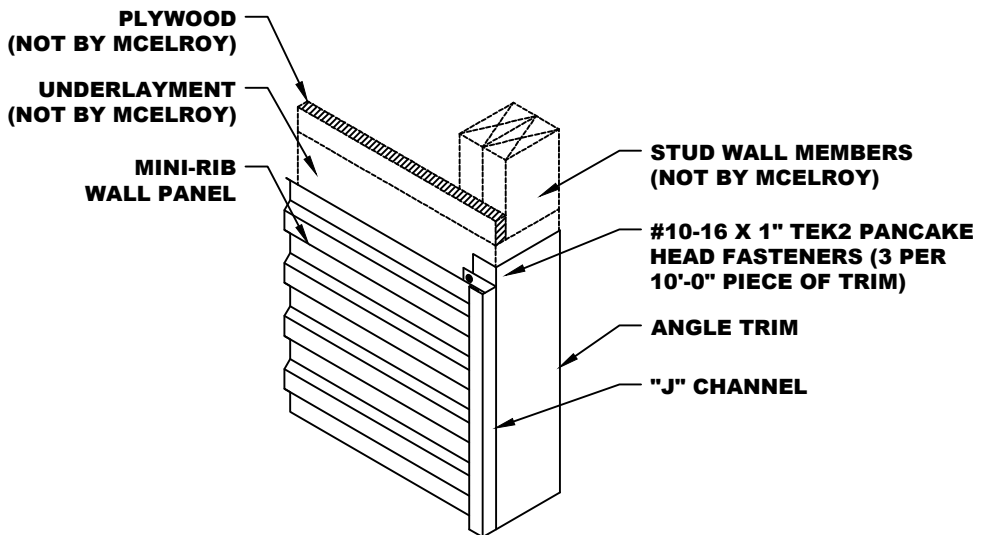

*NOTE: SOME TRIM ITEMS AND FASTENERS HAVE BEEN REMOVED FOR CLARITY OF ISOMETRIC DETAIL.

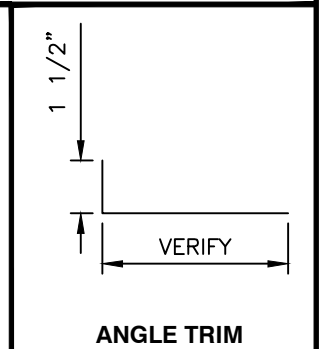
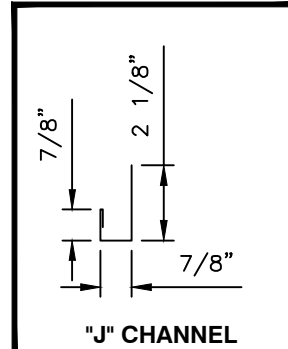
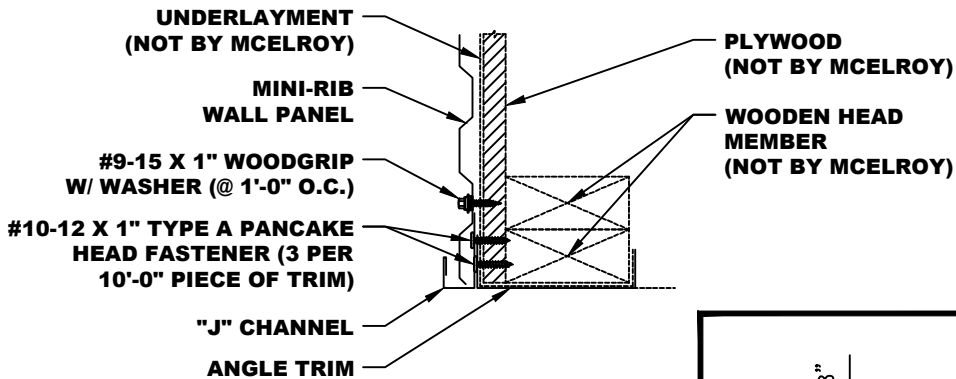

- NOTES:**
1. Attach Angle Trim to Plywood. If you ordered trim wider than Wooden Stud Member, fold back as shown in detail. Attach with #10-12 x 1" Type A Pancake Head Fasteners three (3) per 10'-0" per piece of trim.
 2. Set "J" Channel in place as shown and attach to Structural Wall Member with #10-12 x 1" Type A Pancake Head Fasteners three (3) fasteners per 10'-0" piece of trim.
 3. Set Mini-Rib Wall Panel in place and fasten to Plywood with #9-15 x 1" Woodgrip w/ Washer Fasteners at 1'-0" O.C.

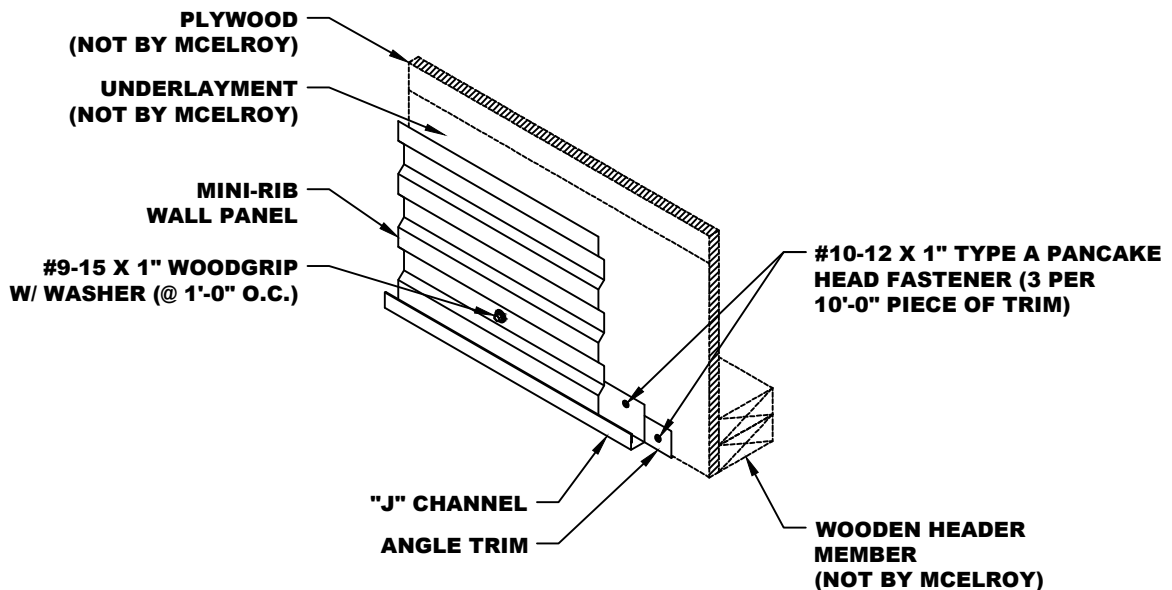

*NOTE: SOME TRIM ITEMS AND FASTENERS HAVE BEEN REMOVED FOR CLARITY OF ISOMETRIC DETAIL.

MINI-RIB HORIZONTAL HEAD (OFF MODULE) DETAIL

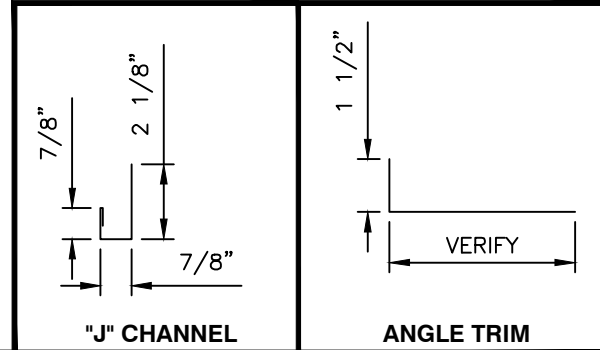
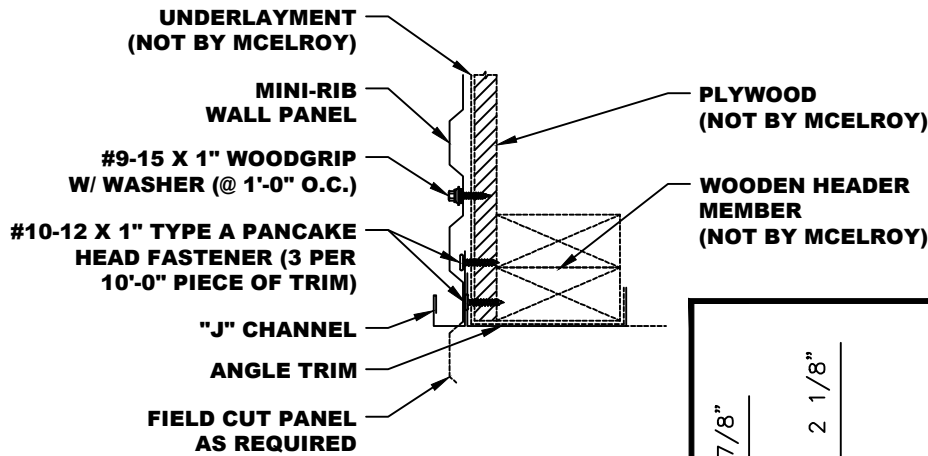

- NOTES:**
1. Attach Angle Trim to Plywood. If you ordered trim wider than Structural Member, fold back as shown in detail. Attach with #10-12 x 1" Type A Pancake Head Fasteners three (3) per 10'-0" piece of trim.
 2. Set "J" Channel in place as shown and attach to Plywood with #10-12 x 1" Type A Pancake Head Fasteners three (3) fasteners per 10'-0" piece of trim.
 3. Set Mini-Rib Panel in place and attach with #12-14 x 1 1/4" HWH Tek2 Fasteners at 1'-0" O.C.

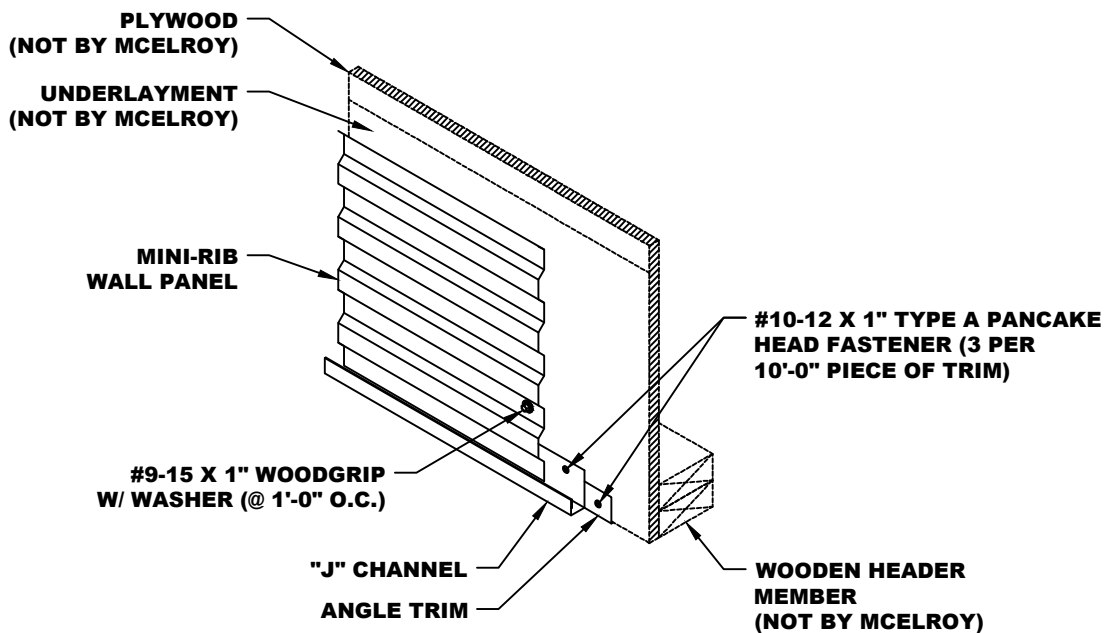

*NOTE: SOME TRIM ITEMS AND FASTENERS HAVE BEEN REMOVED FOR CLARITY OF ISOMETRIC DETAIL.

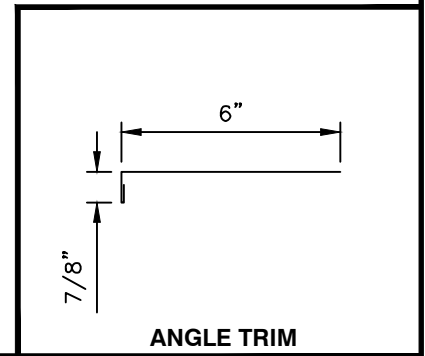
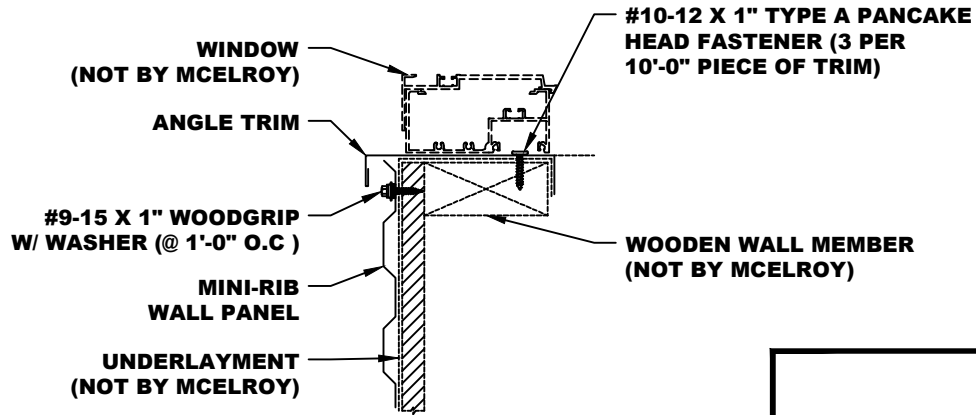

- NOTES:**
1. Measure and cut Mini-Rib Panel to fit around window as required.
 2. Set Mini-Rib Panel in place and attach to Plywood with #9-15 x 1" Woodgrip w/ Washer Fasteners at 1'-0" O.C.
 3. Cut Angle Trim to fit as required and attach to Structural Wall Member with #10-12 x 1" Type A Pancake Head Fasteners at three (3) per 10'-0" piece of trim.

*NOTE: SOME TRIM ITEMS AND FASTENERS HAVE BEEN REMOVED FOR CLARITY OF ISOMETRIC DETAIL.

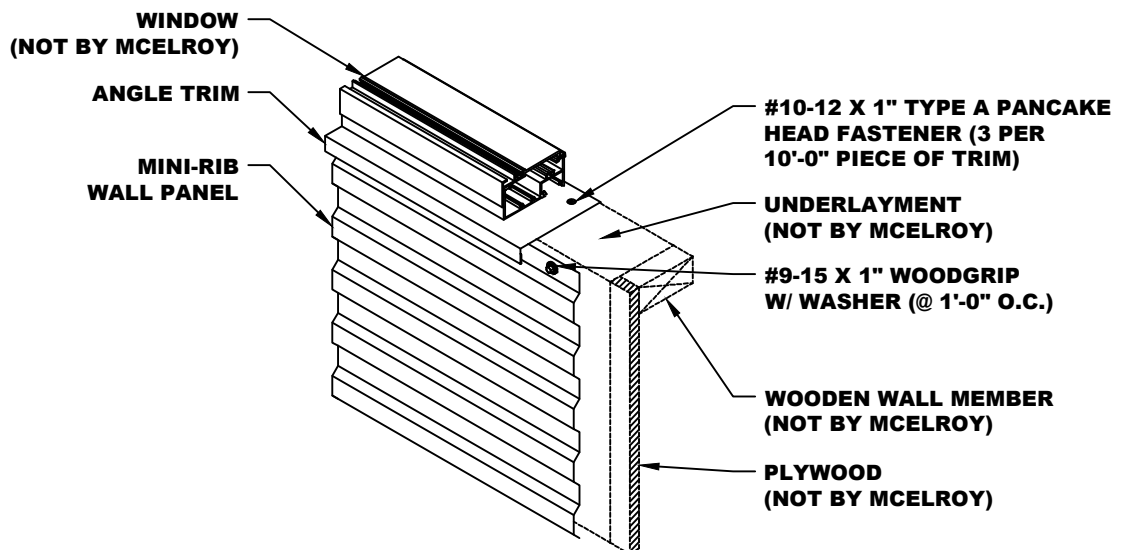

MINI-RIB HORIZONTAL SILL (OFF MODULE) DETAIL

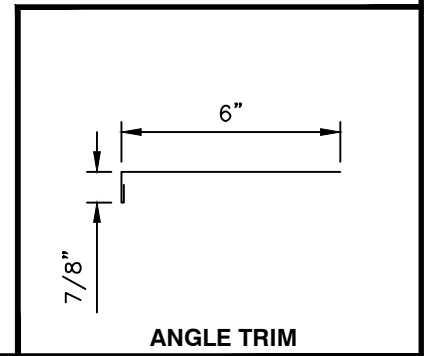
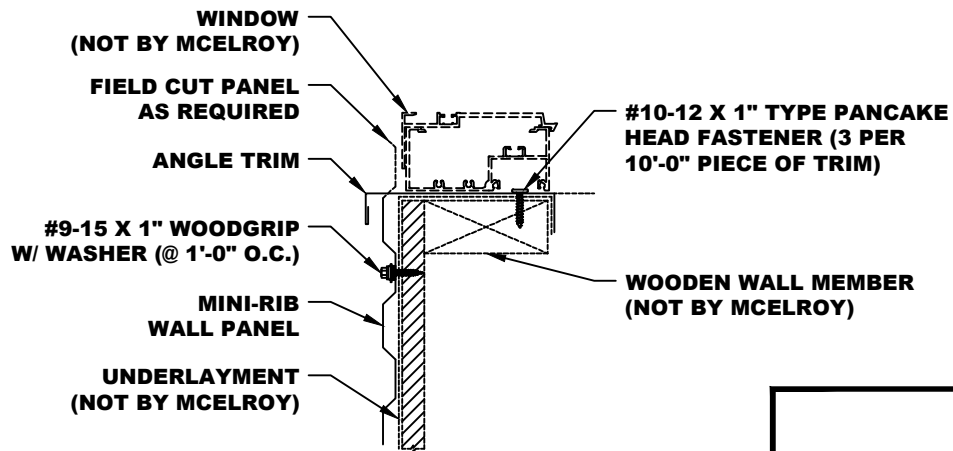

- NOTES:**
1. Measure and cut Mini-Rib Panel to fit around window as required.
 2. Set Mini-Rib Panel in place and attach to Plywood with #9-15 x 1" Woodgrip w/ Washer Fasteners at 1'-0" O.C.
 3. Cut Angle Trim to fit as required and attach to Structural Wall Member with #10-12 x 1" Type A Pancake Head Fasteners at three (3) per 10'-0" piece of trim.

*NOTE: SOME TRIM ITEMS AND FASTENERS HAVE BEEN REMOVED FOR CLARITY OF ISOMETRIC DETAIL.

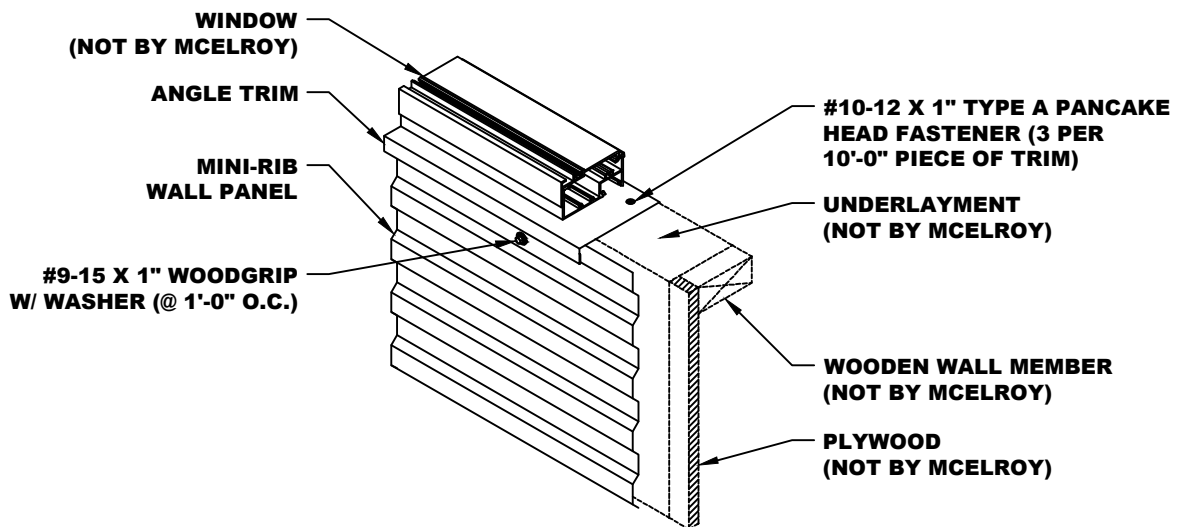

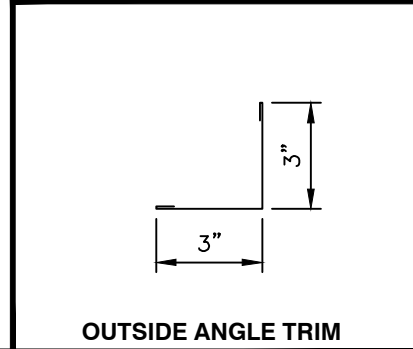
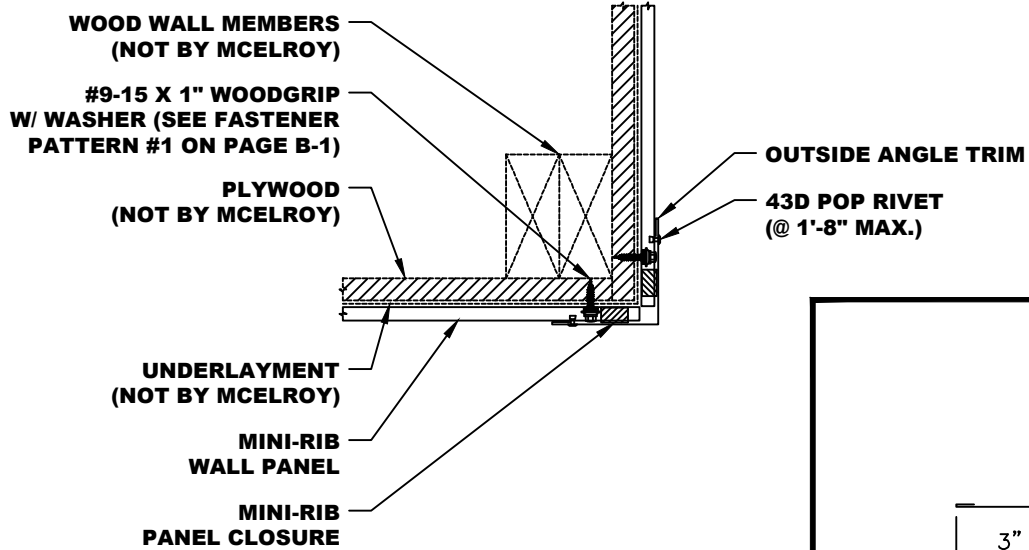

- NOTES:**
1. Attach Mini-Rib Panels to Plywood with #9-15 x 1" Woodgrip w/ Washer Fastener per fastener pattern on page B-1 of this manual.
 2. Install Mini-Rib Panel Closures as required.
 3. Outside Corner Trim to run from Base Trim to top of wall panel.
 4. Attach Outside Corner Trim to Mini-Rib Panel with 43D Pop Rivets at 1'-8" O.C. (Max.).

*NOTE: SOME TRIM ITEMS AND FASTENERS HAVE BEEN REMOVED FOR CLARITY OF ISOMETRIC DETAIL.

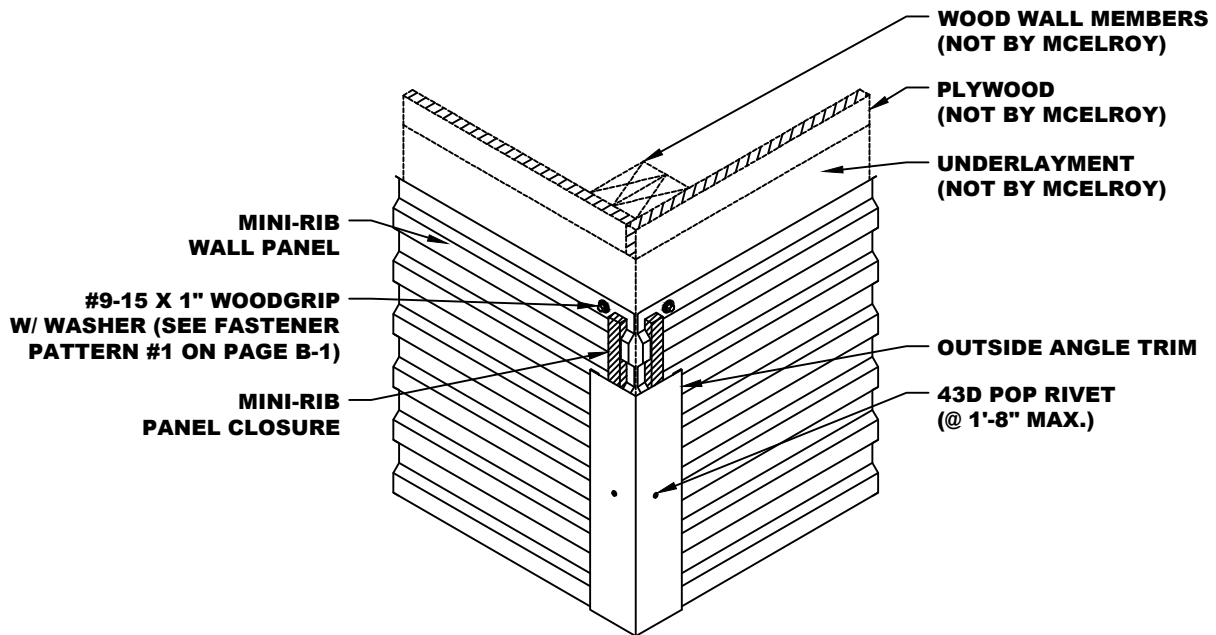

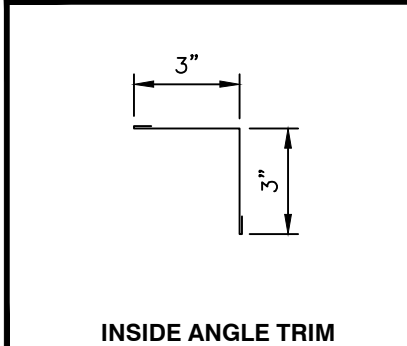
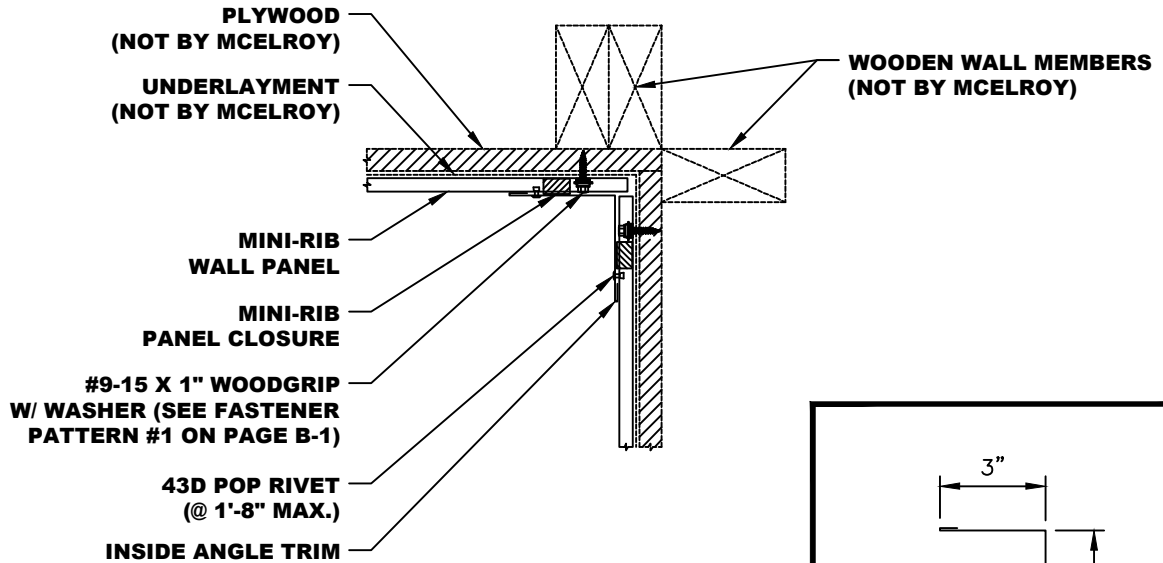

- NOTES:**
1. Attach Mini-Rib Panels to Plywood with #9-15 x 1" Woodgrip w/ Washer Fastener per fastener pattern on page B-1 of this manual.
 2. Install Mini-Rib Panel Closures as required.
 3. Inside Corner Trim to run from Base Trim to top of wall panel.
 4. Attach Inside Corner Trim to Mini-Rib Panel with 43D Pop Rivets at 1'-8" O.C. (Max.).

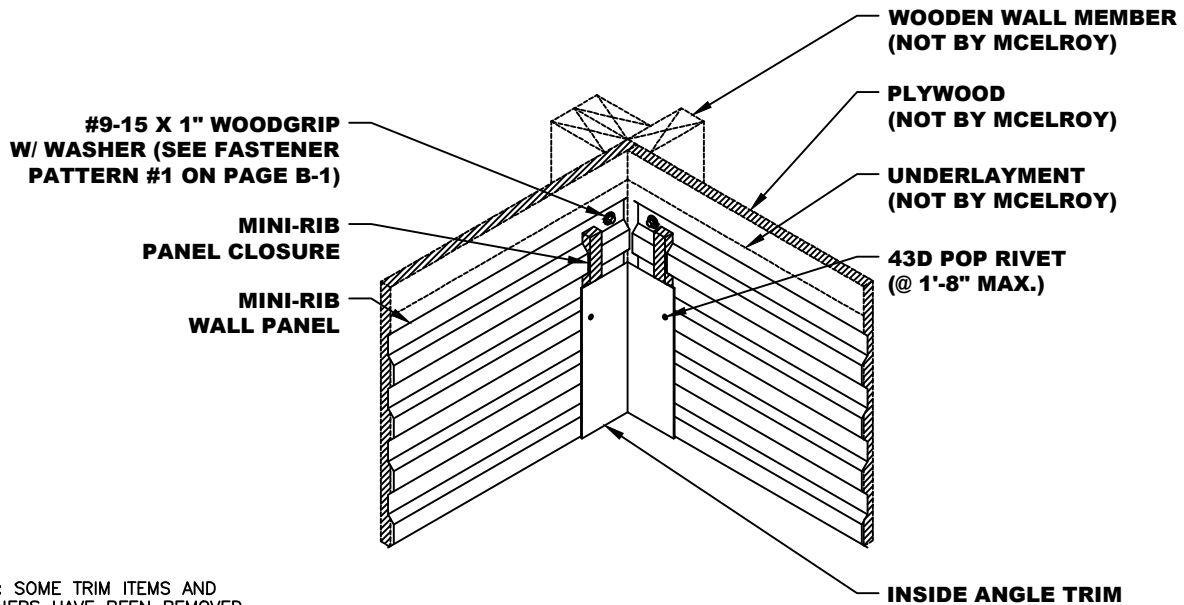

*NOTE: SOME TRIM ITEMS AND FASTENERS HAVE BEEN REMOVED FOR CLARITY OF ISOMETRIC DETAIL.

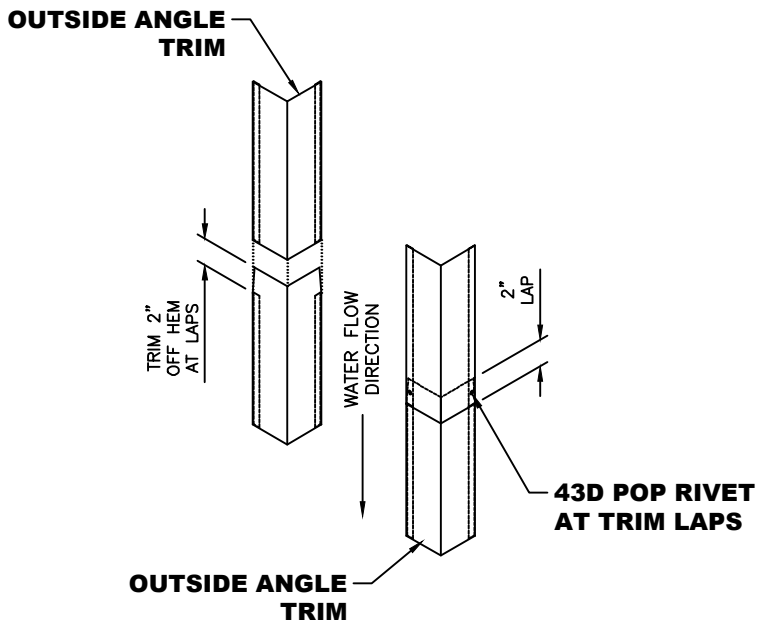
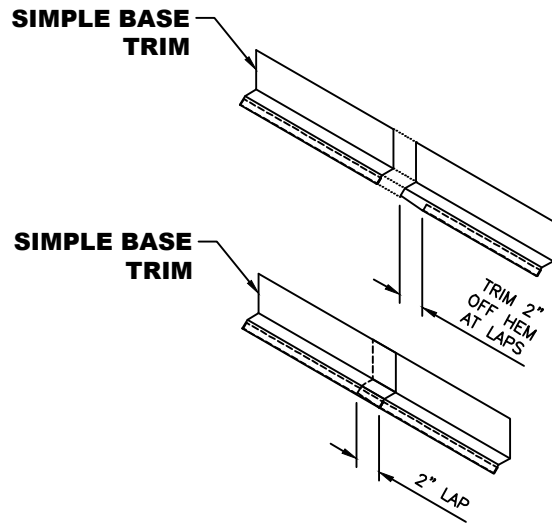
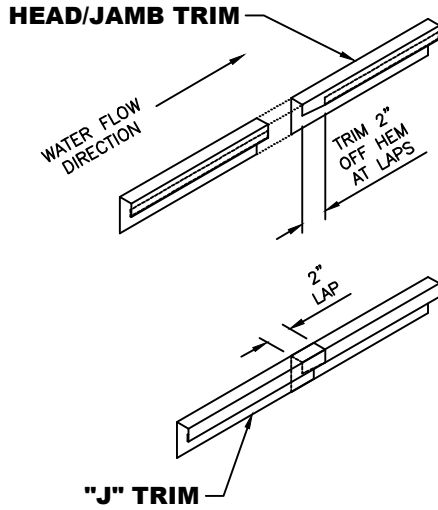

NOTE: 1. Apply specified Roll Tape Sealant or a 3/16" Ø bead of Tube Butyl 1 1/2" back from the edge of the trim. Also, apply a piece of tape sealant or bead of Tube Butyl as a Pigtail to completely seal joint.
 2. Notch the hems on the upper trim piece 2" so that the trim will fit flat in the lap joint.
 3. Secure trim laps with Pop Rivets as shown above.



☆ MANUFACTURING LOCATIONS ● SERVICE CENTERS ★ MANUFACTURING AND SERVICE CENTER



CORPORATE OFFICE
1500 HAMILTON RD.
BOSSIER CITY, LA 71111

MANUFACTURING LOCATIONS

ADELANTO, CA	ASHBURN, GA	BOSSIER CITY, LA	CLINTON, IL	DIAMOND, MO
HOUSTON, TX	LEWISPORT, KY	LOCKHART, TX	MARSHALL, MI	MAUSTON, WI
MERKEL, TX	PEACHTREE CITY, GA	SUNNYVALE, TX	WINCHESTER, VA	



17031 Koala Road Adelanto, CA 92301	5215 Leo St. Alexandria, LA 71301	1007 Wilso Dr, Baltimore, MD 21223	1500 Hamilton Rd. Bossier City, LA 71111
3052 Yadkin Road Chesapeake, VA 23323	9476 Meadowbrook Rd. Clinton, IL 61727	3215 Highway 59 Diamond, MO 64840	390 N. Valley Dell Dr. Fenton, MO 63026
409 Lovejoy Road Ft. Walton Beach, FL 32548	3014 Lincoln Court Garland, TX 75041	1440 Aldine Bender Road Houston, TX 77032	221 Benelli Drive Hutto, TX 78634
10504 E. 59th Street Indianapolis, IN 46236	32 Industrial Circle Lancaster, PA 17601	9435 US Hwy. 60 W. Lewisport, KY 42351	2701 Cahill Street Lockhart, TX 78644
1020 Veterans Street Mauston, WI 53948	5123 Terminal Dr. McFarland, WI 53558	514 Cave Road Nashville, TN 37210	8304 Hwy. 70 E. North Little Rock, AR 72117
613 North Bierdeman Rd. Pearl, MS 39208	8511 Industrial Drive Pearland, TX 77584	2755 Hwy 60 Pendergrass, GA 30567	7450 Tower Street Richland Hills, TX 76118
8200 Berry Ave. Suite 100 Sacramento, CA 95828	1365 Dean Forest Rd. Savannah, GA 31405	7355 Oakley Industrial Blvd. Union City, GA 30291	1144 Silstar Rd. West Columbia, SC 29170
325 McGhee Rd. Winchester, VA 22603			

Website: www.mcelroymetal.com • E-mail: info@mcelroymetal.com